



Alexander Hudson Estates

Sales Particulars



The Property

Alexander Hudson Estates welcomes to the market this two-bedroom, first floor apartment in the popular residential area of Wideopen with no onward chain. The property would benefit from further refurbishment

The property briefly comprises of: entrance hallway, spacious kitchen and a separate living room. Further into the apartment you will find a family bathroom and two good sized bedrooms. Externally the property benefits from private lawned garden and a detached garage.

The property is within easy reach of the A1, Newcastle City Centre and walking distance to local shops, restaurants and amenities. Big Waters Country Park is located just a ten minute walk away offering science walks within nature.

Leasehold
Council Tax: A
EPC Rating: 43

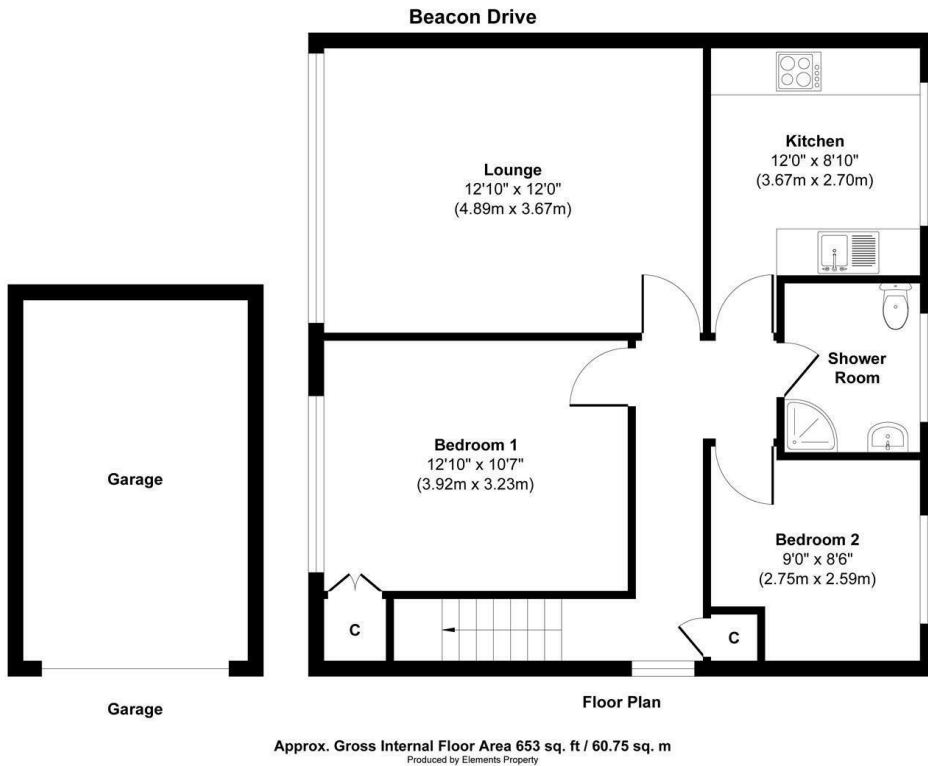



Alexander Hudson Estates
The Printworks
20 Arrow Close
NE12 6QN

0191 268 7433
sales@alexanderhudson.co.uk