



Alexander Hudson Estates

Sales Particulars

Alexander Hudson Estates

Harwood Drive, Simonside Park, NE12



The Property

Alexander Hudson Estates are delighted to introduce this immaculately presented, four-bedroom detached family home, ideally positioned on a substantial plot within a peaceful cul-de-sac in the increasingly sought-after suburb of Killingworth.

Warm and inviting throughout, the accommodation briefly comprises: a welcoming entrance hallway, a spacious living room with an elegant archway leading into the dining room, and a stylish, modern kitchen complete with a central island and an extended conservatory. Upstairs, there are four well-proportioned bedrooms, including a primary suite with an en-suite bathroom, along with a contemporary family bathroom.

Externally, the property boasts a lawned front garden, a private driveway, and an integral garage offering ample off-street parking. The rear garden has been beautifully landscaped, featuring a well-maintained lawn perfect for outdoor entertaining.

Perfectly positioned, the home is just a short stroll from the nearest supermarket and only a ten-minute walk to the Killingworth Shopping Centre, which offers a variety of shops and eateries. A nearby leisure centre provides excellent recreational facilities including a swimming pool, sports courts, and gym. The property also benefits from excellent transport links, with regular bus services offering easy access to Newcastle City Centre and North Tyneside. Well-regarded primary and secondary schools are within walking distance, making this an ideal location for families.

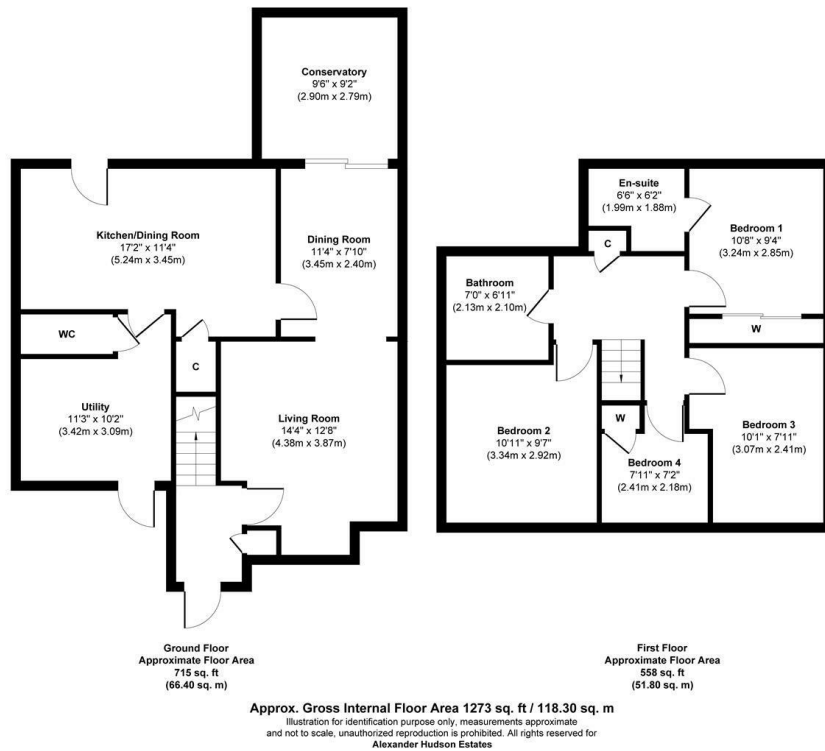

Freehold
Council Tax: D
EPC Rating: null





Alexander Hudson Estates
The Printworks
20 Arrow Close
NE12 6QN

0191 268 7433
sales@alexanderhudson.co.uk