



Alexander Hudson Estates

Sales Particulars

Alexander Hudson Estates

Parkside House, Killingworth Drive, West Moor, NE12



The Property

Alexander Hudson Estates are proud to introduce to the market this immaculately presented two-bedroom apartment, ideally located in one of West Moor's most sought-after and prestigious residential areas.

Upon entering the property, you are greeted by a welcoming entrance hallway that sets the tone for the rest of the home. The heart of the apartment is the expansive, open-plan living and dining room, which benefits from large windows that flood the space with an abundance of natural light. The kitchen is equally bright and well proportioned, featuring contemporary cabinetry, ample worktop space, and room for appliances.

The property features two well-proportioned double bedrooms, both of which benefit from large windows that allow natural light to pour in, enhancing the feeling of space and comfort. The family bathroom is finished to a high standard, with modern fixtures and a clean, neutral aesthetic.

An added bonus is the outer house, currently used as a studio. This versatile space offers endless potential and could serve as a home office, creative workshop, or even a third bedroom, depending on your needs.

Externally, the apartment boasts a substantial private front garden and driveway offering off-street parking for multiple vehicles.

West Moor is a thriving residential area with a strong sense of community. The property is conveniently close to key employment hubs such as Gosforth, Balliol, and Quorum Business Parks, and is within easy reach of the A1 and A19, making it ideal for commuters. Nearby Killingworth offers a wide range of amenities including The Killingworth Centre, anchored by a large Morrisons supermarket, and the White Swan Centre, which houses a GP surgery, activity hall, café, and library. For leisure, the Lakeside Centre provides facilities such as a swimming pool and soft play area, catering to both families and fitness enthusiasts.

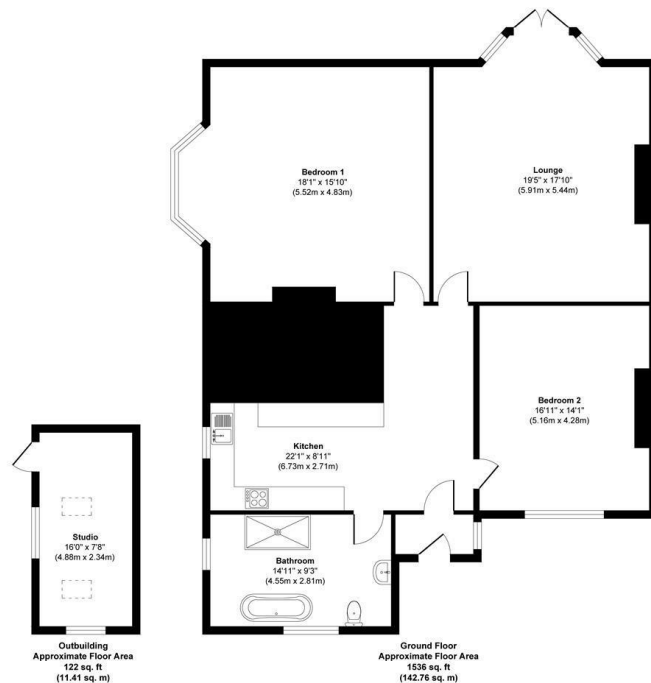

Approx. Gross Internal Floor Area 1658 sq. ft / 154.17 sq. m
Illustration for identification purpose only, measurements approximate
and not to scale, unauthorized reproduction is prohibited. All rights reserved for
Alexander Hudson Estates

Freehold
Council Tax: C
EPC Rating: 0

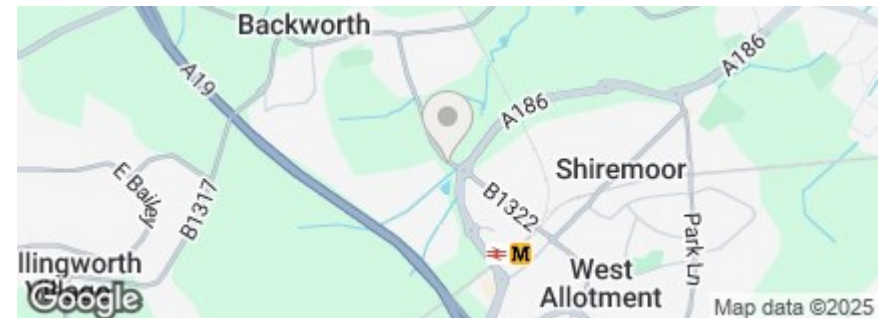



Alexander Hudson Estates
The Printworks
20 Arrow Close
NE12 6QN

0191 268 7433
sales@alexanderhudson.co.uk