



Alexander Hudson Estates

Sales Particulars

Alexander Hudson Estates

Beacon Drive, Wideopen, NE13



The Property

New to the market, a well presented, two bedroom, first floor apartment in the popular residential area of Brunswick Green, Wideopen, NE13.

This well-presented, two-bedroom first floor apartment is offered unfurnished and available immediately and benefits from a private garage and garden which includes a gardening contract in the monthly rental payments.

The apartment features a comfortable and spacious layout, ideal for professionals, couples, or small families. Both bedrooms are generously sized, while the living areas are bright and welcoming, offering a great space to relax or entertain.

The location is a key highlight, with excellent access to transport links including the A1 and nearby Newcastle City Centre, making commuting simple and efficient. Local shops, restaurants, and everyday amenities are all within walking distance, ensuring everything you need is close to hand. For those who enjoy the outdoors, Big Waters Country Park is just a ten-minute walk away, offering peaceful nature trails and scenic walks.

Council Tax: A
EPC Rating: 73

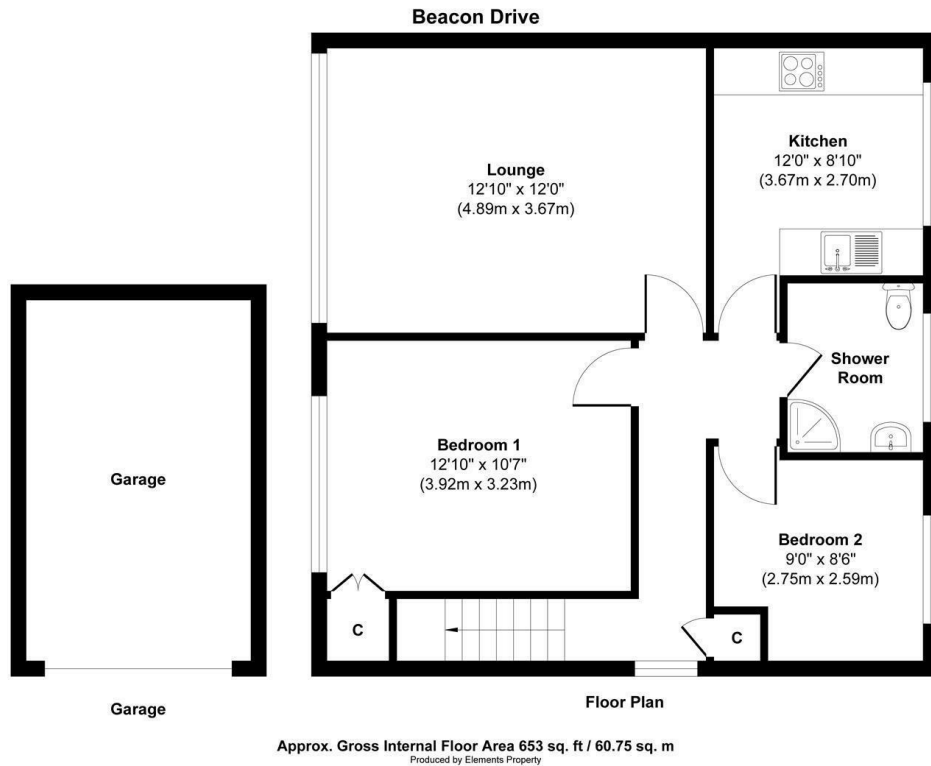



Alexander Hudson Estates
The Printworks
20 Arrow Close
NE12 6QN

0191 268 7433
sales@alexanderhudson.co.uk