



# Alexander Hudson Estates

---

Sales Particulars

# Alexander Hudson Estates

Beacon Drive, Wideopen, NE13



# The Property

Alexander Hudson Estates welcomes to the market this two-bedroom, first floor apartment in the popular residential area of Wideopen, NE13 with no onward chain.

The property briefly comprises of an entrance hallway with storage cupboard, kitchen, living room, family bathroom and two spacious bedrooms. Externally the property benefits from access to a rear garden and detached single garage.

The property is within easy reach of the A1, Newcastle City Centre and walking distance to local shops, restaurants and amenities. Big Waters Country Park is located just a ten minute walk away offering science walks within nature.

Leasehold  
Council Tax: A  
EPC Rating: 70

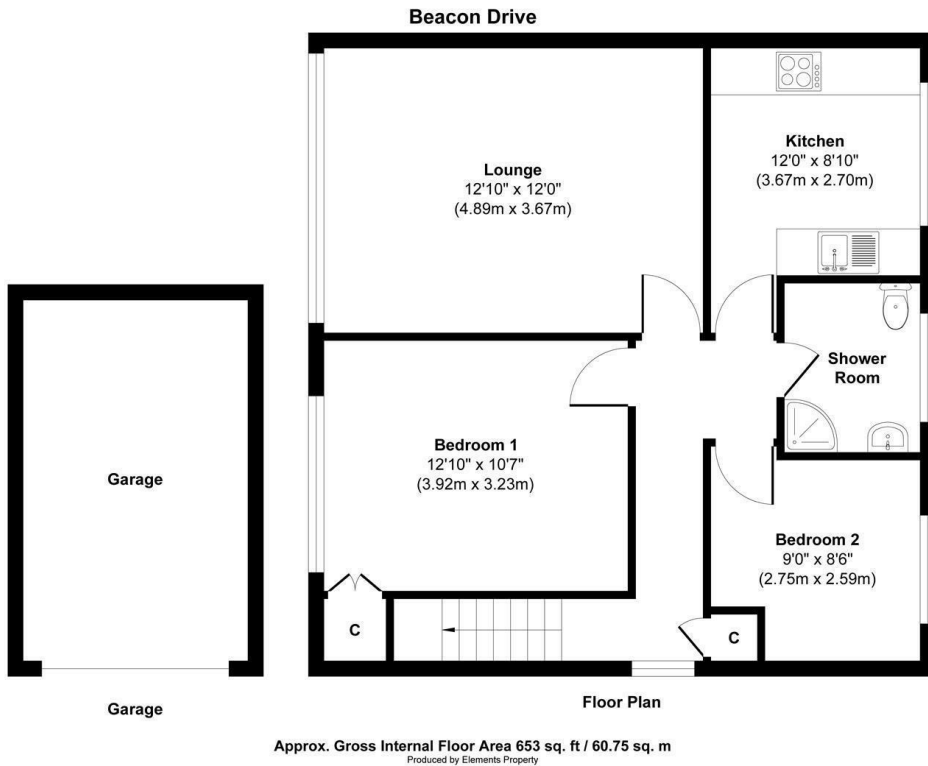



---

Alexander Hudson Estates  
The Printworks  
20 Arrow Close  
NE12 6QN

0191 268 7433  
[sales@alexanderhudson.co.uk](mailto:sales@alexanderhudson.co.uk)