



Alexander Hudson Estates

Sales Particulars

Alexander Hudson Estates

Hawks Edge, West Moor, NE12



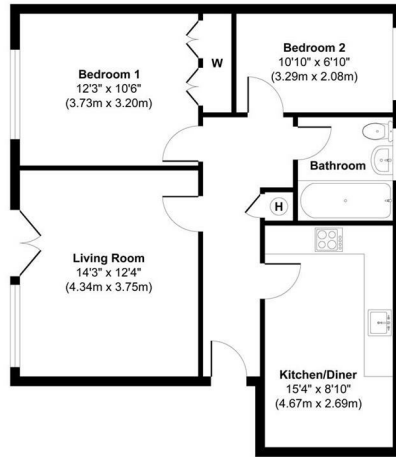

Approx. Gross Internal Floor Area 687 sq. ft / 63.90 sq. m
 Illustration for identification purposes only. Measurements approximate
 and not to scale. Unauthorised reproduction is prohibited. All rights reserved for
 Alexander Hudson Estates

The Property

Alexander Hudson Estates introduces this bright and airy, two-bedroom apartment situated in the popular development of Hawks Edge in Westmoor. Close-by to local amenities including schools, supermarkets, shops and leisure facilities along with excellent transport links across the region.

The property briefly comprises of an entrance hallway, living room, open plan kitchen diner, bathroom and two double bedrooms. Externally the property is well maintained and benefits from a private parking bay.

Close to Gosforth, Balliol, and Quorum Business Parks, with the A1 and A19 easily accessible for those commuting further afield. West Moor is also adjacent to Killingworth, home to The Killingworth Centre (anchored by a large Morrison's supermarket), and the White Swan Centre, which includes a Doctors' surgery, an activity hall, a cafe and Killingworth Library. The Lakeside Centre is also close by, a leisure centre which offers a swimming pool, indoor sports courts, a gym and even a soft play for children.

Leasehold
 Council Tax: B
 EPC Rating: 66





Alexander Hudson Estates
The Printworks
20 Arrow Close
NE12 6QN

0191 268 7433
sales@alexanderhudson.co.uk