



Alexander Hudson Estates

Sales Particulars

Alexander Hudson Estates

Whitecroft Road, West Moor, NE12



The Property

Alexander Hudson Estates are pleased to introduce to market this bright and spacious, three-bedroom, semi-detached family home situated in the popular residential area of West Moor, close-by to a range of local amenities, transport links and schooling.

Brimming with potential, the property briefly comprises of an entrance hallway, living room open to dining room, a separate kitchen and integral garage. On the first floor lies a shower room and three bedrooms, two double and one single. At the front is a large driveway, whilst a large, mature and leafy garden sits at the rear leading to a tranquil river brook.

The property is close to Gosforth, Balliol, and Quorum Business Parks, with the A1 and A19 easily accessible for those commuting further afield. West Moor is also adjacent to Killingworth, home to The Killingworth Centre (anchored by a large Morrison's supermarket), and the White Swan Centre, which includes a Doctors' surgery, activity hall, Cafe and Killingworth Library. The Lakeside Centre offers up various leisure facilities including a swimming pool and soft play for children.

Freehold
Council Tax: C
EPC Rating: 59

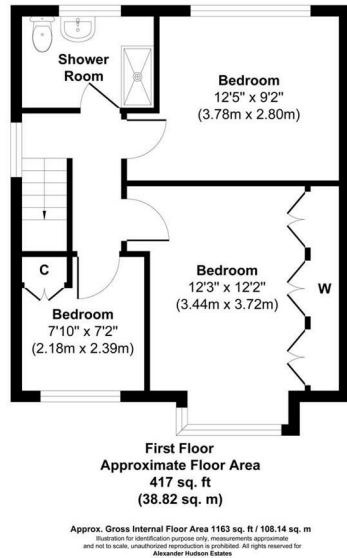



Alexander Hudson Estates
The Printworks
20 Arrow Close
NE12 6QN

0191 268 7433
sales@alexanderhudson.co.uk