



# Alexander Hudson Estates

---

Sales Particulars

West Farm Avenue

Longbenton

NE12 8UU





Alexander Hudson Estates introduces to market this stunning, two bedroom, 2nd floor flat. Located within the increasingly popular area of Longbenton, NE12.

Beautifully presented and maintained throughout comprising of an entrance hallway, living room, fully-integrated kitchen with dining area, two double bedrooms and a bathroom.

Close-by to Longbenton metro station, this property sits in a prime location for travelling across the city, and benefits from having good schools and a range of local amenities such as shops, pubs and restaurants all within walking distance. Four large parks including Tyneview Park are all within a one-mile radius of the property, offering up plenty of scenic walking routes and open green space.

Tenure: Leasehold    Council tax band: A    EPC Rating: D









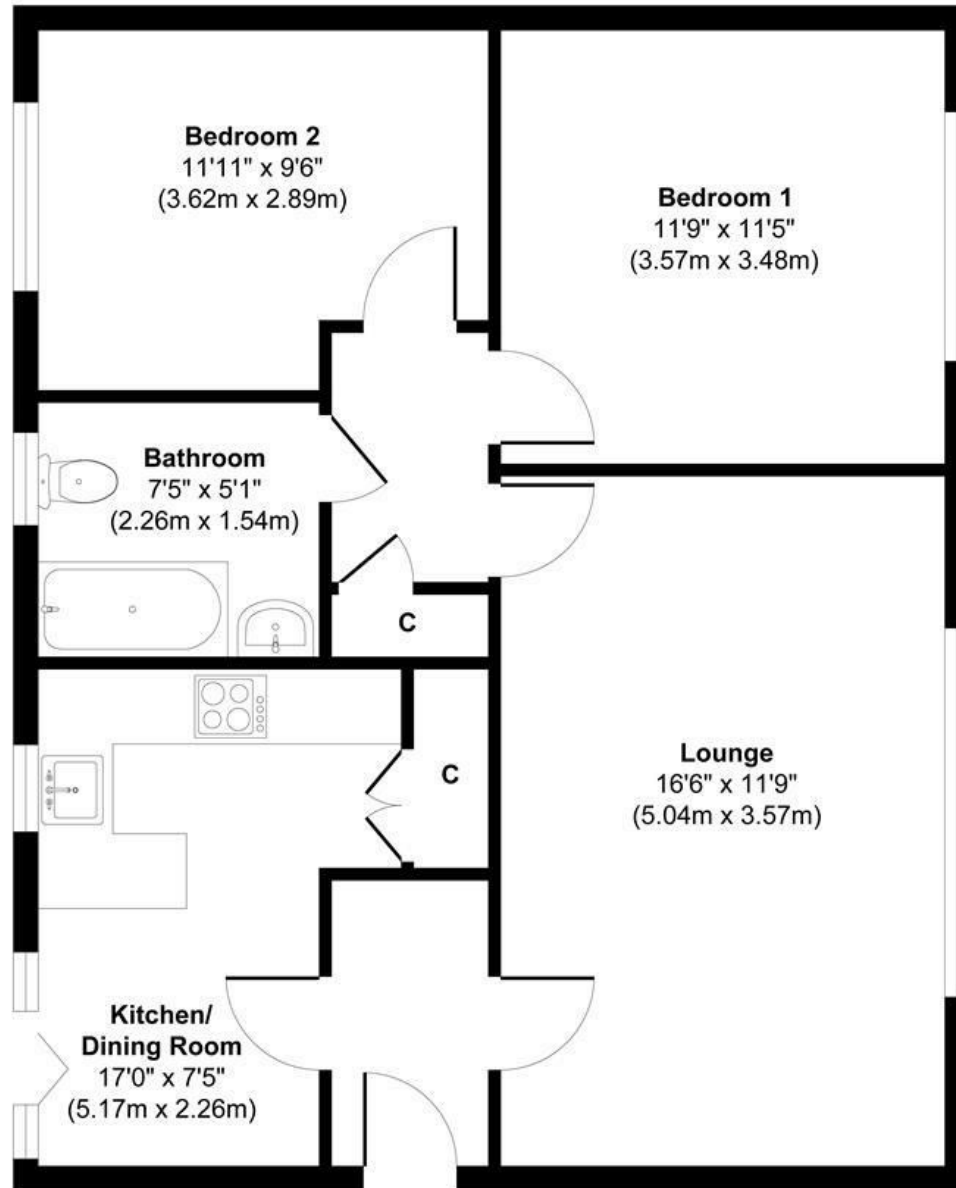

**Floor Plan**

**Approx. Gross Internal Floor Area 716 sq. ft / 66.48 sq. m**

Illustration for identification purpose only, measurements approximate and not to scale, unauthorized reproduction is prohibited. All rights reserved for Alexander Hudson Estates