



# Alexander Hudson Estates

---

Sales Particulars

Kenilworth

Killingworth

NE12 6NW





Alexander Hudson Estates introduces to market this immaculately presented two-bedroom, ground floor apartment in Killingworth, NE12.

Bright and spacious throughout, the property briefly comprises of entrance hallway, living room with conservatory, kitchen, two generously sized bedrooms and a bathroom. Externally, the property benefits from a sunny rear garden and detached garage.

The property is ideally located and within easy reach of local primary and secondary schools and sits close to a local bus route, with links to Newcastle City Centre, Quorum, Balliol and Gosforth Business Parks; whilst the A19 is only a short drive away for trips further afield. The Killingworth Shopping Centre, White Swan Centre and The Lakeside Centre are all close-by and within walking distance. Both Killingworth Boating Lake with its bridleways and Lakeside Park offer idyllic settings, perfect for family walks and exercise.



Tenure: Leasehold Council tax band: A EPC Rating:







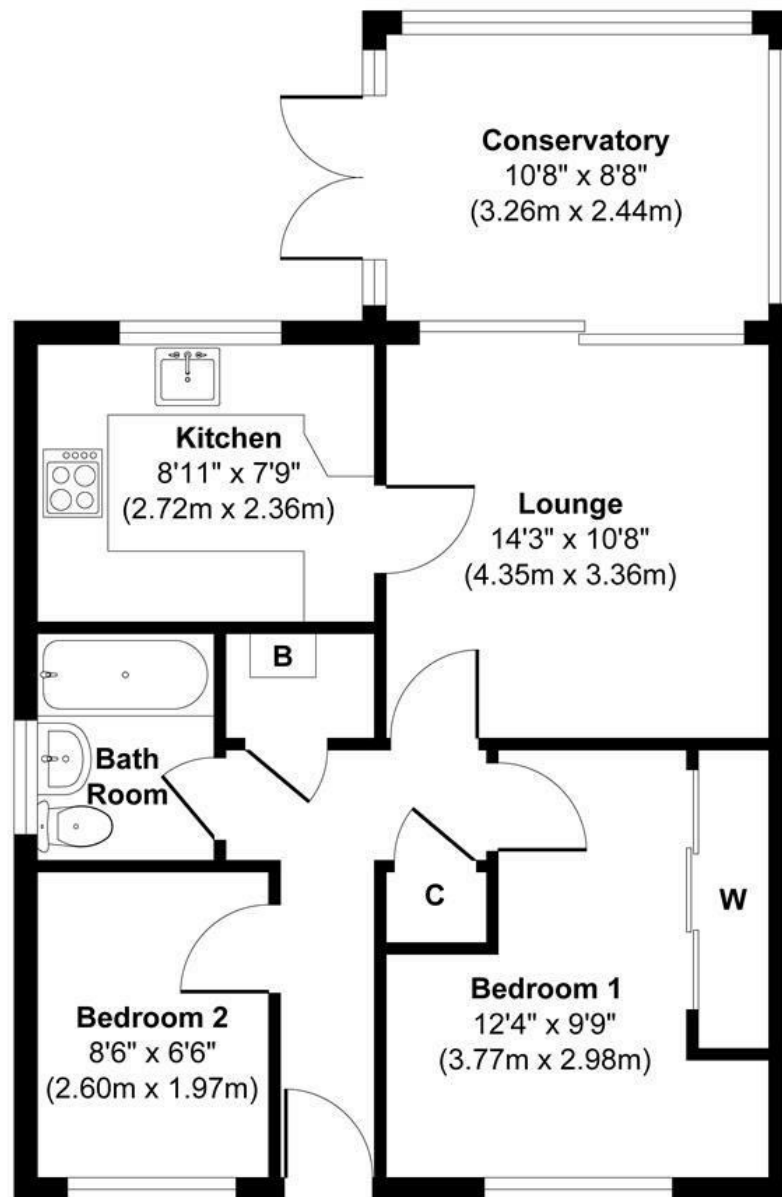

**Approx. Gross Internal Floor Area 568 sq. ft / 52.77 sq. m**

Illustration for identification purpose only, measurements approximate and not to scale, unauthorized reproduction is prohibited. All rights reserved for Alexander Hudson Estates