



# Alexander Hudson Estates

---

Sales Particulars

Forest Gate

Palmersville

NE12 9EN









Alexander Hudson Estates introduces to market this stunning, three-bedroom, mid-terrace family home in the popular residential area of Forest Gate, NE12.

The property briefly comprises of an entrance porch, living room and open plan kitchen/ diner. On the first floor lies a modern family bathroom and three generously sized bedrooms. Externally the front of the property benefits from a well maintained garden. Whilst a generously sized garden with patio area and garden lawn sit to the rear.

The property lies just a 5-minute drive (or 15-minute walk) from a large Asda supermarket and is a similar distance from The Rising Sun Country Park, a green oasis of 162 hectares. With ponds, woodlands and extensive grasslands, the site is an ideal place to relax and enjoy the great outdoors. Killingworth Shopping Centre is also only a 10 minute drive, offering another large supermarket and various high street shops; whilst The Lakeside Centre is also close by, a leisure centre which offers a swimming pool, indoor sports courts, a gym and a soft play for children. Palmersville Metro Station and the A19 offer ease of access across Newcastle and further afield.



Tenure: Freehold Council tax band: B EPC Rating: C













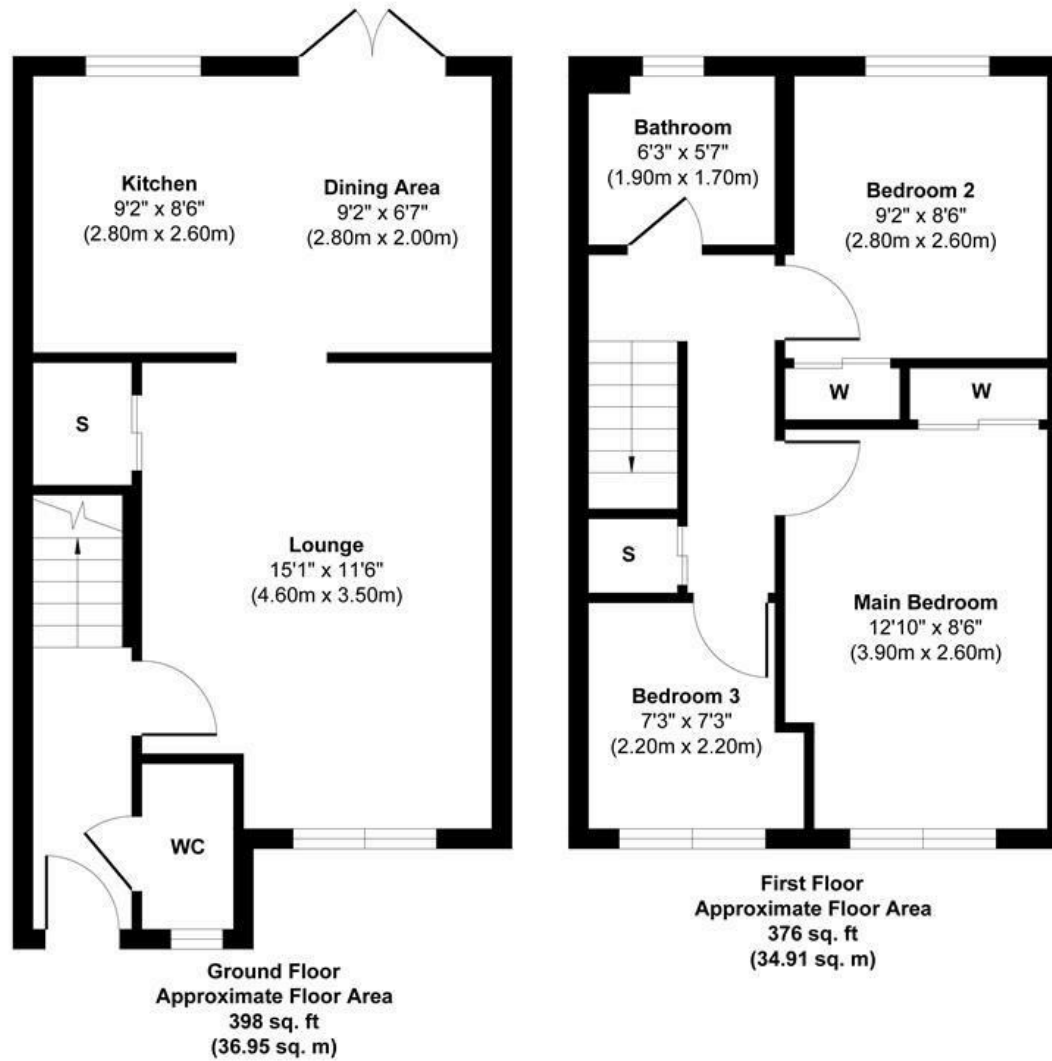

**Approx. Gross Internal Floor Area 773 sq. ft / 71.86 sq. m**

Illustration for identification purpose only, measurements approximate  
and not to scale, unauthorized reproduction is prohibited. All rights reserved for  
**Alexander Hudson Estates**