



Alexander Hudson Estates

Sales Particulars

Edgefield

West Allotment

NE27 0BT



30

30

30

30

30

30

30

30

30

30

30

30

30

30

30

30

30

30

30

30

30

30



Alexander Hudson Estates introduces to the market this two-bedroom, first floor apartment situated in the popular residential area of West Allotment, NE27.

Bright and spacious throughout, the property briefly comprises of an entrance hallway, living room and separate kitchen. On the first floor lies two generously sized bedrooms and a bathroom. Externally the apartment complex is very well maintained and benefits from a private carpark.

The property is in an excellent location and within easy walking distance to Northumberland Retail Park, restaurants, supermarkets and both primary and secondary schools. A frequent bus service and Metro can take you through to Newcastle City Centre, the Coast and beyond, with the A19 also situated close by providing easy access to Northumberland and both Silverlink and Cobalt Business Parks. The Rising Sun Country Park is only a 5-minute drive, offering great outdoor walks and an idyllic space.









WASH YOUR HANDS FOR THE WORLD



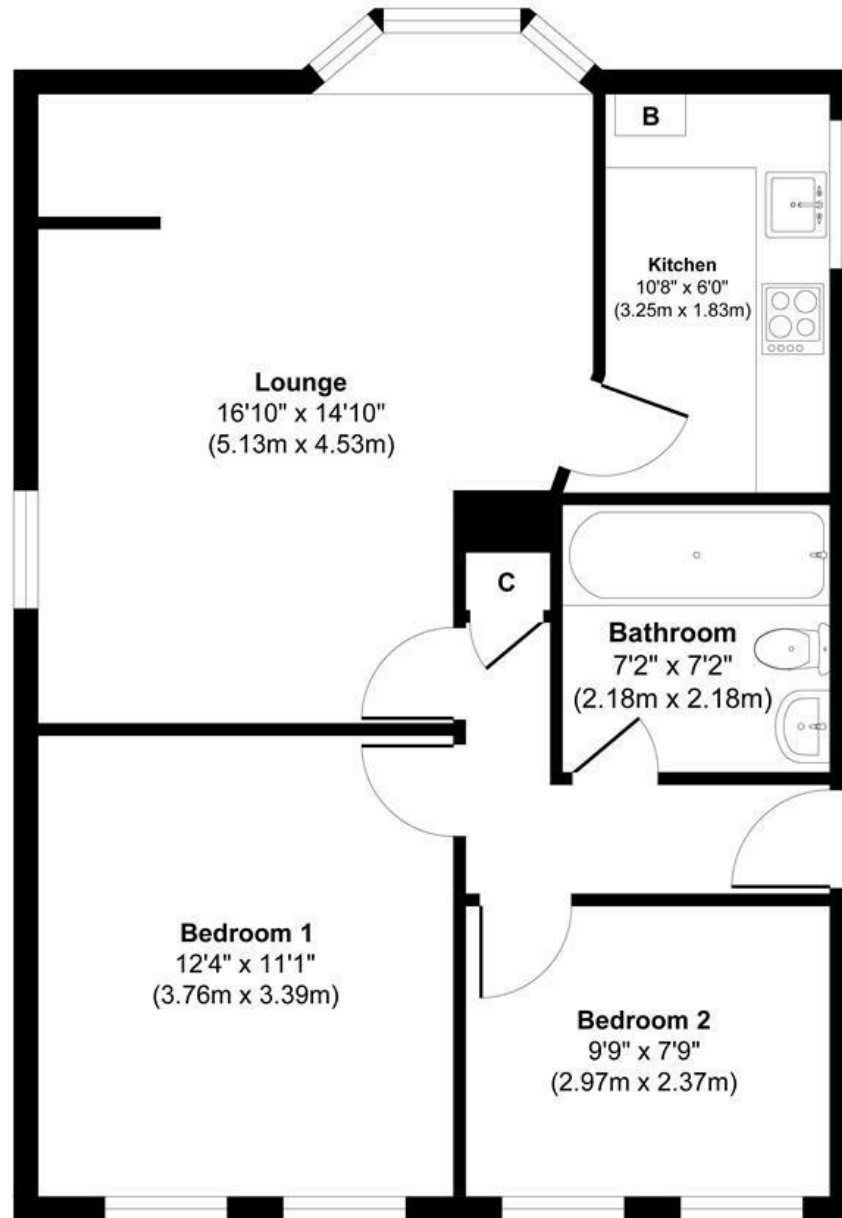

Approximate Floor Area
634 sq. ft
(58.93 sq. m)

Approx. Gross Internal Floor Area 634 sq. ft / 58.93 sq. m
Illustration for identification purposes only, measurements approximate and not to scale,
unauthorized reproduction is prohibited. All rights reserved for
Alexander Hudson Estates