



, London, NW3 2QT

Asking Price £1,850,000



56 Fleet Road



Description

A delightful four bedroom end-of-terrace Victorian house, located moments from Hampstead Heath.

Arranged over three floors, the property is beautifully presented and benefits from a 24ft through-reception/dining room with high ceilings and feature fireplace and a spacious kitchen/diner leading to a pretty secluded rear patio garden. Further benefits include four double bedrooms, family bathroom, shower room/wc, and roof terrace.

Fleet Road is located in the heart of South End Green with its cafés and bars and the area's only M&S Food Store, and only 7 minutes' walk from the entrance to Hampstead Heath, as well as being within easy reach of the outstanding array of cultural and culinary attractions and nightlife of both Belsize Park and Hampstead Village. Hampstead Heath Overground Station and Belsize Park (Zone 2 Northern Line) tube station are less than 10 minutes' walk, providing excellent transport links to the City and West End.

- End Of Terrace Three Storey House
- Through Reception
- Secluded Patio Garden
- Close To Hampstead Heath
- 4 Double Bedrooms
- 2 Bathrooms
- Roof Terrace





Floor Plan

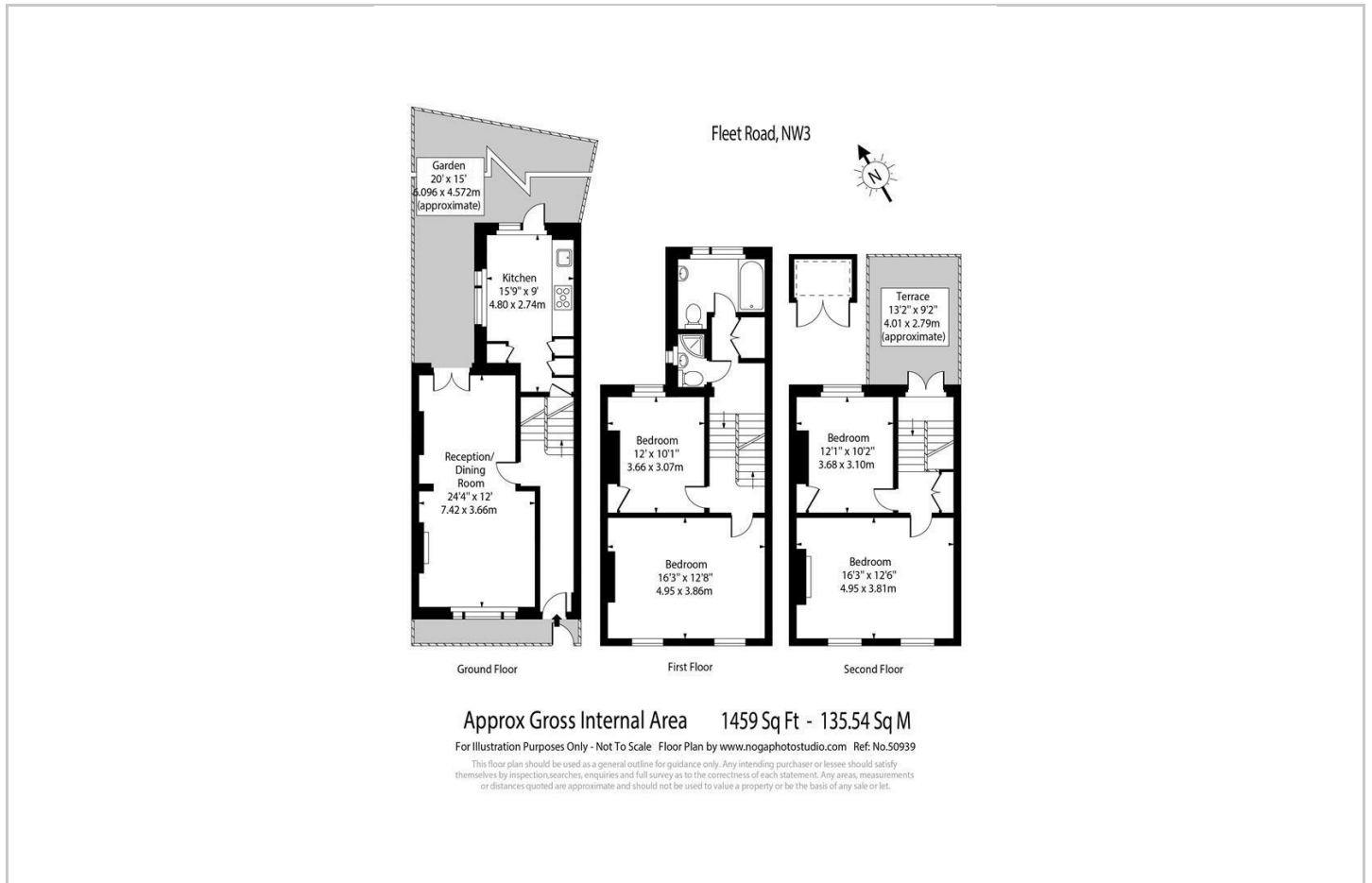

Area Map

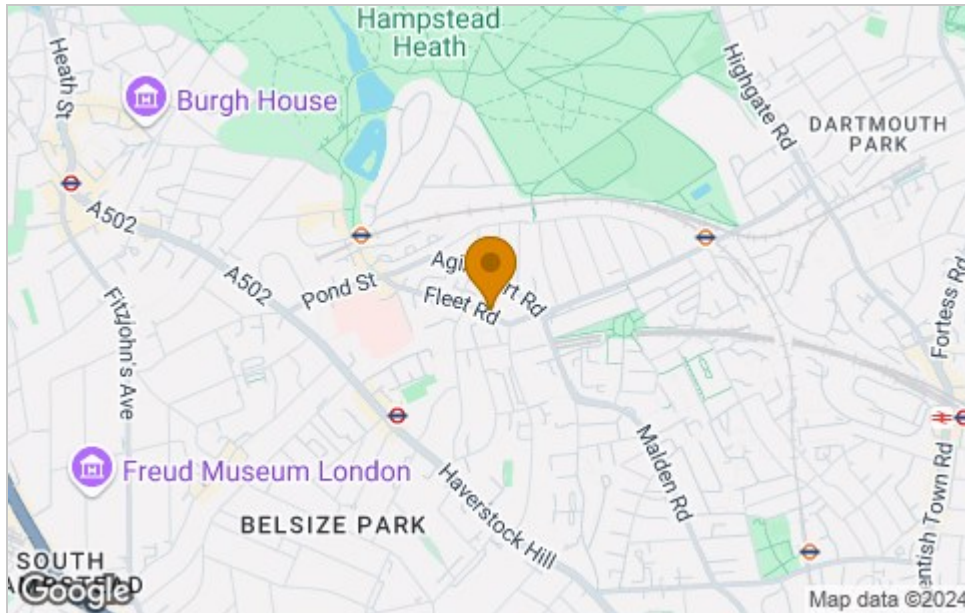

Energy Efficiency Graph

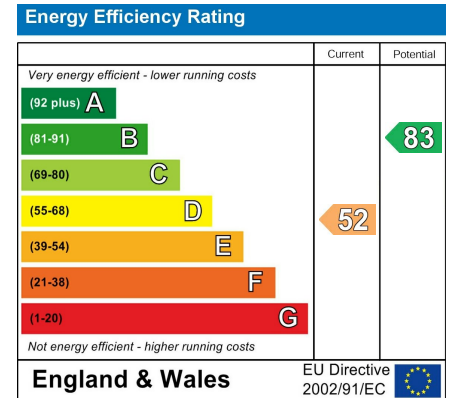

Viewing

Please contact our Hampstead Sales Office on 020 7431 1881 if you wish to arrange a viewing appointment for this property or require further information.

These particulars, whilst believed to be accurate are set out as a general outline only for guidance and do not constitute any part of an offer or contract. Intending purchasers should not rely on them as statements of representation of fact, but must satisfy themselves by inspection or otherwise as to their accuracy. No person in this firm's employment has the authority to make or give any representation or warranty in respect of the property.

47 South End Road, Hampstead, London, NW3 2QB
 Tel: 020 7431 1881 Email: hampstead@salter-rex.co.uk salter-rex.co.uk