



Hampstead Heath, London, NW3 2HP

Asking Price £850,000



3



2



1



D

36 Mansfield Road



Description

A stunning three bedroom, two bathroom duplex apartment, extending to approximately 933 sq. ft., arranged over the second and third (top) floors of a four storey terraced period house, situated in the sought after Mansfield Conservation Area.

The property is bright, spacious, and tastefully presented, enjoying well appointed living space with lots of natural light, and comprises two double bedrooms with en-suite to the principal bedroom, third bedroom currently used as an office, additional guest shower room/wc., modern kitchen with integrated appliances, a 17'6" sunny reception with wood flooring and feature fireplace, and a delightful private roof terrace.

Mansfield Road is located close to Hampstead Heath and within easy reach of the shops and cafés in South End Green and Hampstead Heath Overground Station, as well as the wide range of amenities at nearby Hampstead High Street, with Belsize Park (Northern Line) Tube Station less than fifteen minutes walk away, providing excellent transport links to the City and West End.

- Split-level Maisonette
- Office/Third Bedroom
- Superb Private Roof Terrace
- Close To Hampstead Heath
- Two Double Bedrooms
- Large Sunny Reception
- Ensuite Bathroom and Guest Shower Room





Floor Plan

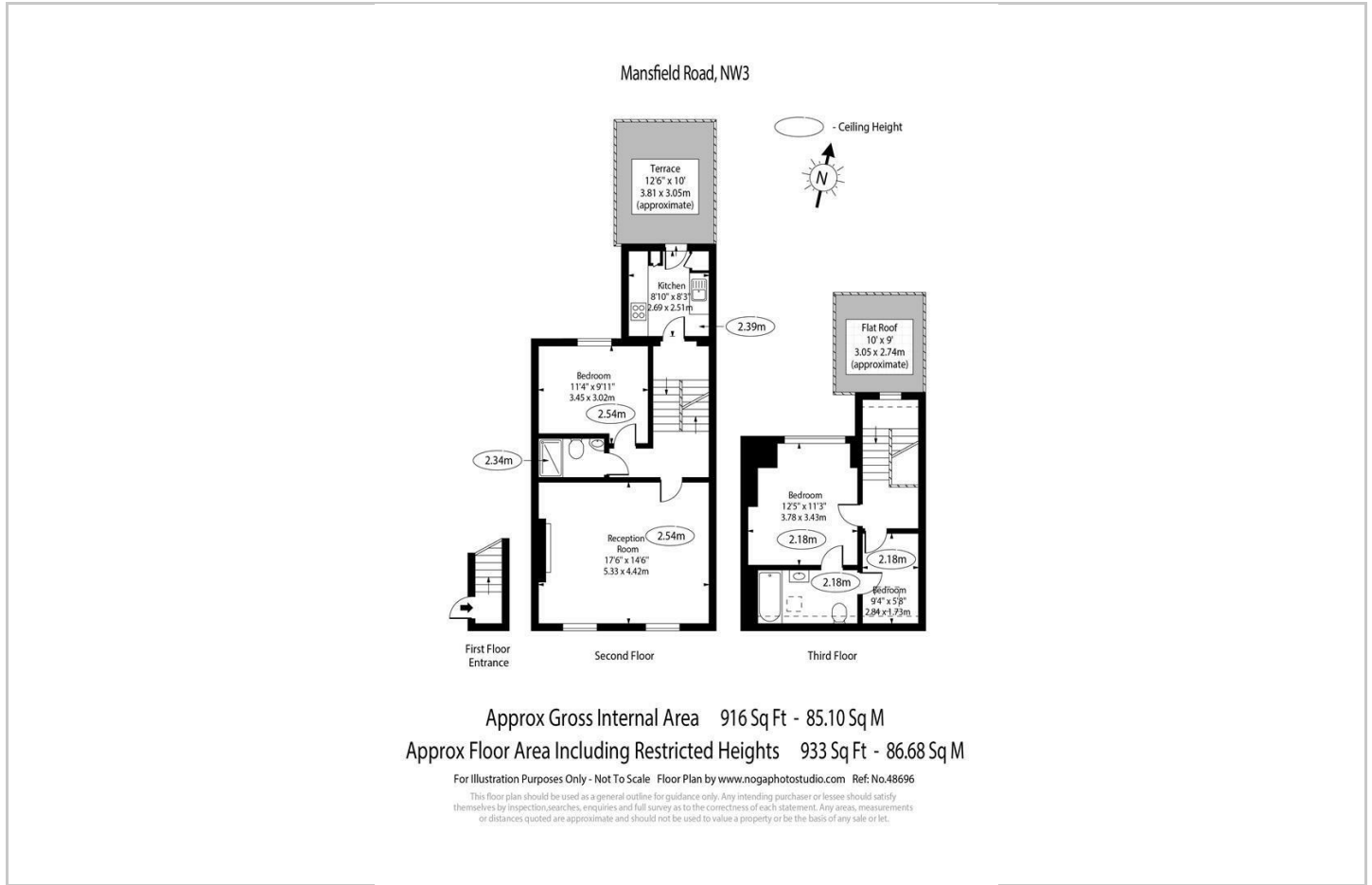

Area Map

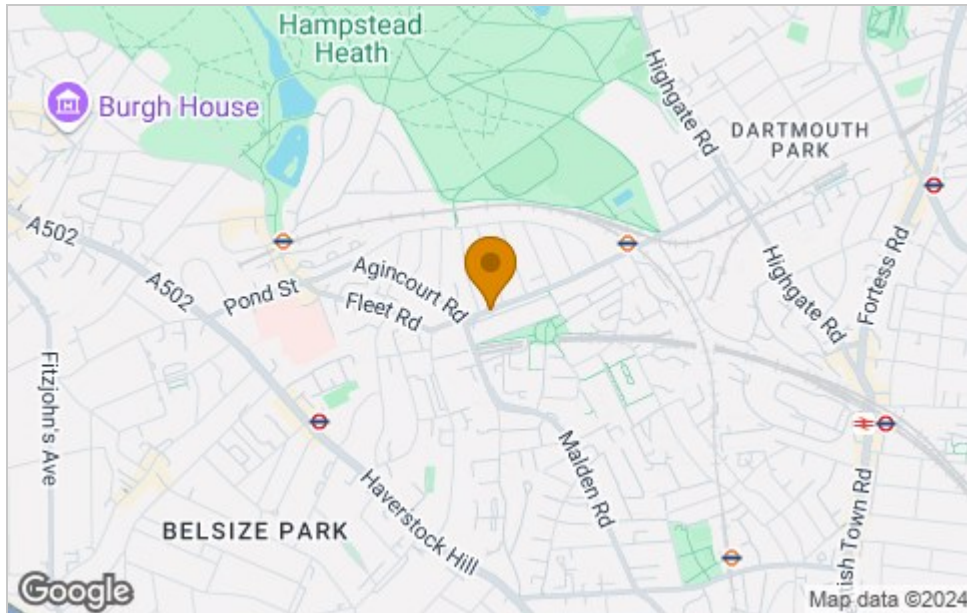

Energy Efficiency Graph

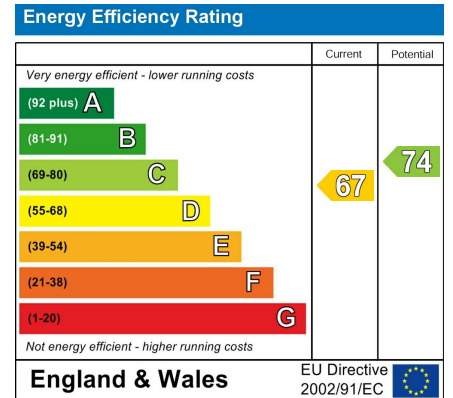

Viewing

Please contact our Hampstead Sales Office on 020 7431 1881 if you wish to arrange a viewing appointment for this property or require further information.

These particulars, whilst believed to be accurate are set out as a general outline only for guidance and do not constitute any part of an offer or contract. Intending purchasers should not rely on them as statements of representation of fact, but must satisfy themselves by inspection or otherwise as to their accuracy. No person in this firm's employment has the authority to make or give any representation or warranty in respect of the property.