



Hampstead Heath, London, NW3 2HS

Asking Price £775,000



2



1



1



C

# 34 Shirlock Road



## Description

A spacious and well presented first floor two double bedroom flat, converted from a well maintained mid-terrace Victorian house, situated in the heart of the Mansfield Road conservation area, approximately only 2 minutes' walk from Hampstead Heath.

This share of freehold flat comprises a bright living room with high ceilings, stripped wood flooring and feature fireplace, separate well-appointed and comprehensively equipped kitchen, family bathroom, two double bedrooms with direct access to the roof terrace from the master bedroom.

Shirlock Road is situated within easy reach of the shops and cafés in South End Green including the areas only M & S, as well as the wide range of amenities at nearby Hampstead High Street. It's only a 7 minute walk to Gospel Oak Overground station or a 10 minute walk to Hampstead Heath Overground, and a 13 minute walk to Belsize Park (Northern Line) tube station, providing excellent transport links to the City and West End.

- First Floor Flat
- Roof Terrace
- Stripped Wood Flooring
- No Onward Chain
- 2 Double Bedrooms
- Sunny Reception
- Moments From Hampstead Heath





## Floor Plan

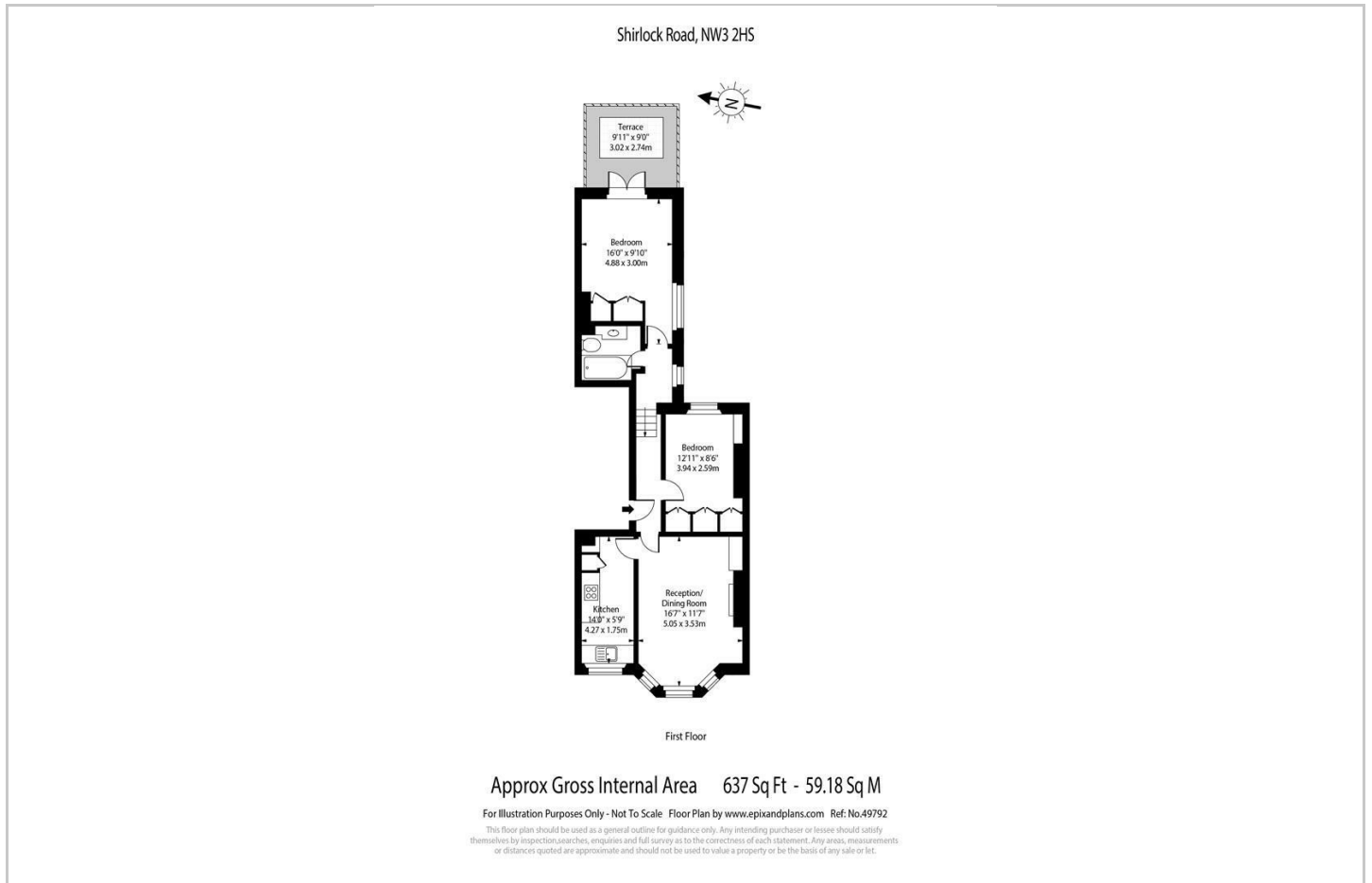

## Area Map

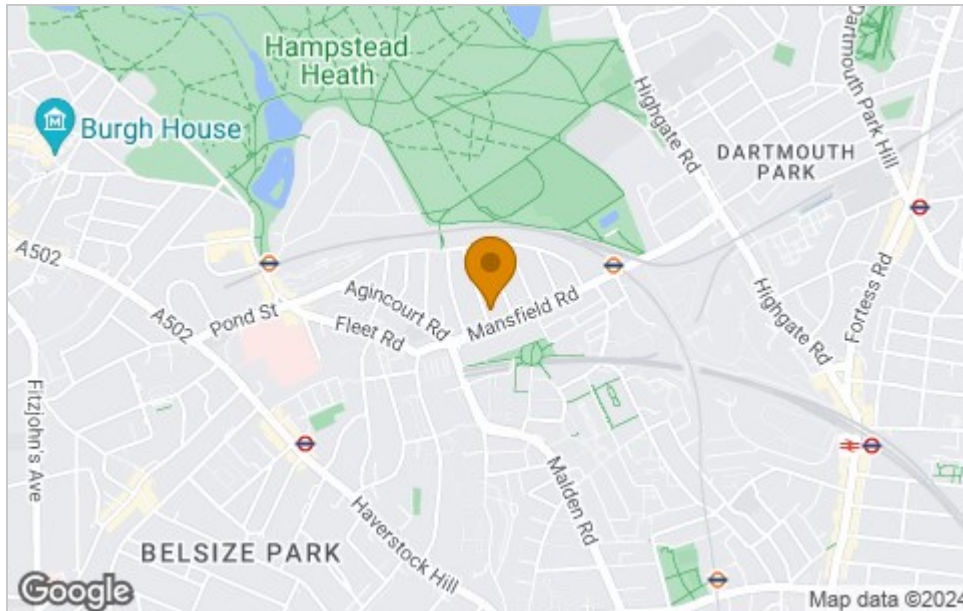

## Energy Efficiency Graph

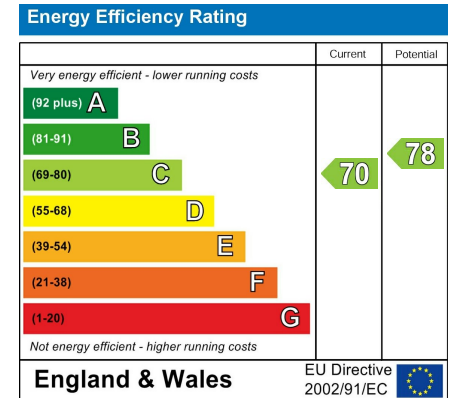

## Viewing

Please contact our Hampstead Sales Office on 020 7431 1881 if you wish to arrange a viewing appointment for this property or require further information.

These particulars, whilst believed to be accurate are set out as a general outline only for guidance and do not constitute any part of an offer or contract. Intending purchasers should not rely on them as statements of representation of fact, but must satisfy themselves by inspection or otherwise as to their accuracy. No person in this firm's employment has the authority to make or give any representation or warranty in respect of the property.

47 South End Road, Hampstead, London, NW3 2QB  
 Tel: 020 7431 1881 Email: [hampstead@salter-rex.co.uk](mailto:hampstead@salter-rex.co.uk) [salter-rex.co.uk](http://salter-rex.co.uk)