



Wordsworth Place

Kentish Town London NW5 4HG

£310,000

FOR BUYERS OVER 50 ONLY A bright and spacious one bedroom purpose built flat, on the second floor of a well-regarded modern development forming part of the picturesque and tranquil St Dominic's Priory complex.

Well maintained and presented to a high standard throughout, the accommodation comprises: a bright and spacious reception, kitchen with integrated appliances, good size bedroom with built in wardrobes and family bathroom/wc. Additional benefits include a passenger lift to all floors, no onward chain, secure gated access and parking space available to rent, subject to availability.

Residents enjoy full use of the beautiful mature quadrangle landscaped communal gardens set in the tranquil surroundings of St Dominic's Priory. Belsize Park and Chalk Farm tube stations and the open spaces of the glorious Hampstead Heath are within easy walking distance.

Service Charge - £803 pa
Ground rent - £100pa
Lease 87 years
Council tax band D

- For buyers over 50 exclusively
- One bedroom purpose built flat
- Spacious reception
- Modern kitchen with appliances
- Good size double bedroom
- Double glazing
- Tranquil communal gardens
- Chain free

Viewing

Please contact our Kentish Town Sales Office on 0207 482 4488 if you wish to arrange a viewing appointment for this property or require further information.



Floor Plan

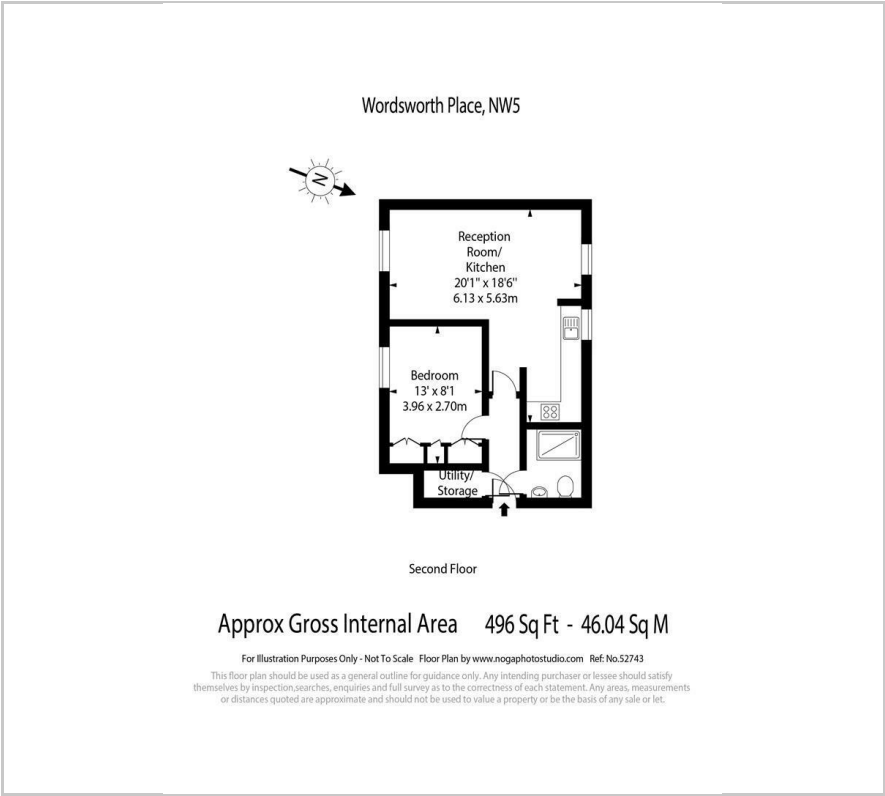

Area Map

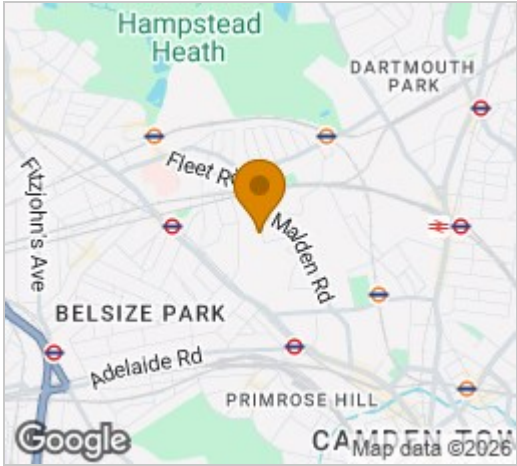

Energy Efficiency Graph



These particulars, whilst believed to be accurate are set out as a general outline only for guidance and do not constitute any part of an offer or contract. Intending purchasers should not rely on them as statements of representation of fact, but must satisfy themselves by inspection or otherwise as to their accuracy. No person in this firms employment has the authority to make or give any representation or warranty in respect of the property.