



Wordsworth Place

London NW5 4HG

£365,000

EXCLUSIVELY FOR THOSE OVER 50 YEARS OF AGE.

A delightful, bright and spacious one bedroom apartment on the top floor of a modern purpose-built development.

Well-presented throughout, offering 586 square feet of conveniently-arranged accommodation, the flat is filled with natural light from the large windows, which afford a very pleasantly verdant outlook.

In particular, the very spacious open plan reception opens onto a good size kitchen, complete with a good range of fitted appliances. The bedroom has a full complement of fitted wardrobes and there is a good size modern bathroom/wc.

Wordsworth Place has the additional benefits of a lift to all floors, communal residents meeting room, and is located within a secure well maintained gated complex.

Residents of this unique development, have full use of the beautiful mature quadrangle landscaped communal gardens set in the tranquil surroundings of St Dominic's Priory, Belsize Park and Chalk Farm tube stations and the open spaces of the glorious Hampstead Heath are also within easy reach.

- Delightful bright and spacious top floor apartment.
- Large double bedroom
- Fabulous open plan reception room with Juliet balcony
- Fitted kitchen with appliances
- Modern bathroom/wc
- Extensive fitted wardrobes
- Private gated secure complex
- Beautiful communal gardens
- Lift to all floors
- Over 50's only

Viewing

Please contact our Kentish Town Sales Office on 0207 482 4488 if you wish to arrange a viewing appointment for this property or require further information.



1



1



1



Floor Plan

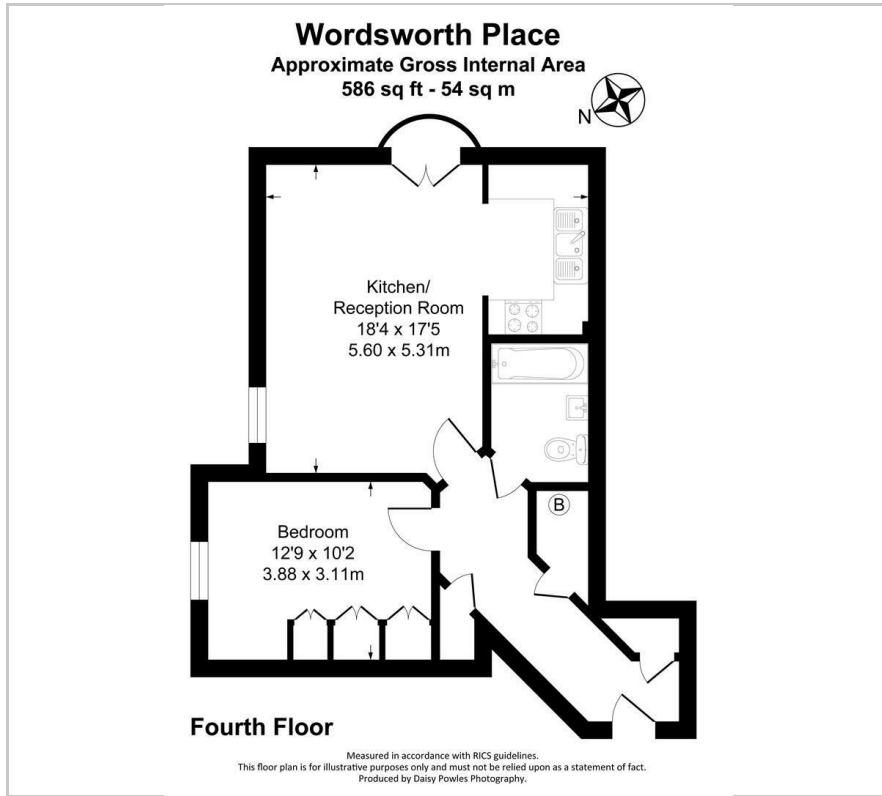

Area Map



Energy Efficiency Graph

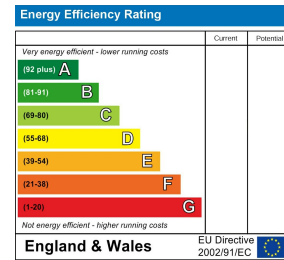

These particulars, whilst believed to be accurate are set out as a general outline only for guidance and do not constitute any part of an offer or contract. Intending purchasers should not rely on them as statements of representation of fact, but must satisfy themselves by inspection or otherwise as to their accuracy. No person in this firm's employment has the authority to make or give any representation or warranty in respect of the property.