

Goulding Street, Chorley

PR7 3EP

£750 pcm





Two bedroom terrace property situated close to Chorley town centre with access to all local amenities including shops and schools and excellent access to transport links.

The property briefly comprises of a vestibule leading into the lounge with grey flooring and bay window. The modern kitchen diner has a range of wall and base units with space and plumbing for cooker, fridge freezer and washing machine.

Carpeted stairs lead to the first floor which includes a large double bedroom to the front of the property and a comfortable single to the rear, both are carpeted and neutrally decorated. The three-piece family bathroom comprises of walk-in shower enclosure, wash hand basin and wc. Externally is an enclosed private yard with storage shed and access to the rear alleyway.

The property is available now and has gas central heating and is fully glazed. It requires a deposit of £865 including holding deposit of £170. The Zero Deposit Scheme is also available.



The property is available now and has gas central heating and is fully glazed. It requires a deposit of £865 including holding deposit of £170. The Zero Deposit Scheme is also available.
Council Tax band: A

Tenure: Freehold

EPC Energy Efficiency Rating: C

- Zero deposit scheme available
- Private rear yard
- Close to town centre
- Available now



HOME  TRUTHS

Ecclestone Branch

265 The Green, Ecclestone, PR7 5TF
01257 451673

Coppull Branch

244 Spendmore Lane, Coppull, PR7 5DE
01257 794588

www.hometruthslancs.co.uk
office@hometruthslancs.co.uk

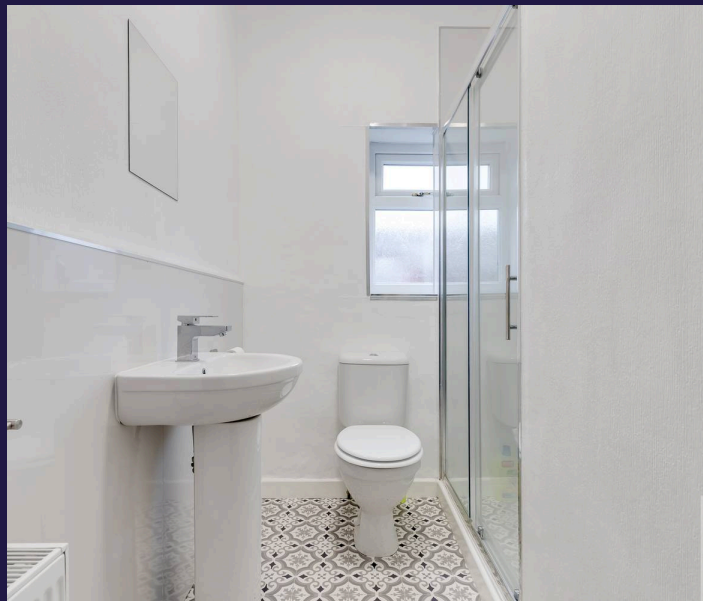

Ground Floor

Approx. 32.6 sq. metres (351.1 sq. feet)

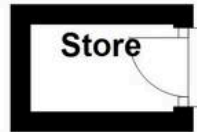

First Floor

Approx. 30.7 sq. metres (331.0 sq. feet)

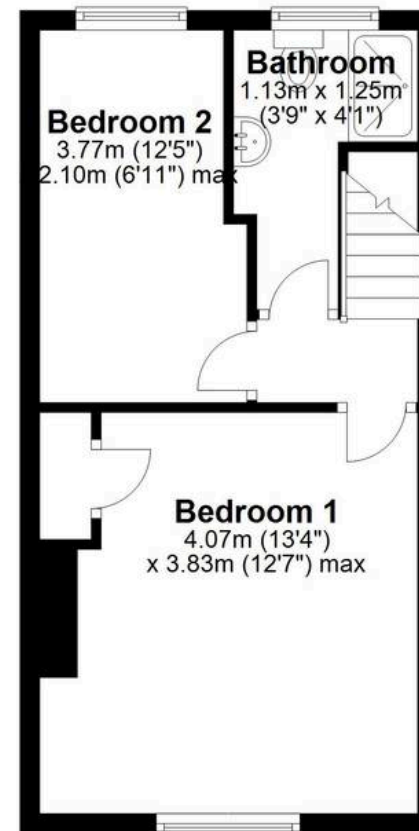
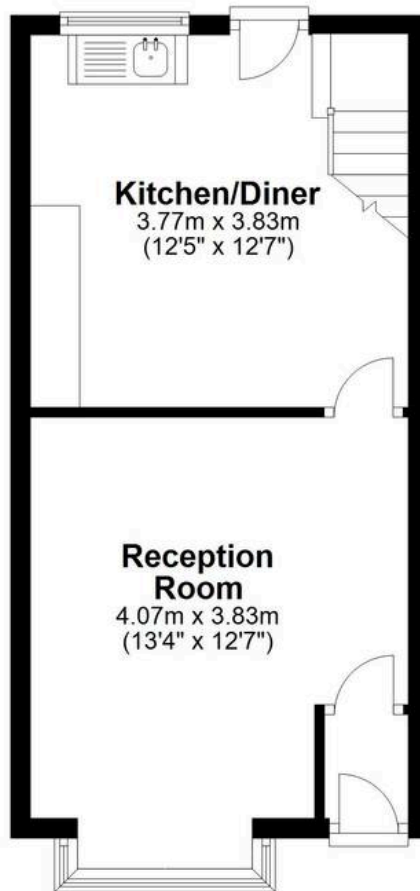

Total area: approx. 63.4 sq. metres (682.0 sq. feet)

THIS FLOOR PLAN IS FOR ILLUSTRATION ONLY AND IS NOT A SCALE DRAWING, SQFT IS AN APPROXIMATE GUIDE
Plan produced using PlanUp.