

HOME  TRUTHS



Richmond Road, Ecclestone

PR7 5SR



£245,000



Spacious true bungalow with three bedrooms, southwest facing rear garden, sun room and potential to extended upwards if required. In a sought after residential area close to village amenities, primary transport routes and countryside walks. The driveway can accommodate several vehicles and leads past the lawn with well stocked borders and leads to the garage and main entrance. Step into the hallway and from there into the living room with gas fire in stone hearth. The kitchen comprises a range of wall and base units with integrated appliances including induction hob, double electric oven and grill, refrigerator, freezer and space, power and plumbing for other appliances. Leading off is the spacious sun room with views over the garden. Bedrooms one and two are good sized doubles to the rear and front respectively, with bedroom three a comfortable single currently in operation as the dining room. The bathroom comprises fully tiled elevations and flooring, p shaped bath with screen and mixer shower over, wc, wash hand basin and ladder heated towel rail. With over 900 square feet of versatile accommodation on offer this is a great place to live for people wanting their living on one level without compromising on space.

34 Richmond Road

Eccleston, Chorley

Spacious extended true bungalow with three bedrooms, southwest facing rear garden, sun room and potential to extended upwards if required. In a sought after residential area close to village amenities, primary transport routes and countryside walks.

Council Tax band: C

Tenure: Freehold

- Semi detached true bungalow
- Three bedrooms
- Sun room
- Private south facing garden
- Garage and parking
- Virtual tour



HOME  TRUTHS

Eccleston Branch

265 The Green, Eccleston, PR7 5TF
01257 451673

Coppull Branch

244 Spendmore Lane, Coppull, PR7 5DE
01257 794588

www.hometruthslancs.co.uk
office@hometruthslancs.co.uk



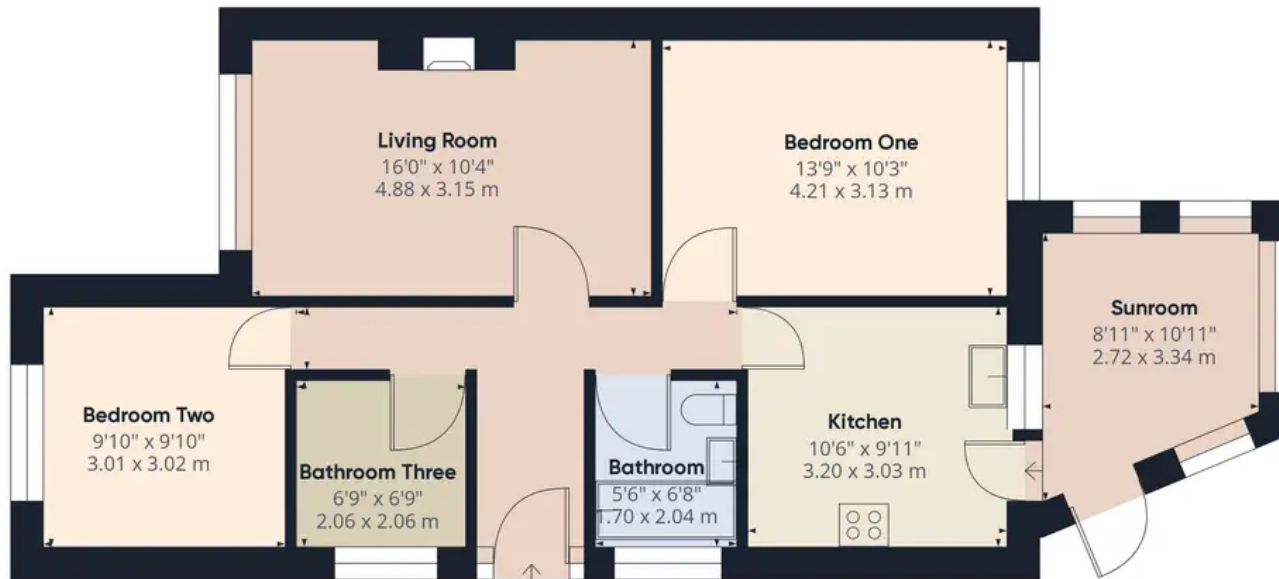

Floor 1 Building 1

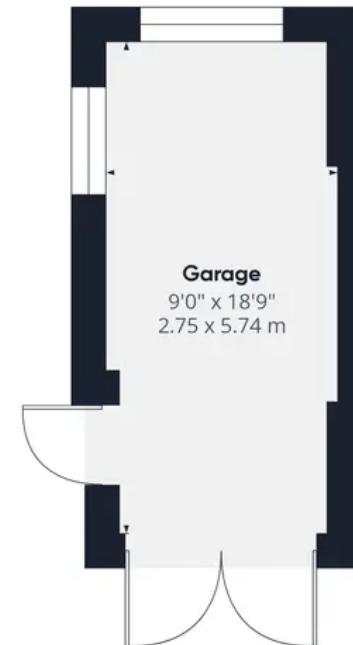

Floor 1 Building 2

Approximate total area⁽¹⁾

938.12 ft²

87.15 m²

(1) Excluding balconies and terraces

While every attempt has been made to ensure accuracy, all measurements are approximate, not to scale. This floor plan is for illustrative purposes only.

GIRAFFE360