

## Coombe Road New Malden KT3



- **One bedroom split level maisonette**
- **Residents Parking**
- **Close to station and High Street**
- **Newly Decorated**

**Price £1,600 pcm**

A good size, split-level apartment located in this very central road. The ground floor comprises a double bedroom with good storage, a bathroom and upstairs there is a large living room with an open kitchen and there is also residents parking. Both the High Street and station are just a short walk away and there are excellent schools close by. The property is part-furnished and available now. Security deposit £1,846 (based on the asking price). Council tax band C. EPC rating D.

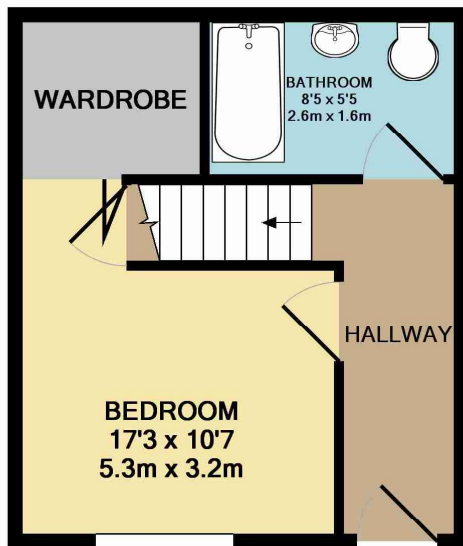

GROUND FLOOR  
APPROX. FLOOR  
AREA 252 SQ.FT.  
(23.4 SQ.M.)

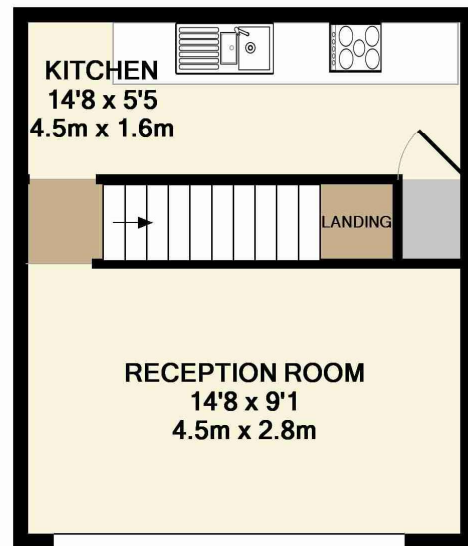

1ST FLOOR  
APPROX. FLOOR  
AREA 253 SQ.FT.  
(23.5 SQ.M.)

TOTAL APPROX. FLOOR AREA 504 SQ.FT. (46.9 SQ.M.)

Whilst every attempt has been made to ensure the accuracy of the floor plan contained here, measurements of doors, windows, rooms and any other items are approximate and no responsibility is taken for any error, omission, or mis-statement. This plan is for illustrative purposes only and should be used as such by any prospective purchaser. The services, systems and appliances shown have not been tested and no guarantee as to their operability or efficiency can be given

Made with Metropix ©2015





