

Salisbury Road New Malden KT3



- **Victorian Cottage**
- **Two Double Bedrooms**
- **Private Garden**
- **Viewings Highly Recommended!**

Price £2,300 pcm

Full of character and charm is this beautiful two bedroom Victorian cottage, set in the Groves area of New Malden. Ideal for a family or professional sharers, the property comprises two good sized double bedrooms, two reception rooms, a large first floor bathroom, fitted kitchen and a private west facing rear garden. Both the High Street and station are within easy reach and there are excellent schools close by. Viewings are highly recommended! The property is unfurnished and available mid-late July. EPC rating E. Council tax band D. Security deposit £2,653 (based on the asking price).

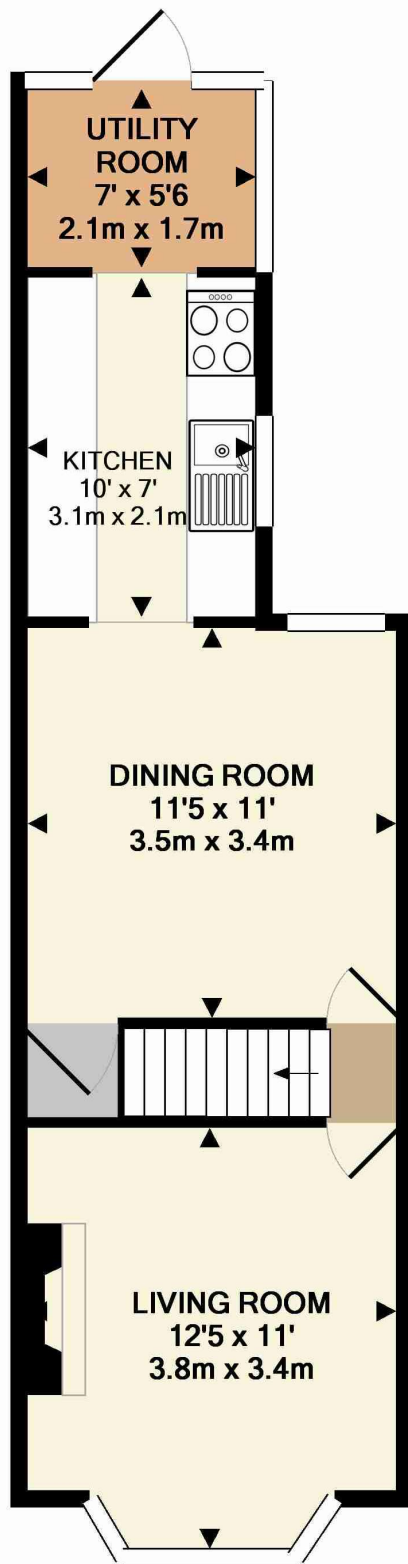

GROUND FLOOR
APPROX. FLOOR
AREA 395 SQ.FT.
(36.6 SQ.M.)

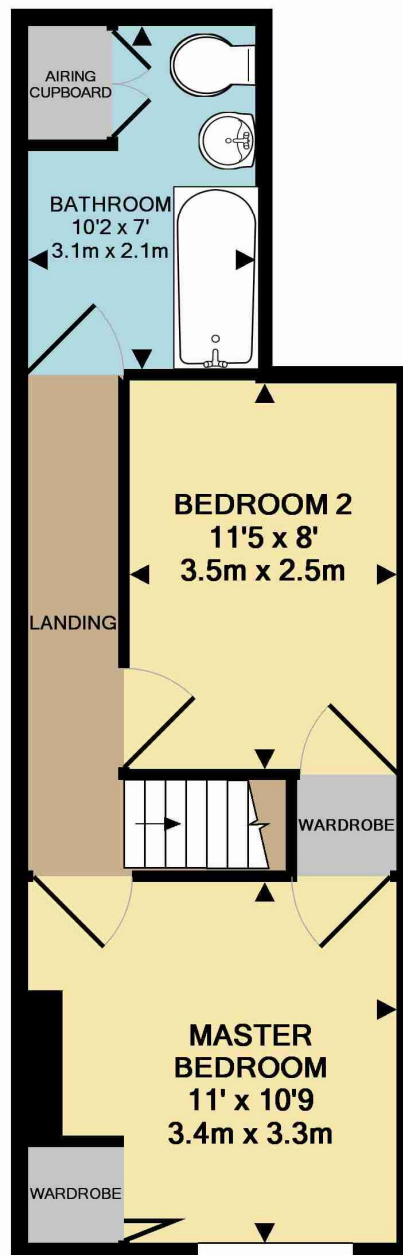

1ST FLOOR
APPROX. FLOOR
AREA 342 SQ.FT.
(31.8 SQ.M.)

TOTAL APPROX. FLOOR AREA 737 SQ.FT. (68.4 SQ.M.)

Whilst every attempt has been made to ensure the accuracy of the floor plan contained here, measurements of doors, windows, rooms and any other items are approximate and no responsibility is taken for any error, omission, or mis-statement. This plan is for illustrative purposes only and should be used as such by any prospective purchaser. The services, systems and appliances shown have not been tested and no guarantee as to their operability or efficiency can be given

Made with Metropix ©2016



