

Fleetwood Road Kingston Upon Thames KT1



- **Three Bedroom House**
- **Parking for Two Cars**
- **Lovely Rear Garden**
- **Kitchen/Breakfast Room**
- **Cul de Sac Location**
- **Available Now**

Price £2,250 pcm

Located at the end of this cul de sac, an end of terrace house which is neutrally presented throughout. The ground floor comprises a living room at the front, a kitchen/breakfast room to the rear as well as a shower room and upstairs there are three bedrooms and a second shower room; the property also has parking to the front for two cars and a lovely rear garden. Located within close proximity of both Kingston and New Malden as well as schools and transport links. The property is available either furnished or unfurnished and available now. Security deposit £2,596 (based on the asking price). Council tax band C. EPC rating D.

GROUND FLOOR

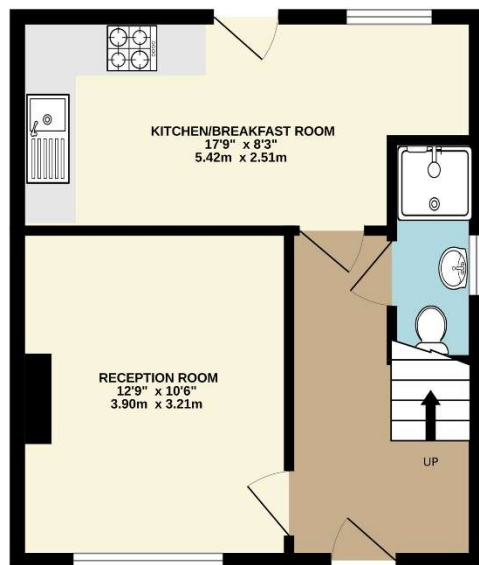

1ST FLOOR

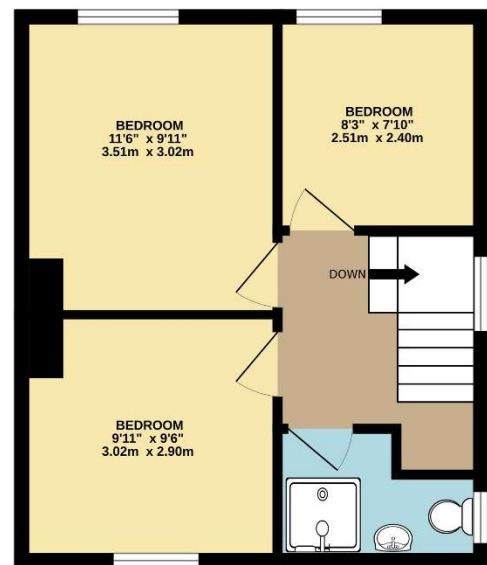

TOTAL FLOOR AREA : 738 sq.ft. (68.6 sq.m.) approx.

Whilst every attempt has been made to ensure the accuracy of the floorplan contained here, measurements of doors, windows, rooms and any other items are approximate and no responsibility is taken for any error, omission or mis-statement. This plan is for illustrative purposes only and should be used as such by any prospective purchaser. The services, systems and appliances shown have not been tested and no guarantee as to their operability or efficiency can be given.

Made with Metropix ©2025



