

## High Street New Malden KT3



- **Central New Malden Location**
- **Stunning New Build Apartment**
- **Large Living Room & Kitchen**
- **Wonderful Terrace with Great Views**
- **Double Bedroom. Modern Bathroom**

### **Price £1,995 pcm**

Set in the heart of New Malden, a top (4th) floor apartment set in this new development. The stunning accommodation comprises a large living room which opens into the kitchen and has access to a wonderful terrace offering superb, panoramic views; there is also a very large double bedroom which has a walk-in wardrobe area, a modern bathroom plus good storage and there is underfloor heating throughout plus a lift to all floors. New Malden station is moments away, giving quick and easy access into central London, Canary Wharf and the City and there are excellent bus and road links to many of the local amenities including Richmond Park, Wimbledon Common as well as Heathrow Airport. The property is furnished and available now. EPC rating B. Council tax band C. Security deposit £2,301 (based on the asking price).

TOP (4TH) FLOOR

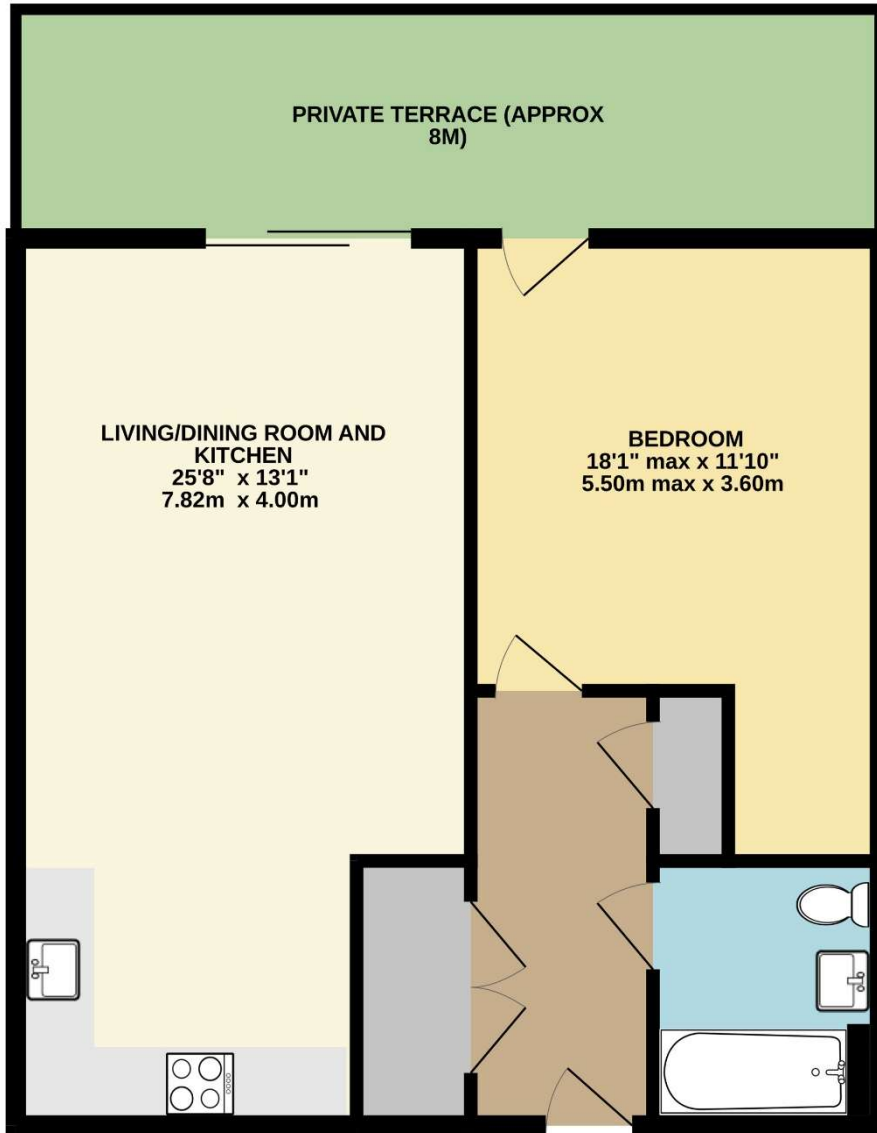

TOTAL FLOOR AREA : 645sq.ft. (59.9 sq.m.) approx.

Whilst every attempt has been made to ensure the accuracy of the floorplan contained here, measurements of doors, windows, rooms and any other items are approximate and no responsibility is taken for any error, omission or mis-statement. This plan is for illustrative purposes only and should be used as such by any prospective purchaser. The services, systems and appliances shown have not been tested and no guarantee as to their operability or efficiency can be given.  
Made with Metropix ©2024



