

Westbury Road New Malden KT3



- **Detached Four Bedroom Period House**
- **Two Large Receptions with High Ceilings**
- **Many Period Features**
- **Potential to Extend (STPP)**
- **South West Facing Garden**
- **Easy Walking Distance to New Malden**

Price £820,000

An opportunity to acquire a spacious detached period house with many original features, situated in a popular part of New Malden within easy walking distance of New Malden High Street. The property requires complete renovation and comprises two large reception rooms both with high ceilings, the front reception has a pretty bay window and original fireplace, the second reception has double doors directly onto the south west facing garden. There is a further reception room on this floor leading into a kitchen with side door to the garden and bathroom. On the first floor there are three double bedrooms, a study/single bedroom and family bathroom with separate w.c. In addition there is a large loft space. Located in the catchment for excellent schools and good transport links this property is ideal for someone wanting to put their own stamp on it. N.B It is currently set up with access to the first floor via a separate entrance although this could easily be altered. No onward chain. EPC D.







GROUND FLOOR

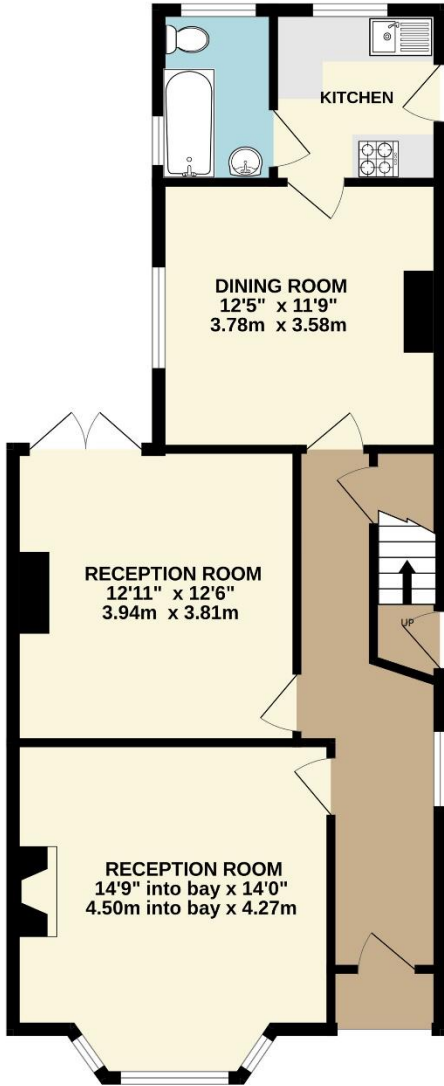

1ST FLOOR

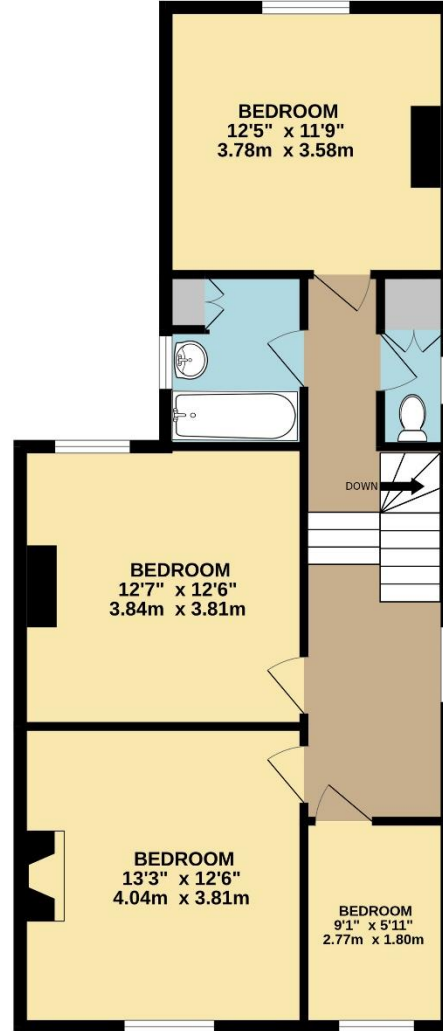

TOTAL FLOOR AREA: 1502sq.ft. (139.5 sq.m.) approx.

Whilst every attempt has been made to ensure the accuracy of the floorplan contained here, measurements of doors, windows, rooms and any other items are approximate and no responsibility is taken for any error, omission or mis-statement. This plan is for illustrative purposes only and should be used as such by any prospective purchaser. The services, systems and appliances shown have not been tested and no guarantee as to their operability or efficiency can be given.

Made with Metropix ©2024