

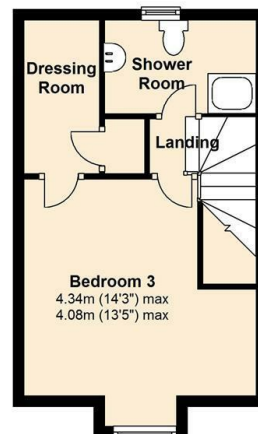

26 Myrtle Way, Brough, HU15 1SR

£995

- Modern Three-Storey Town House
- Two Bath/Shower Rooms & WC
- Available Beginning of May
- Beautifully Presented & Spacious
- Garden, Garage & Off Street Parking
- Three Double Bedrooms
- Unfurnished

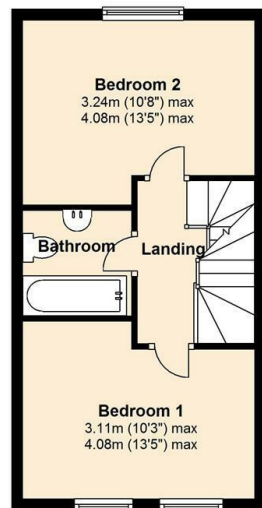
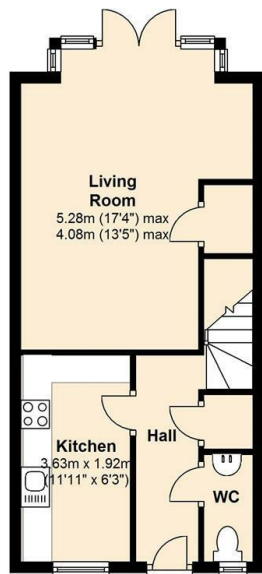

Total area: approx. 93.8 sq. metres (1009.7 sq. feet)

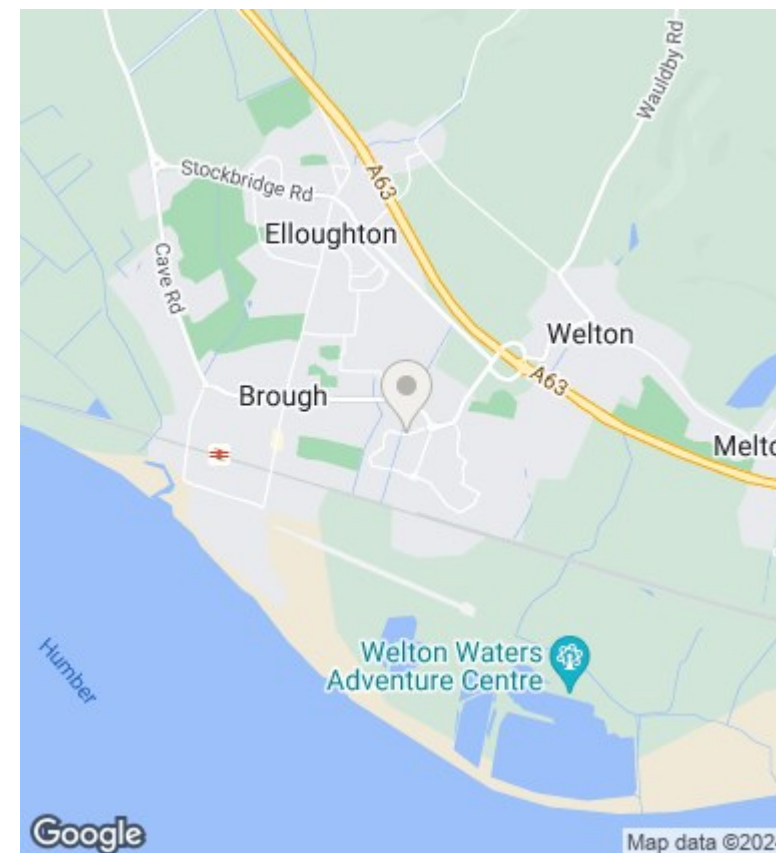

Directions

Viewings

Viewings by arrangement only. Call 01482 307007 to make an appointment.

Council Tax Band

B

EPC Rating:

C

Energy Efficiency Rating		Current	Potential
<i>Very energy efficient - lower running costs</i>			
(92 plus) A			
(81-91) B		75	86
(69-80) C			
(55-68) D			
(39-54) E			
(21-38) F			
(1-20) G			
<i>Not energy efficient - higher running costs</i>			
England & Wales		EU Directive 2002/91/EC	