



PER MONTH

£2,450 Per Month

Bastwick Street

London, EC1V 3PN

Stunning one bedroom property has contemporary finishes and a private balcony that is accessible from both the bedroom and the living room.

Tastefully fully furnished this apartment is ready for you to move straight in, just remember your toothbrush!

The desirable location is prime, with a short stroll to Old Street tube or into Clerkenwell and Shoreditch and all the bars and restaurants the area has to offer.

Suitable for couples or single tenants who are looking for a long let of 12 or ideally 24 months.

Contact us to arrange your viewing.





Bastwick Street, EC1V

Approximate Gross Internal Floor Area : 490 sq ft / 45.5 sq m

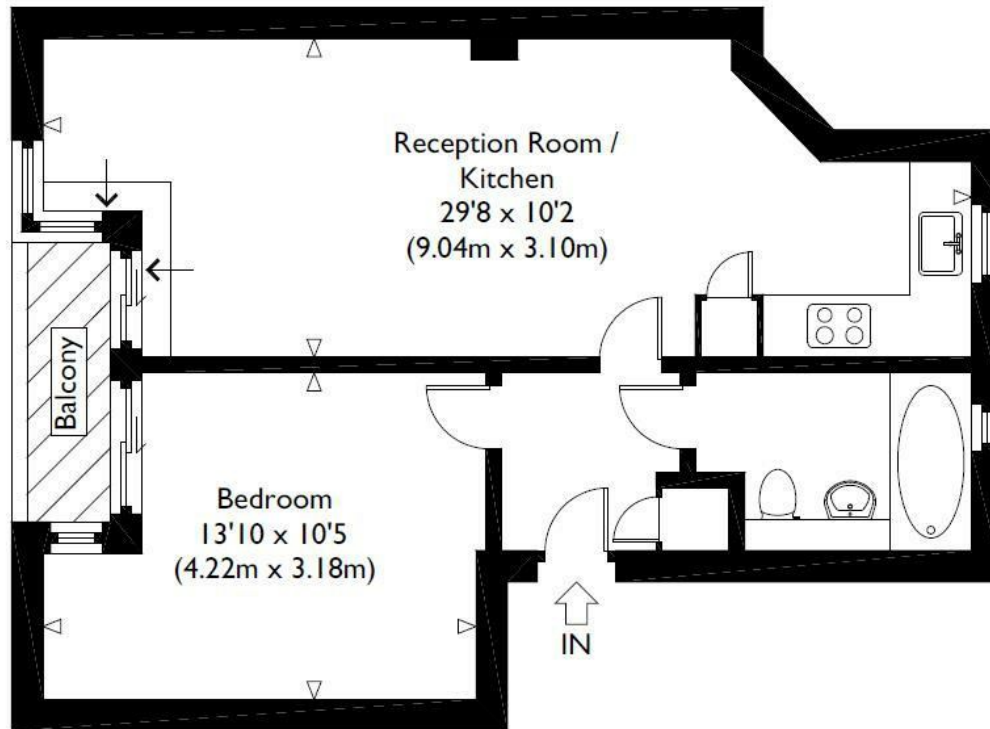

Third Floor

Illustration for identification purposes only, measurements are approximate, not to scale.

Energy Efficiency Rating		
	Current	Potential
Very energy efficient - lower running costs		
(92 plus) A		
(81-91) B		
(69-80) C	74	75
(55-68) D		
(39-54) E		
(21-38) F		
(1-20) G		
Not energy efficient - higher running costs		
England & Wales	EU Directive 2002/91/EC	

Agents Note: Whilst every care has been taken to prepare these particulars, they are for guidance purposes only. All measurements are approximate and are for general guidance purposes only and whilst every care has been taken to ensure their accuracy, they should not be relied upon and potential buyers/tenants are advised to recheck the measurements

OFFICE ADDRESS

88 Cheshire Street
London
E2 6EH

OFFICE DETAILS

0207 739 6969
info@peachproperties.com
www.peachproperties.com