



Brick Lane, Shoreditch, E1

£2,700 PCM

- 2 Double Bedroom Apartment
- Open Plan Reception Room
- Furnished To A High Standard
- Available 10th September
- Exposed Brickwork
- Modern Kitchen
- Seconds From Shoreditch High Street Station
- Hardwood Flooring
- High End Design
- Short Walk To Liverpool Street Station

GROUND FLOOR
713 sq.ft. (66.3 sq.m.) approx.

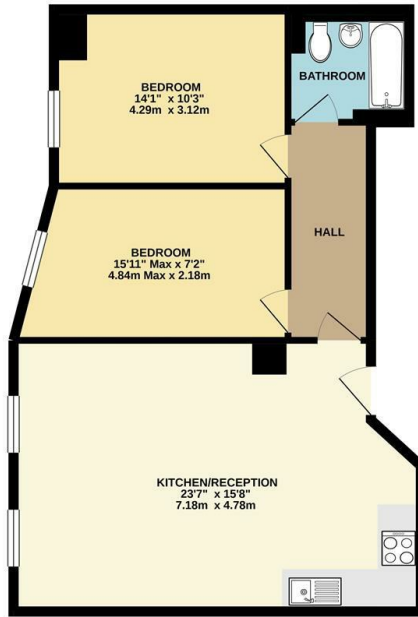

TOTAL FLOOR AREA: 713 sq ft. (66.3 sq.m.) approx.
Whilst every attempt has been made to ensure the accuracy of the floorplan contained herein, measurements of doors, windows, rooms and any other items are approximate and no responsibility is taken for any error, omission or mis-statement. This plan is for illustrative purposes only and should be used as a guide by any prospective purchaser. The services, systems and appliances shown have not been tested and no guarantee as to their operability or efficiency can be given. Made with Metropex (2020)

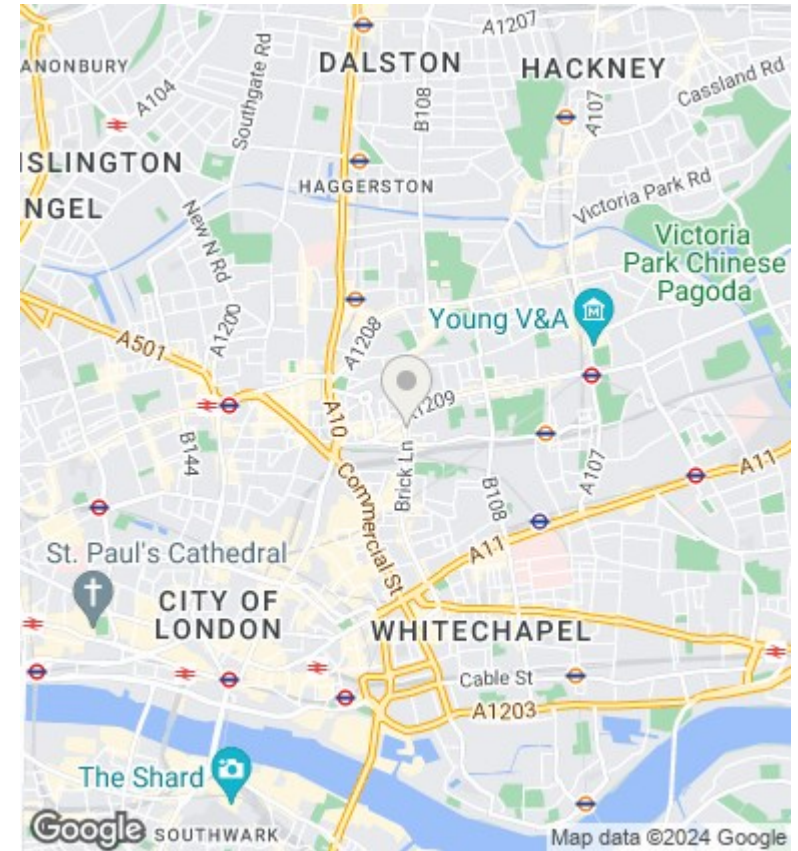

Directions

Viewings

Viewings by arrangement only. Call 0207 739 6969 to make an appointment.

Council Tax Band

D

EPC Rating:

C

Energy Efficiency Rating		Current	Potential
<i>Very energy efficient - lower running costs</i>			
(92 plus) A			
(81-91) B		75	79
(69-80) C			
(55-68) D			
(39-54) E			
(21-38) F			
(1-20) G			
<i>Not energy efficient - higher running costs</i>			
England & Wales		EU Directive 2002/91/EC	