



The Cloisters, Commercial Street, Shoreditch, E1

£2,400 PCM

- 2 Double Bedroom Apartment
- Concierge Service
- New Bathroom
- Available March
- 3rd Floor
- Completely Renovated In 2022
- Wood Flooring
- Lift Facility
- New Kitchen
- Large Reception Room

The Cloisters, Commercial Street, E1 6EB

Approx. Gross Internal Area = 57.1 sq m / 614 sq ft

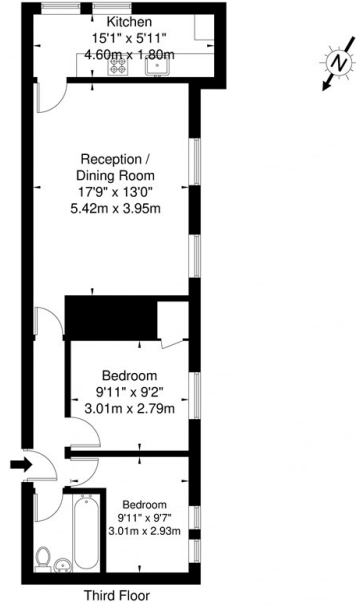

Ref

Copyright

**BLEU
PLAN**

The Floor plan is not to scale and measurements and areas shown are approximate and therefore should be used for illustrative purposes only. The plan has been prepared in accordance with the RICS code of Measuring Practice and whilst we have confidence in the information produced it must not be relied on. If there is any aspect of particular importance, you should carry out or commission your own inspection of the property.
Copyright © BLEUPLAN

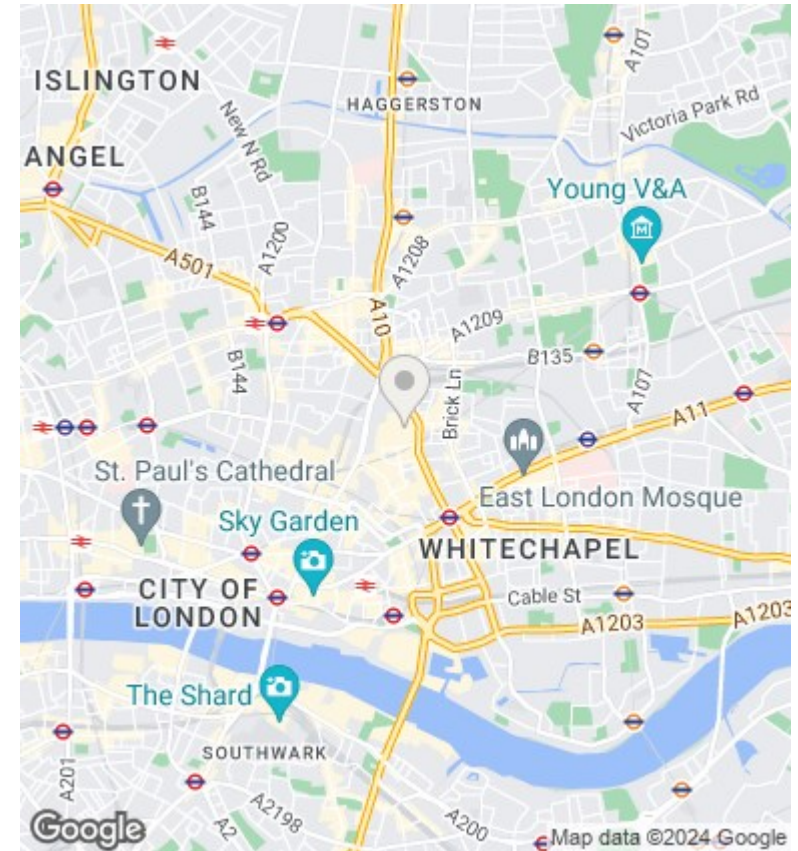

Directions

Viewings

Viewings by arrangement only. Call 0207 739 6969 to make an appointment.

Council Tax Band

B

EPC Rating:

C

Energy Efficiency Rating		Current	Potential
<i>Very energy efficient - lower running costs</i>			
(92 plus) A			
(81-91) B			
(69-80) C		70	80
(55-68) D			
(39-54) E			
(21-38) F			
(1-20) G			
<i>Not energy efficient - higher running costs</i>			
England & Wales		EU Directive 2002/91/EC	