



## Brick Lane, Shoreditch, E1

£3,050 Per Month

- 2 Double Bedroom Apartment
- Private Balcony
- Brand New
- Located On Brick Lane
- 2 Bathrooms

## Brick Lane, E1 6RF

Approx Gross Internal Area = 62.4 sq m / 672 sq ft  
 Balcony = 5.7 sq m / 61 sq ft  
 Total = 68.1 sq m / 733 sq ft

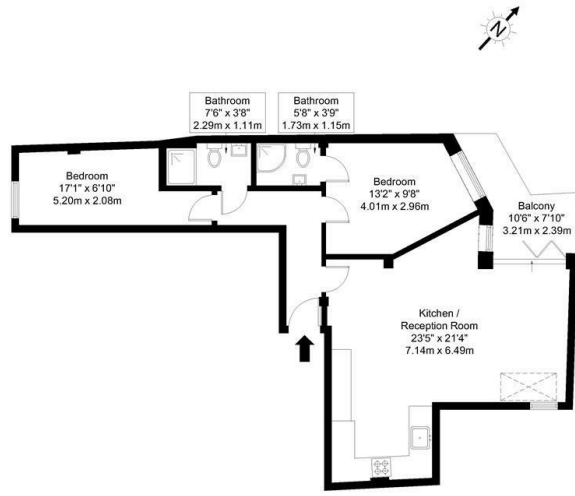

First Floor

Ref:

Copyright **BLEU PLAN**

The Floor plan is not to scale and measurements and areas shown are approximate and therefore should be used for illustrative purposes only. The plan has been prepared in accordance with the RICS code of Measuring Practice and whilst we have confidence in the information produced it must not be relied on. Maximum lengths and widths are represented on the floor plan. If there is any aspect of particular importance, you should carry out or commission your own inspection of the property.

Copyright @ BLEUPLAN

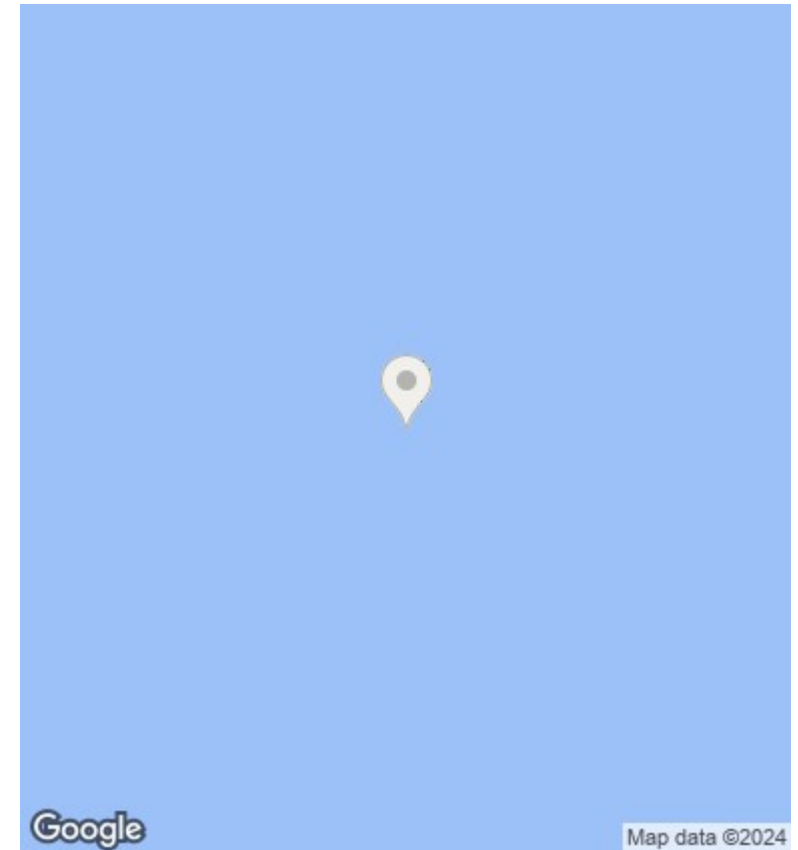

Google

Map data ©2024

## Directions

## Viewings

Viewings by arrangement only. Call 0207 739 6969 to make an appointment.

## Council Tax Band

## EPC Rating:

C

Energy Efficiency Rating		Current	Potential
<i>Very energy efficient - lower running costs</i>			
(92 plus) <b>A</b>			
(81-91) <b>B</b>		78	79
(69-80) <b>C</b>			
(55-68) <b>D</b>			
(39-54) <b>E</b>			
(21-38) <b>F</b>			
(1-20) <b>G</b>			
<i>Not energy efficient - higher running costs</i>			
<b>England &amp; Wales</b>		EU Directive 2002/91/EC	