

## City Tower, Limeharbour, Docklands, E14

£2,400 PCM

- 2 Double Bedroom Apartment
- Secure Parking Space
- Lift Facilities
- Furnished
- 12th Floor
- Private Balcony
- 2 Bathroom
- 24 Hour Concierge
- Wood Flooring
- Available End Of May

## City Tower, Limeharbour, Isle of Dogs, E14 9LS

Approx. Gross Internal Area = 80.1 sq m / 862 sq ft

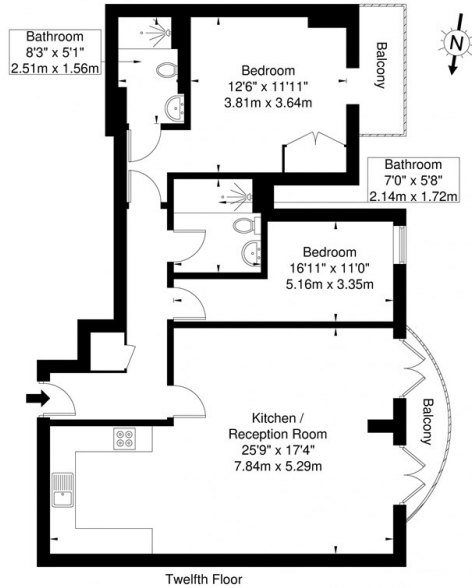

Ref Copyright **BLEU PLAN**

Disclaimer : Floor plan measurements are approximate and are for illustrative purposes only. While we do not doubt the floor plan accuracy and completeness, you or your advisors should conduct a careful, independent investigation of the property in respect of monetary valuation.

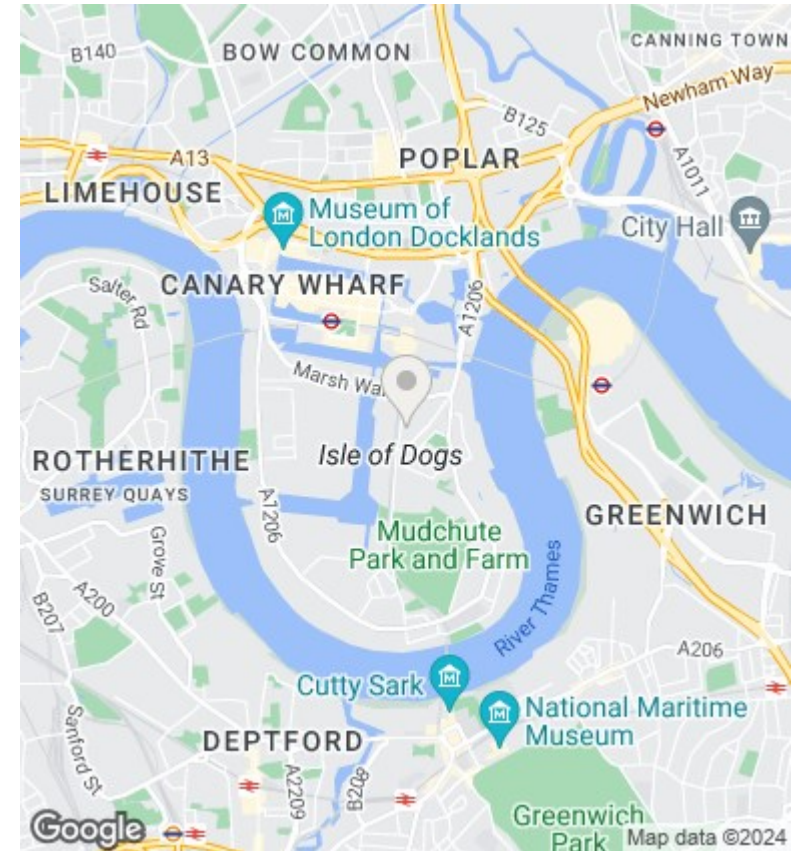

## Directions

## Viewings

Viewings by arrangement only. Call 0207 739 6969 to make an appointment.

## Council Tax Band

E

## EPC Rating:

Energy Efficiency Rating		Current	Potential
<i>Very energy efficient - lower running costs</i>			
(92 plus) <b>A</b>			
(81-91) <b>B</b>			
(69-80) <b>C</b>			
(55-68) <b>D</b>			
(39-54) <b>E</b>			
(21-38) <b>F</b>			
(1-20) <b>G</b>			
<i>Not energy efficient - higher running costs</i>			
<b>England &amp; Wales</b>		EU Directive 2002/91/EC	