



## Spelman House, Spelman Street, Whitechapel, E1

£430,000

- 3 Bedroom Apartment
- Purpose Built Block
- Seconds From Brick Lane
- Chain Free
- 732 Square Feet

# Spelman House, Spelman Street, Whitechapel, E1

3 bedroom apartment over 732 square feet located seconds from Brick Lane.



Council Tax Band: B



Seconds from Brick Lane is this 3 bedroom apartment set within a purpose built block.

The property features a bright reception room, separate fitted kitchen, family bathroom, separate W/C and 3 bedrooms.

Located just a few moments from the Truman Brewery on Brick Lane and a short walk to Spitalfields Market. It's a vibrant and busy part of East London and is particularly popular with 'creatives', making it a really exciting area to buy a property. Shoreditch has evolved over the past twenty years and now boasts a colourful range of bars, restaurants, and independent stores and boutiques with Hoxton Square, Broadway and Columbia Road markets close by.

Transport links include Shoreditch High Street, Liverpool Street and Aldgate East Stations which are all within a short walk.

Offered on a chain free basis.

Leasehold: 90 (approx)

Service Charge: £1,751.27

Ground Rent: £10 per annum

Council Tax: Band B

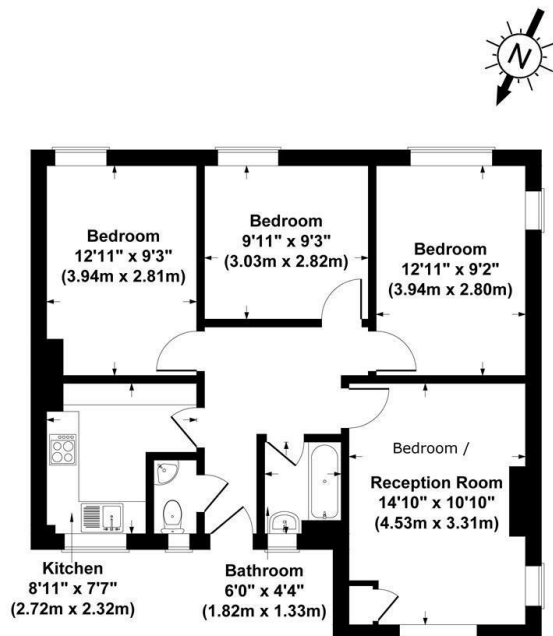

First Floor

Spelman House, London, E1

Gross Internal Area 732 sq ft / 68 sq metres

Not to Scale. Produced by The Plan Portal 2022

For Illustrative Purposes Only.

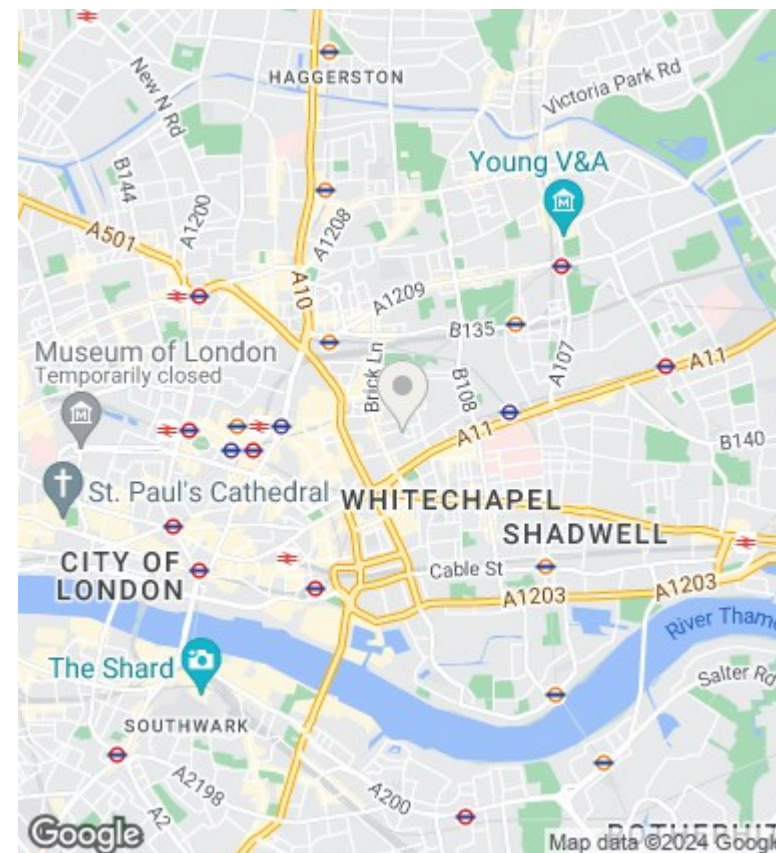

## Directions

## Viewings

Viewings by arrangement only. Call 0207 739 6969 to make an appointment.

## Council Tax Band

B

Energy Efficiency Rating		
	Current	Potential
Very energy efficient - lower running costs		
(92 plus) <b>A</b>		
(81-91) <b>B</b>		
(69-80) <b>C</b>	72	79
(55-68) <b>D</b>		
(39-54) <b>E</b>		
(21-38) <b>F</b>		
(1-20) <b>G</b>		
Not energy efficient - higher running costs		
<b>England &amp; Wales</b>	EU Directive 2002/91/EC	