



Nelson Gardens, Bethnal Green, E2

£399,950

- 1 Bedroom Apartment
- Short Walk To Brick Lane
- 44 Square Meters
- Top Floor (2nd)
- Modern Integrated Kitchen
- Close To Columbia Road Flower Market
- Lots Of Natural Light

Nelson Gardens, Bethnal Green, E2

Beautifully presented 1 bedroom apartment located moments from Columbia Road flower market, Brick Lane and Shoreditch High-Street station.



Council Tax Band: B



Located close to Columbia Road Flower Market is this well presented 1 bedroom apartment.

The apartment is set in the top floor and features a bright and spacious reception room with an abundance of natural light leading onto a contemporary fitted integrated kitchen with quartz worktops. There is a good size double bedroom with fitted wardrobes and stylish bathroom suite.

The apartment is double glazed throughout and has gas central heating.

The property is located just a short walk from Columbia Road Flower Market, Broadway Market and Brick Lane. Transport links include Bethnal Green Underground, Cambridge Heath Mainline and Shoreditch High Street Stations.

Leasehold: 86 years remaining
Service Charge: £1450 per annum
Ground Rent: £10 per annum
Council Tax: Band B

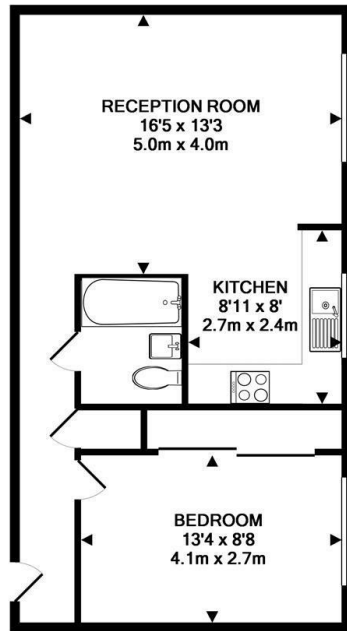

TOTAL APPROX. FLOOR AREA 503 SQ.FT. (46.7 SQ.M.)

Whilst every attempt has been made to ensure the accuracy of the floor plan contained here, measurements of doors, windows, rooms and any other items are approximate and no responsibility is taken for any error, omission, or mis-statement. This plan is for illustrative purposes only and should be used as such by any prospective purchaser. The services, systems and appliances shown have not been tested and no guarantee as to their operability or efficiency can be given
Made with Metropix ©2017

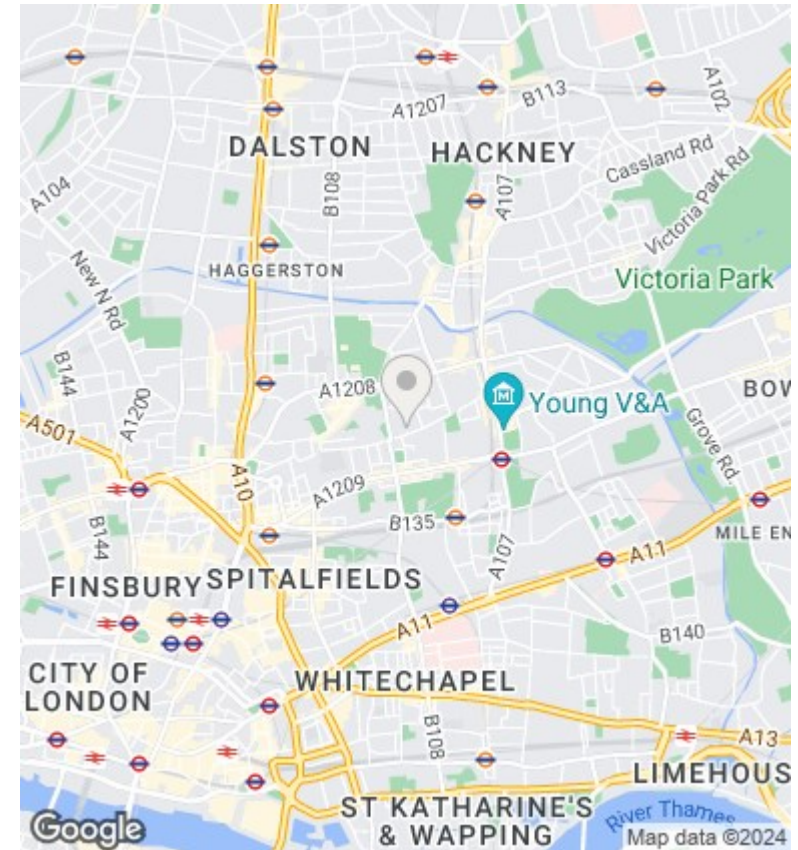

Directions

Viewings

Viewings by arrangement only. Call 0207 739 6969 to make an appointment.

Council Tax Band

B

Energy Efficiency Rating		Current	Potential
<i>Very energy efficient - lower running costs</i>			
(92 plus)	A		
(81-91)	B		
(69-80)	C		
(55-68)	D		
(39-54)	E	47	65
(21-38)	F		
(1-20)	G		
<i>Not energy efficient - higher running costs</i>			
England & Wales		EU Directive 2002/91/EC	