



Blythe Road

Perlethorpe



£144,995

(Chadwells
Estate & Letting Agents





*Relax and Unwind in your very
own luxury Lodge.....Offered For
Sale With No Upward Chain...*





Blythe Road





Welcome

Sherwood Hideaway Lodges will provide you with holidays for many years to come. Sherwood Hideaway is a well established private park in a stunning location. It really is a hidden oasis as you drive down the avenue of trees from the main road, providing secure and secluded accommodation in a peaceful and naturally abundant location. As soon as you enter your lodge, you will feel immediately at peace in the comfort of your own holiday 'home from home'. Time to relax and unwind, enjoy the peace and quiet of the natural tranquil surroundings. Your lodge comes fully furnished with luxury fitted kitchens and bathrooms, low maintenance exterior finishes and high level of heat and sound insulation.

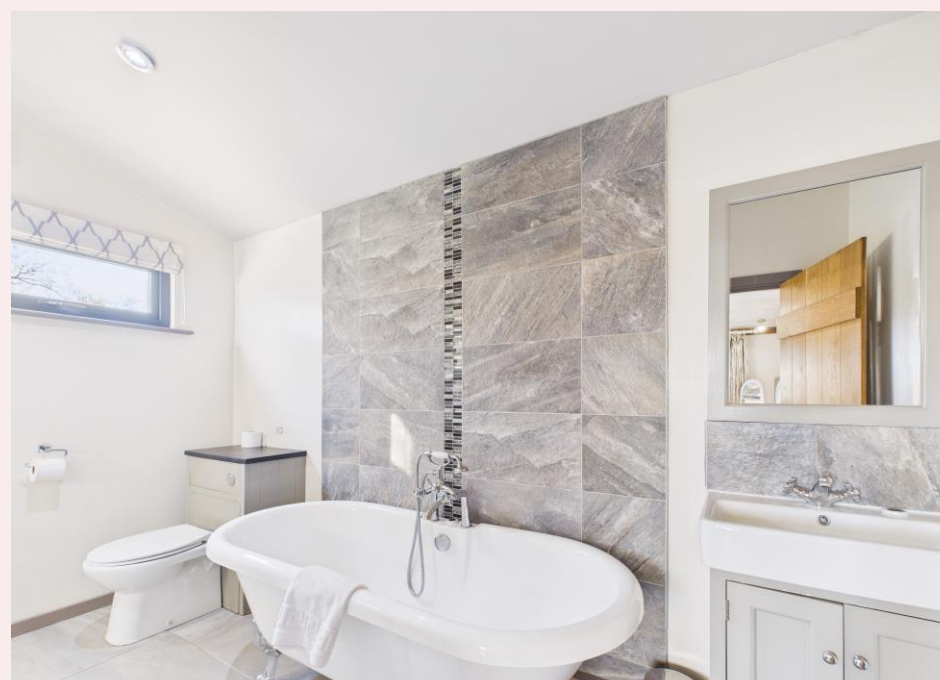

Step inside...

Open Plan Living *17' 0" x 19' 7" (5.18m x 5.96m)*

Kitchen area is fitted with a range of hi-spec base units, solid oak worktops with one and stainless steel sink, drainer and mixer tap. range of integrated electric appliances including, fridge freezer, oven and hob, together with plenty of space for the family dining table and chairs. Living room area comes complete with sofa, arm chairs, cabinet and electric fire with the additional benefit of French doors which lead out to your decking area. To complete the look there are curtains, light fittings, blinds and oak flooring throughout this area.

Master bedroom *11' 7" x 9' 4" (3.53m x 2.84m)*

With laminate flooring, radiator, high spec wardrobe, matching bedside cabinets, ceiling lights, windows and french doors to rear aspect, door leading to the en-suite bathroom.

Bathroom/En-suite *11' 6" x 5' 9" (3.50m x 1.75m)*

Full size oval bath, separate walk-in shower unit, wash basin with vanity surround and low flush w/c. Tiled flooring, ceiling spot lights, obscure window and stainless steel ladder radiator.

Externally

Private decking to the rear of the property overlooking the forest. Allocated parking with additional visitor parking available.

Additional Information

Services Non Residential Dwelling Limited to 11 months per year. LPG gas fired boiler serving the radiators and hot water. LPG metered Gas. Metered mains electricity. Metered mains and private water.

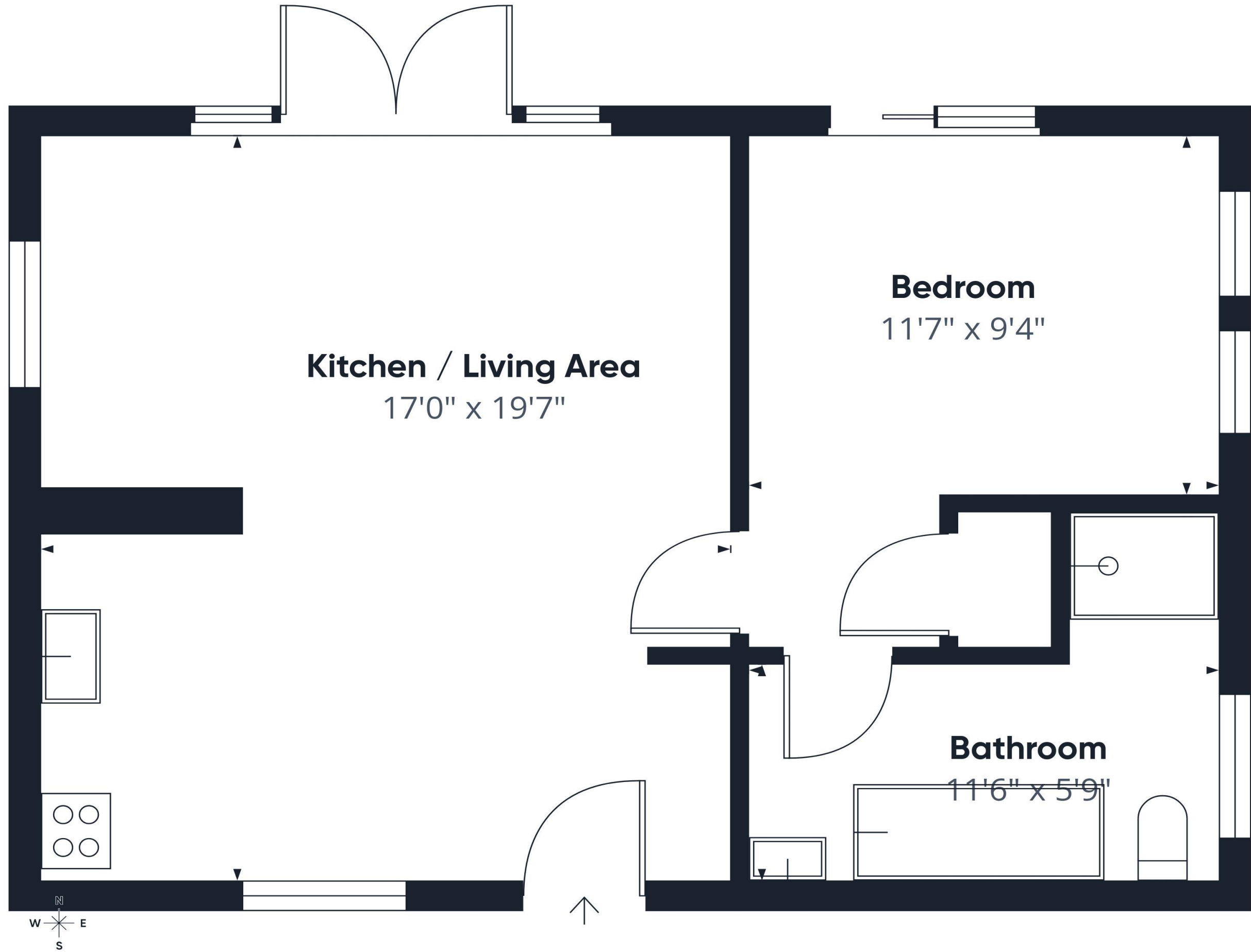

Approximate total area⁽¹⁾
555 ft²

(1) Excluding balconies and terraces

Calculations reference the RICS IPMS 3C standard. Measurements are approximate and not to scale. This floor plan is intended for illustration only.

GIRAFFE360



Selling Homes with Bespoke Lifestyle Photography

Chadwells
Estate & Letting Agents

If you'd like to view this amazing
property, give us a call.

We'd Love To Show You Around!

Telephone: 01623 861 861

 **Chadwells**
Estate & Letting Agents