



King Street

NR1 1QE

- Prime city center location
- Three storey townhouse
- Garage & enclosed garden
- Open plan ground floor living space

£425,000

reality





DIRECTIONS

Leave Norwich City Centre, heading south on Rouen Road, and take the turning left into Music House Lane. At the T-junction turn left onto king street and continue along. The property will be found on the left hand side, shortly after the café.

PROPERTY SUMMARY

STAND TALL... This three storey townhouse, built by Hopkins Homes, has an attractive façade and is a popular part of the historic city centre. The generous accommodation features four bedrooms (master en-suite), a family bathroom, plus a cloakroom, along with an open plan kitchen/family dining room on the ground floor, which opens onto a low maintenance courtyard garden to the rear. There is also a formal sitting room on the first floor. The windows to the front are all triple glazed, for acoustic benefit and the property is warmed via a gas fired central heating system.



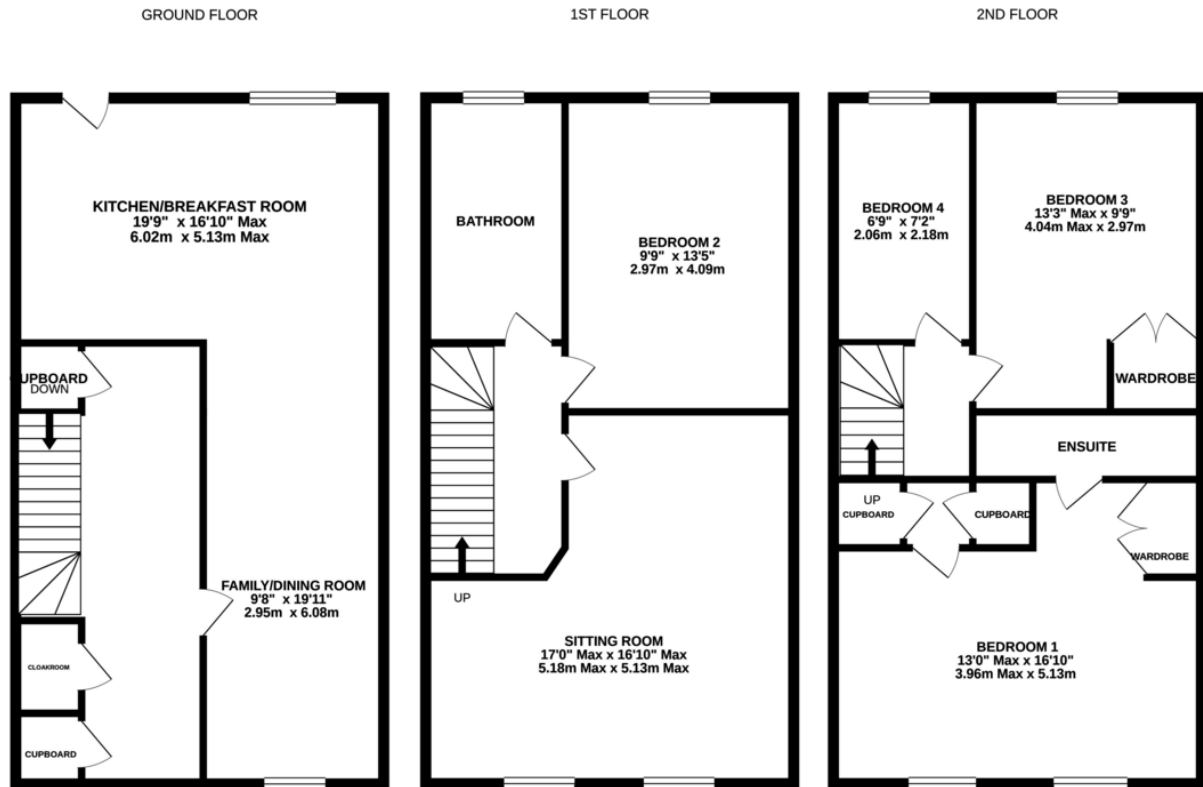

Whilst every attempt has been made to ensure the accuracy of the floorplan contained here, measurements of doors, windows, rooms and any other items are approximate and no responsibility is taken for any error, omission or mis-statement. This plan is for illustrative purposes only and should be used as such by any prospective purchaser. The services, systems and appliances shown have not been tested and no guarantee as to their operability or efficiency can be given.
Made with Metropix ©2020

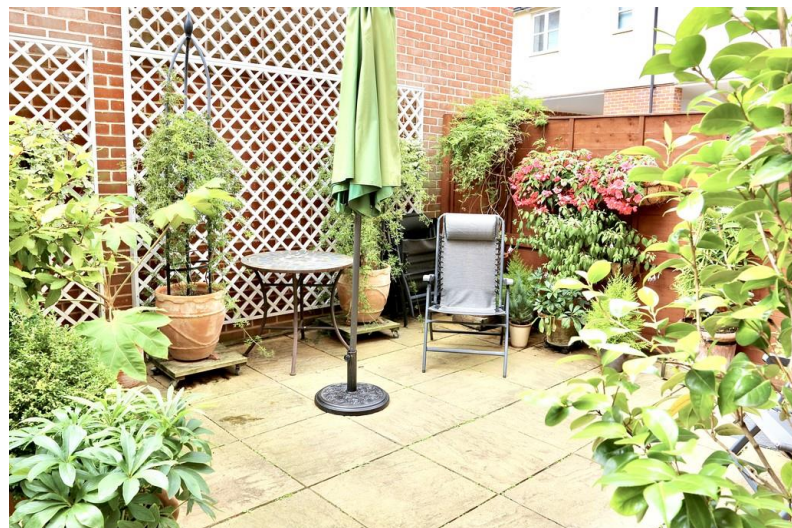



**SELLING PROPERTIES
SINCE 2009**

"Hi Lucy – we just wanted to say thank you to you and your team for all you did to make the purchase of our home run smoothly."

Mr and Mrs Oliveri, February 2019

"Thank you for everything you, Adam and the rest of your staff have done in the process of us purchasing our new home. Reality has been brilliant in every possible way. I would confidently recommend Reality to any friends that were moving, and definitely use you again."

Mr D Joseph, November 2018

"We are in no doubt that without your support, guidance and determination, we would not have reached this point. You have gone the extra mile to make sure that this would all work out. You have always been available for a chat when we needed reassurance, and have been happy to spend time hounding buyers and solicitors on our behalf. We truly appreciate what you have done for us and are extremely grateful."

Mr and Mrs Knight, November 2018

Notes on Sale: These particulars are believed to be accurate but no guarantee of their accuracy can be made. These particulars do not form part of any contract.



01603 756898

65 Grove Road, Norwich, NR1 3RL
contact@realityestateagents.co.uk

 /Reality Estate Agents

 @realitynorwich

www.realityestateagents.co.uk



Reality directors Lucy Carne and Adam Thompson
with TV's property guru, Phil Spencer

Minimum fee and contract applies - terms and conditions of your current agent must be adhered to