



Wingfield Road, Norwich, NR3 3HF

Offers In Excess Of £210,000

- IDEAL FIRST TIME BUY
- SITTING ROOM
- FITTED KITCHEN
- GAS CENTRAL HEATING
- NON-BISECTED REAR GARDEN
- 3 BEDROOMS (3RD OFF SECOND)
- DINING ROOM
- GROUND FLOOR BATHROOM
- UPVC DOUBLE GLAZED WINDOWS
- NO ONWARD CHAIN

Wingfield Road, Norwich, NR3 3HF

NO ONWARD CHAIN...

Presented without any chain, this charming mid-terrace property showcases delightful original features and three bedrooms. Nestled on a one-way street with permit parking, in the coveted north city area and just a short distance from city centre amenities, this home offers a perfect blend of connectivity and tranquillity. The high ceilings contribute to a spacious ambiance. Ideal for first-time buyers given its ample space and size, the property also provides room for creative personalisation to make it uniquely yours.

Council Tax Band - B



GROUND FLOOR

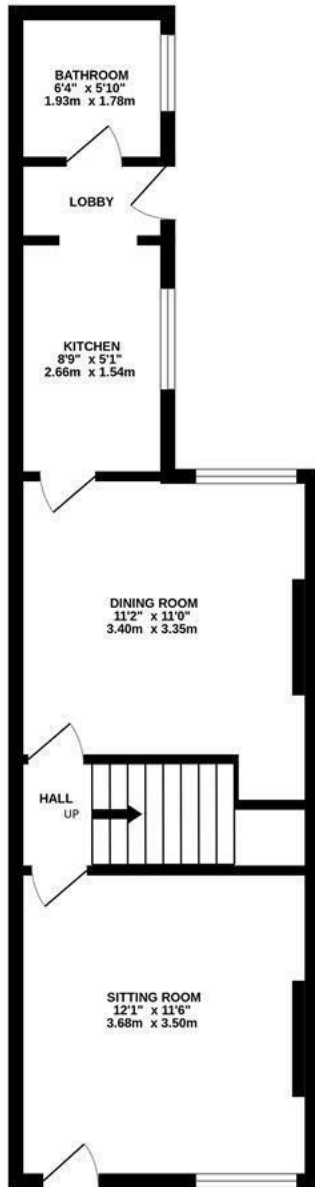

1ST FLOOR

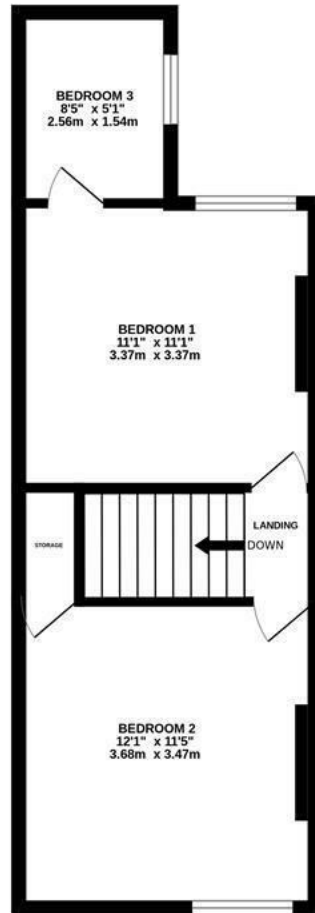

Whilst every attempt has been made to ensure the accuracy of the floorplan contained here, measurements of doors, windows, rooms and any other items are approximate and no responsibility is taken for any error, omission or mis-statement. This plan is for illustrative purposes only and should be used as such by any prospective purchaser. The services, systems and appliances shown have not been tested and no guarantee as to their operability or efficiency can be given.
Made with Metropix ©2024

Energy Efficiency Rating

	Current	Potential
<i>Very energy efficient - lower running costs</i>		
(92 plus) A		83
(81-91) B		
(69-80) C		
(55-68) D	65	
(39-54) E		
(21-38) F		
(1-20) G		
<i>Not energy efficient - higher running costs</i>		
England & Wales	EU Directive 2002/91/EC	

