



## Lake View, Haveringland, Norwich, NR10 4PN

£72,000

- TWO BEDROOM HOLIDAY LODGE
- 12 MONTH OPEN LEISURE PARK
- OPEN PLAN SITTING/DINING/KITCHEN
- DOUBLE GLAZING
- DECKED TERRACE
- APPROXIMATELY SIX YEARS OLD
- BATHROOM & EN SUITE SHOWER ROOM
- LPG GAS CENTRAL HEATING
- PARKING
- FAMILY AND PET FRIENDLY PARK

# Lake View, Haveringland, Norwich, NR10 4PN

27 lake View is a two bedroom holiday lodge within Haveringland Hall Country Park. As a holiday home, you have unlimited usage, providing you have proof of owning another residence. The lodge which is approximately six years old has many upgrades and comes with double glazing, LPG gas central heating, a lockable shed and parking space. The accommodation consists of an open plan sitting/dining kitchen, inner hall, two bedrooms, a bathroom and en suite shower room. The lodge is being sold as seen, with all furniture etc. Haveringland Hall Country Park is a family park, where pets and children are welcome.

AGENTS NOTE: The Tenure stated as Freehold is incorrect. As it is a moveable structure, there is no tenure applicable. Owners pay an annual fee of £4200 (2023), on a yearly rolling contract.

Council Tax Band -



GROUND FLOOR

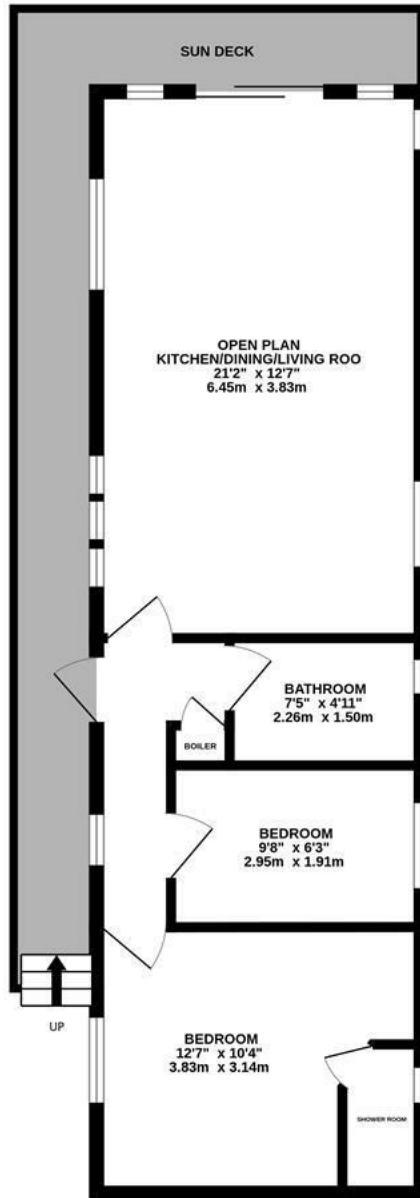

Whilst every attempt has been made to ensure the accuracy of the floorplan contained here, measurements of doors, windows, rooms and any other items are approximate and no responsibility is taken for any error, omission or mis-statement. This plan is for illustrative purposes only and should be used as such by any prospective purchaser. The services, systems and appliances shown have not been tested and no guarantee as to their operability or efficiency can be given.  
Made with Metropix ©2023



