



Flordon Road

Tasburgh

NR15 1LU

- SUNSTANTIAL DETACHED BUNGALOW
- SET A PLOT MEASURING 2.11 ACRE (STMS)
- 4 BEDROOMS (MASTER EN SUITE)
- NO ONWARD CHAIN

Offers In Excess Of £500,000

reality





PROPERTY SUMMARY

LAUNCHING ON SATURDAY 17TH JULY...

NO ONWARD CHAIN* Set on a mature plot measuring 2.11 acres (stms) on the edge of the village, this substantial detached bungalow is one not to be missed! The generous accommodation consists of a wide, welcoming entrance hall, dual aspect sitting room with an open fire, dining room, a large kitchen/breakfast room, utility, cloakroom, family bathroom, four bedrooms (three are doubles) and a re-fitted en suite off the master. Adjoining the property is a double garage, which has been partly converted into a games room, with plastered walls, flooring and radiators. This could be turned into an annex if required. The property has the advantage of oil central heating, with the boiler only being replaced around six months ago, double glazed windows, newly fitted carpets, a large carport, ample parking and outbuildings.



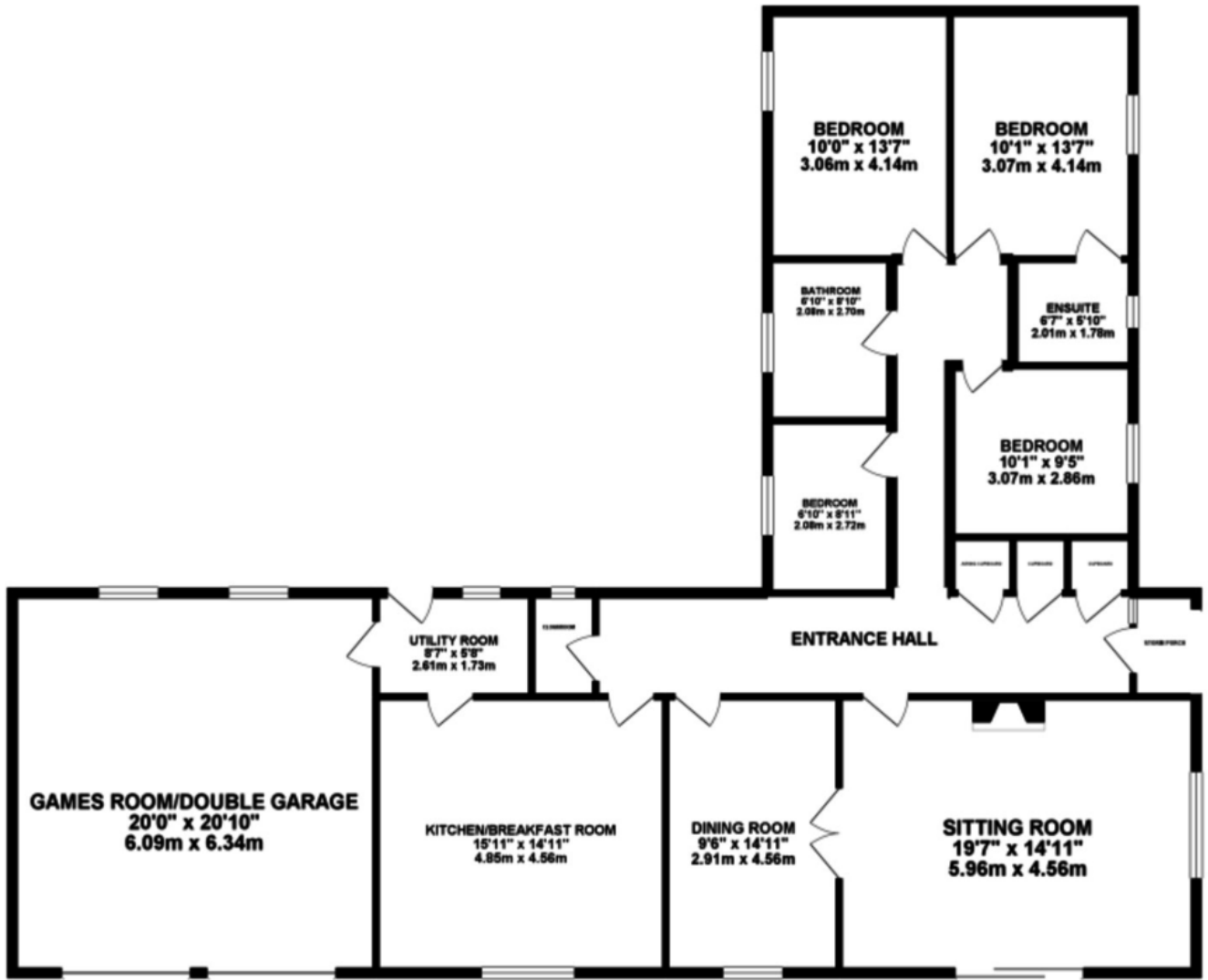

Whilst every attempt has been made to ensure the accuracy of the floorplan contained here, measurements of doors, windows, rooms and any other items are approximate and no responsibility is taken for any error, omission or mis-statement. This plan is for illustrative purposes only and should be used as such by any prospective purchaser. The services, systems and appliances shown have not been tested and no guarantee as to their operability or efficiency can be given.
Made with Hefupix ©2021

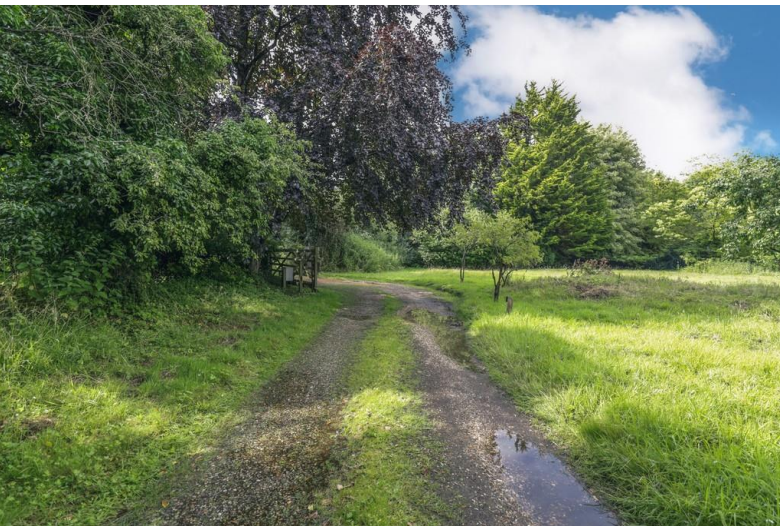



Notes on Sale: These particulars are believed to be accurate, but no guarantee of their accuracy can be made. These particulars do not form part of any contract.



01603 756898

65 Grove Road, Norwich, NR1 3RL
contact@realityestateagents.co.uk