



**City Road
Norwich
NR1 3AS**

- IMPOSING EDWARDIAN HOME
- THREE DOUBLE BEDROOM (MASTER EN SUITE)
- NO ONWARD CHAIN
- WALKING DISTANCE OF THE CITY CENTRE

Offers In Excess Of £450,000

reality





PROPERTY SUMMARY

EDWARDIAN ELEGANCE...

This is an imposing character home, which has been extended and renovated by the current owners. Located within walking distance of the the city centre and its array of amenities, this property offers spacious and versatile accommodation over two floors, including a welcoming entrance hall, bay fronted sitting room, study, utility room, handmade fitted kitchen/breakfast room and a stunning dining/garden room on the ground floor. This is complimented by three double bedrooms, an en suite off the master, and a four piece family bathroom upstairs. Outside there is an enclosed courtyard style garden and access into a large workshop/home office, which has power, lighting and heating along with a WC and rear access.



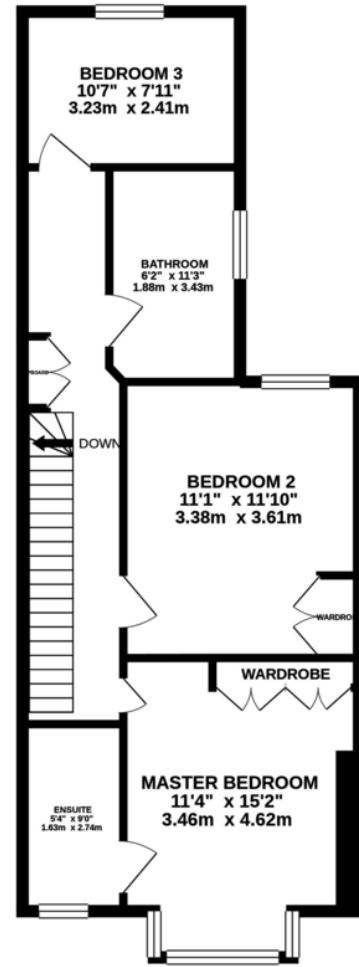
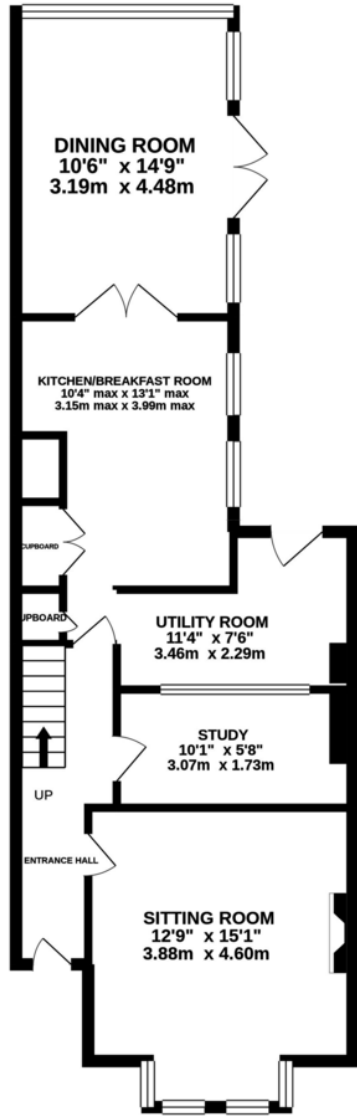



Notes on Sale: These particulars are believed to be accurate, but no guarantee of their accuracy can be made. These particulars do not form part of any contract.



01603 756898

65 Grove Road, Norwich, NR1 3RL
contact@realityestateagents.co.uk