



### Parliament Hill, London NW3

**£445 Per Week**

Compton Reeback are delighted to offer this bright one bedroom top floor apartment situated in a well maintained period conversion, comprising built-in- wardrobes, good storage space, kitchen with modern appliances, large windows with beautiful panoramic landscaped garden views and neutral décor throughout. Situated in one of the most desirable leafy parts of Hampstead, just moments away from the beautiful Heath, Hampstead Overground Station and local amenities. The property is offered on a furnished basis and available mid June. EPC Rating D. Council Tax Band D.

# Parliament Hill, London NW3

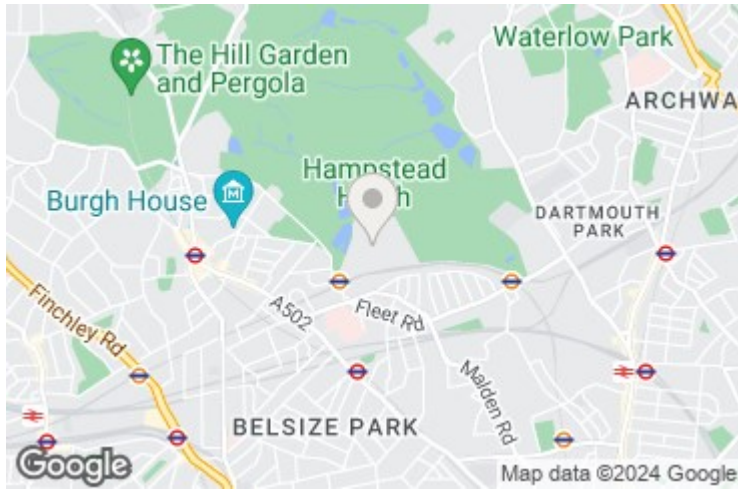

Energy Efficiency Rating		Current	Potential
Very energy efficient - lower running costs			
(92 plus) A			
(81-91) B			
(69-80) C			
(55-68) D			
(39-54) E			
(21-38) F			
(1-20) G			
Not energy efficient - higher running costs			
<b>England &amp; Wales</b>	EU Directive 2002/91/EC	67	74

Environmental Impact (CO <sub>2</sub> ) Rating		Current	Potential
Very environmentally friendly - lower CO <sub>2</sub> emissions			
(92 plus) A			
(81-91) B			
(69-80) C			
(55-68) D			
(39-54) E			
(21-38) F			
(1-20) G			
Not environmentally friendly - higher CO <sub>2</sub> emissions			
<b>England &amp; Wales</b>	EU Directive 2002/91/EC		

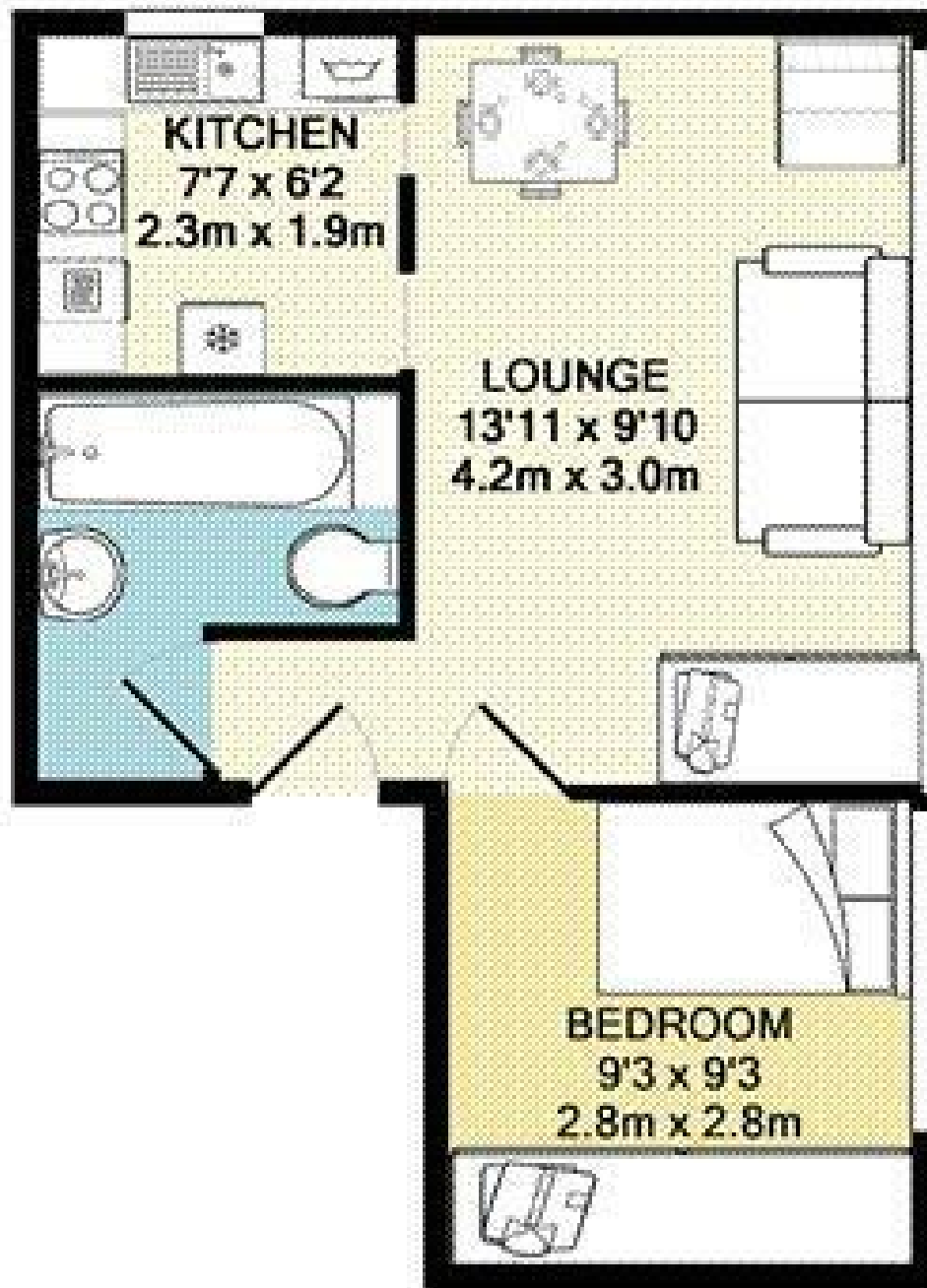

PH8

**TOTAL APPROX. FLOOR AREA 336 SQ. FT. (31.2 SQ.M.)**

Whilst every attempt has been made to ensure the accuracy of the floor plan contained here, measurements of doors, windows, rooms and any other items are approximate and no responsibility is taken for any error, omission, or mis-statement. This plan is for illustrative purposes only and should be used as such by any prospective purchaser. The services, systems and appliances shown have not been tested and no guarantee as to their operability or efficiency can be given.

Made with Metropix ©2012

**MAIDA VALE**

75 Castellain Road  
Maida Vale

London W9 1EU

T 020 7266 5000

F 020 7266 1119

E w9@comptonreeback.co.uk

Est. 1995

Registered Name: Compton Reeback Limited Registration Number: 6880098  
Registered Office: 75 Castellain Road, Maida Vale, London W9 1EU

Directors: Brian Compton & Julian Reeback

**IMPORTANT NOTICE:** All of the information is intended only as a guide to a prospective purchaser and not constitute part of an offer or contract. Any measurements or distances referred to herein are approximate only. Any information contained herein (whether in the text, plans or photographs) is given in good faith but should not be relied upon as being a statement or representation of fact. Should you proceed with the purchase of the property, your solicitor must verify these details. We have not carried out a detailed survey nor tested the services, appliances and specific fittings. In accordance with current legislation we would advise you that the measurements on these particulars are imperial. The formula for conversion to metric is as follows: 1' (one foot) = 30.48cm (centimeters), 1m (one meter) = 3.29'(feet)

[comptonreeback.co.uk](http://comptonreeback.co.uk)