



## Southwold Mansions, Widley Road W9

**£583,000**

A bright and spacious two double bedroom apartment situated on the raised ground floor of this period Mansions block which has recently undergone a major external refurbishment programme. The apartment benefits from a west facing reception room with high ceilings, bathroom with shower and access to well kept communal gardens.

Southwold Mansions is ideally located in a quiet turning road just off Elgin Avenue being close to numerous shopping and transport amenities including Maida Vale and Warwick Avenue Underground Station ( Bakerloo Line ) and the open spaces of Paddington Recreation Ground. Unexpired Lease 81 years, current service charge £3000 Per Annum plus a sinking fund contribution. Council tax band D. Sole Agent.



# Southwold Mansions, Widley Road W9

## Reception

13'8" x 13'5" (4.17 x 4.09)



## Kitchen

10'9" x 10'7" (3.28 x 3.23)



## Bedroom 1

13'10" x 13'8" (4.22 x 4.17)



## Exterior



## Bedroom 2

10'9" x 5'7" (3.28 x 1.70)



## Communal garden



[www.comptonreeback.co.uk](http://www.comptonreeback.co.uk)

# Southwold Mansions, Widley Road W9

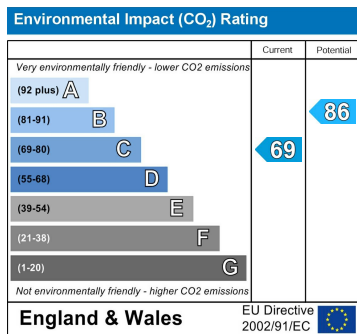
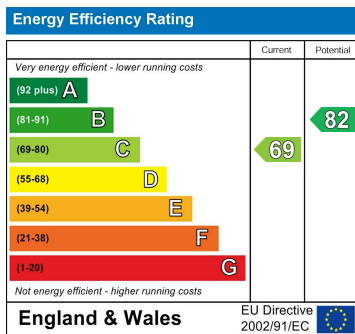



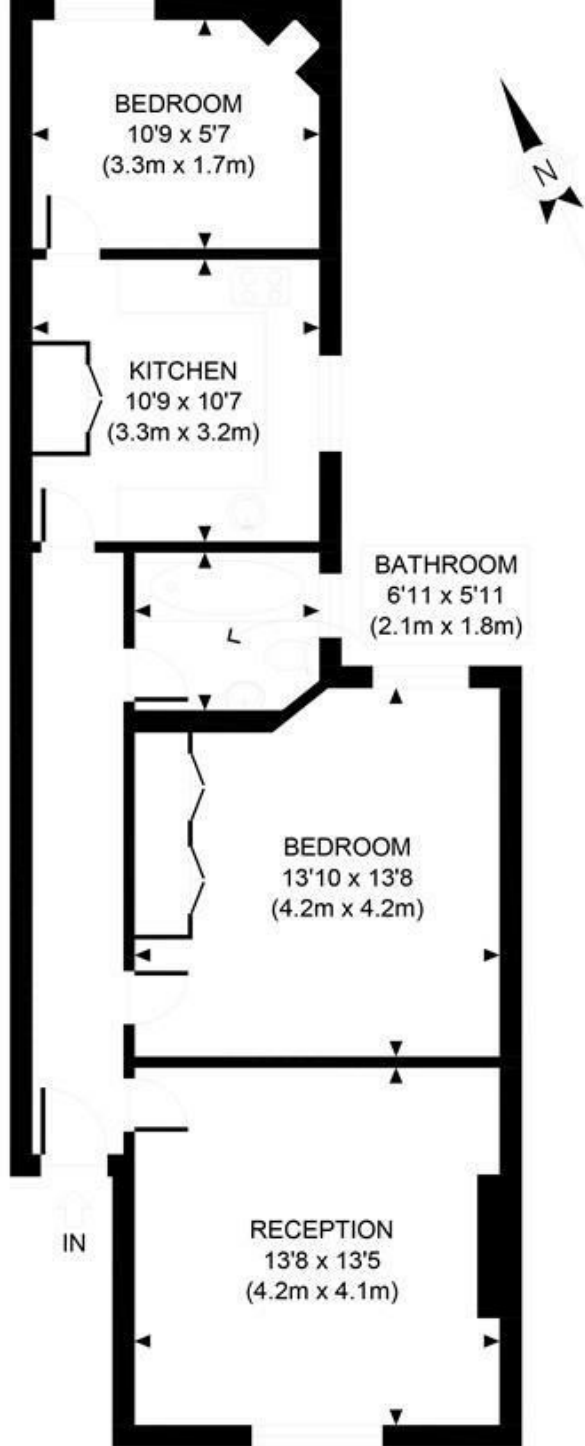

RAISED GROUND FLOOR  
GROSS INTERNAL  
FLOOR AREA 715 SQ FT

APPROX. GROSS INTERNAL FLOOR AREA 715 SQ FT / 66 SQM

Ref: Copyright **photoplan**

**Disclaimer:** Floor plan measurements are approximate and are for illustrative purposes only. While we do not doubt the floor plan accuracy and completeness, you or your advisors should conduct a careful, independent investigation of the property in respect of monetary valuation

**MAIDA VALE**

75 Castellain Road  
Maida Vale

London W9 1EU

T 020 7266 5000

F 020 7266 1119

E w9@comptonreeback.co.uk

Est. 1995

Registered Name: Compton Reeback Limited Registration Number: 6880098  
Registered Office: 75 Castellain Road, Maida Vale, London W9 1EU

Directors: Brian Compton & Julian Reeback

**IMPORTANT NOTICE:** All of the information is intended only as a guide to a prospective purchaser and not constitute part of an offer or contract. Any measurements or distances referred to herein are approximate only. Any information contained herein (whether in the text, plans or photographs) is given in good faith but should not be relied upon as being a statement or representation of fact. Should you proceed with the purchase of the property, your solicitor must verify these details. We have not carried out a detailed survey nor tested the services, appliances and specific fittings. In accordance with current legislation we would advise you that the measurements on these particulars are imperial. The formula for conversion to metric is as follows: 1' (one foot) = 30.48cm (centimeters), 1m (one meter) = 3.29'(feet)

[comptonreeback.co.uk](http://comptonreeback.co.uk)