



MINFORD GARDENS W14





• 3 DOUBLE BEDROOM UPPER MAISONETTE • RECEPTION ROOM • SEPARATE EAT-IN KITCHEN • FAMILY BATHROOM & SHOWER ROOM • WELL LOCATED FOR TRANSPORT LINKS • CLOSE TO WESTFIELD LONDON • FURNISHED • AVAILABLE 29TH JUNE • COUNCIL TAX BAND E

UNDER OFFER

A spacious 3 bedroom upper maisonette with reception and separate eat-in kitchen. There are three double bedrooms, shower room and a family bathroom. Ideally located for Central line at Shepherds Bush and Westfield shopping centre. Furnished. Available 29th June. Council Tax band E.

Minford Gardens, W14
Approximate Gross Internal Area 87 sq m / 936 sq ft

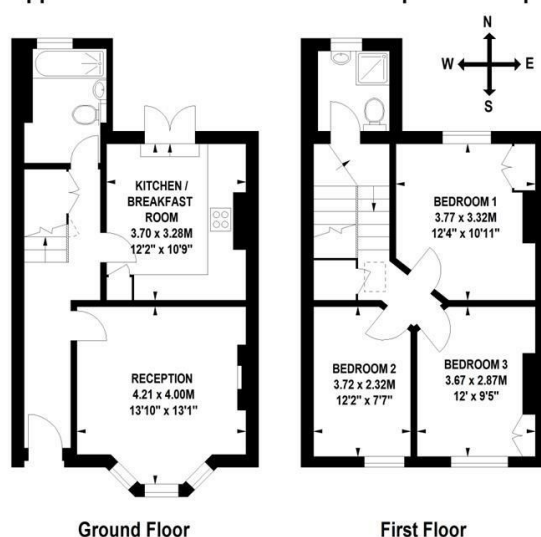

Floor Plan produced for Finlay Brewer by Mays Floorplans © . Tel 020 3397 4594
 Illustration for identification purposes only, not to scale
 All measurements are maximum, and include wardrobes and window bays where applicable
 This Floorplan has been prepared in accordance with the current edition of the RICS code of measuring practice.

138 Shepherds Bush Road, London, W6 7PB
Tel: 020 7371 4071 lettings@finlaybrewer.co.uk