



## BATOUM GARDENS W6





- 4 BEDROOMS • WOOD FLOORING • OPEN PLAN RECEPTION • FITTED KITCHEN • SHOWER ROOM AND ENSUITE BATHROOM • QUIET LOCATION, CLOSE TO SHOPS • CLOSE TO TRANSPORT • UNFURNISHED • AVAILABLE 16TH AUGUST • THE PROPERTY IS NOT SUITABLE FOR SHARERS OR STUDENTS

Fantastic, recently refurbished 4 bedroom maisonette, with wood flooring throughout, bright, open plan reception, fitted kitchen, shower room and en-suite bathroom. Located in a quiet residential street, close to the shops and amenities on Shepherds Bush Road and a short walk to the transport links at Hammersmith and Shepherds Bush. Due to licensing this property is not suitable for sharers. Available unfurnished on the 16th August.

**Batoum Gardens, W6**  
**Approximate Gross Internal Area 112 sq m / 1905 sq ft**  
**Including Eaves Storage of 9 sq m / 97 sq ft**

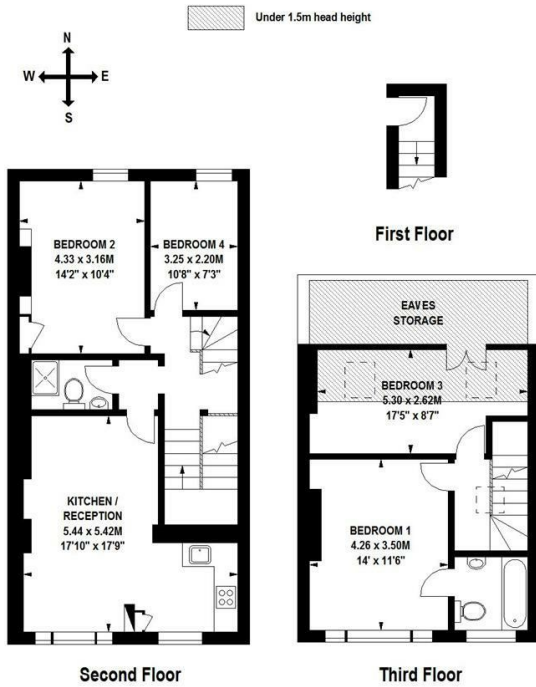

Floor Plan produced for Finlay Brewer by Mays Floorplans ©. Tel 020 3397 4594  
 Illustration for identification purposes only, not to scale  
 All measurements are maximum, and include wardrobes and window bays where applicable  
 This Floorplan has been prepared in accordance with the current edition of the RICS code of measuring practice.

138 Shepherds Bush Road, London, W6 7PB  
 Tel: 020 7371 4071 [lettings@finlaybrewer.co.uk](mailto:lettings@finlaybrewer.co.uk)