



ASKEW ROAD W12





- STUDIO APARTMENT • SPACIOUS LIVING AREA • FITTED KITCHEN • SHOWER ROOM • CLOSE TO SHOPS • SHORT WALK TO TUBE • UNFURNISHED • AVAILABLE 26TH JUNE

Excellent studio apartment with spacious living area, fitted kitchen and shower room. Located close to the shops and amenities on Askew Road, and a short walk from Ravenscourt Park and Stamford Brook. Available 26th June, unfurnished. *Kindly note, there is no washing machine in the property, there is a laundrette on Askew Road*.



ASKEW ROAD, W12

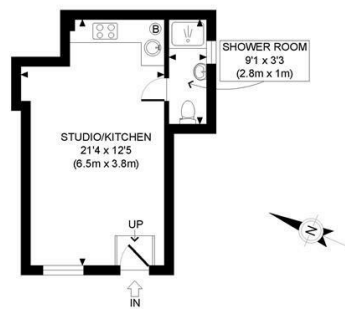

GROUND FLOOR
GROSS INTERNAL
FLOOR AREA 269 SQ FT

APPROX. GROSS INTERNAL FLOOR AREA: 269 SQ FT/ 25 SQM

PROPERTY PHOTO PLANS.co.uk
ONE STOP SHOP FOR PROPERTIES MARKETING

Whilst every attempt has been made to ensure the accuracy of the floor plan contained here, measurements of the doors, windows, rooms and any other items are approximate and no responsibility is taken for any errors, omissions, or miss-statement. This plan is for illustrative purposes only and should be used as such by any prospective client. The services, systems and appliances shown have not been tested and no guarantee as to the operability or efficiency can be given.

138 Shepherds Bush Road, London, W6 7PB
Tel: 020 7371 4071 lettings@finlaybrewer.co.uk