



Plot of land near Penglogue , Whitland, SA34 0LP

Offers Over £80,000

0.123 acre level plot of land, enjoying a fabulous countryside aspect

Former ruins of a cottage evident

Excellent roadside access

Considerable potential available

Within easy driving distance of town facilities

Situation

Enjoying a delightful rural location boasting a far reaching countryside aspect, yet very conveniently set within some three miles or so of the small market town of Whitland which lies just off the A40 within the heart of the West Carmarthenshire Countryside. The town of Whitland has the benefit of a good range of local services and facilities that cater for everyday requirements. Carmarthen town is the principle administrative centre for the county and provides a wide array of commercial, educational and recreational facilities and lies some 15 miles distant from the plot of land.

Directions

From the direction of Narberth, proceed along the A40, bypassing the town of Whitland and when you approach the roundabout at the top of the town (Roadhouse Restaurant) take the first exit signposted Llanboidy. Continue on this road for some 2 miles and the entrance to the plot of land will be seen on the right hand side as denoted by our 'for sale' board. If you have reached the farm entrance of Penglogue on the right hand side, you have gone too far. Please see attached plan.

Description

A plot of land that extends to some 0.123 acres or thereabouts benefitting from excellent roadside access and identified as field number 2207 on the attached plan. A level plot of land which also includes a ruin of a former cottage.

The sale of this plot of land, offers an excellent opportunity to acquire a nicely positioned plot in a convenient location which has the benefit of an outstanding countryside aspect which needs to be seen to be fully appreciated and the remains of a ruin which we understand to be that of a cottage.

Services

None are connected to the plot of land.

Tenure: Freehold with vacant possession upon completion.

Local Authority: Carmarthenshire County Council

General Remarks

An excellent opportunity to purchase a plot of land with the ruins of a former cottage evident. Please note that the plot of land is not being sold as a building plot and there is no planning permission associated with the land for residential use.

Land Plan
Plan for identification purposes only and not to scale

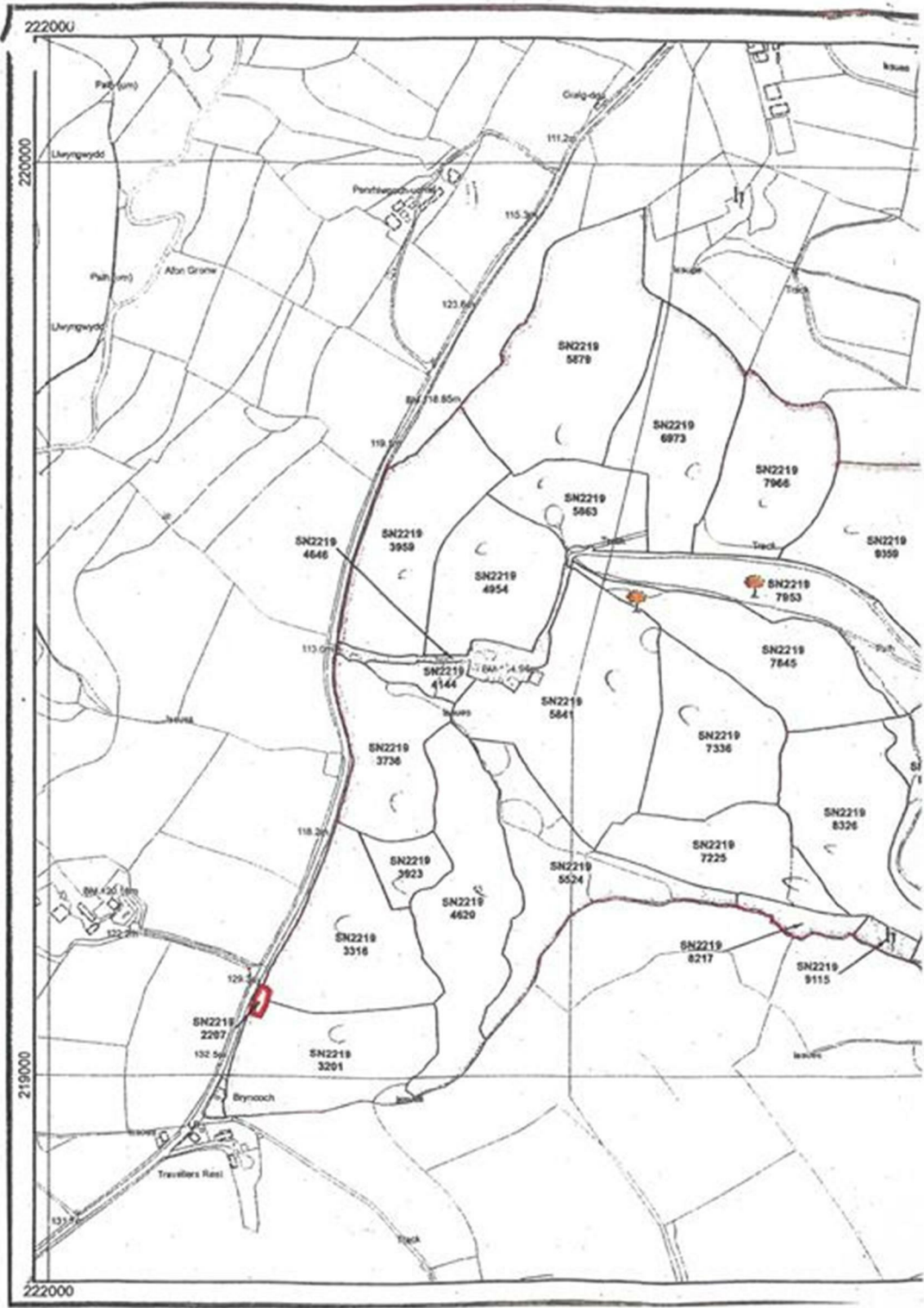

These particulars, whilst believed to be accurate are set out as a general outline only for guidance and do not constitute any part of an offer or contract. Intending purchasers should not rely on them as statements of representation of fact, but must satisfy themselves by inspection or otherwise as to their accuracy. No person in this firms employment has the authority to make or give any representation or warranty in respect of the property.

5 High Street, Cardigan,
Ceredigion, SA43 1HJ
T: 01239 612 343
E: cardigan@jjmorris.com

21 West Street, Fishguard
Pembrokeshire, SA65 9AL
T: 01348 873 836
E: fishguard@jjmorris.com

4 Picton Place, Haverfordwest
Pembrokeshire, SA61 2LX
T: 01437 760 440
E: haverfordwest@jjmorris.com

Hill House, Narberth,
Pembrokeshire, SA67 7AR
T: 01834 860 260
E: narberth@jjmorris.com