



14 Normandy Way, Chepstow

£425,000 Freehold

New built in oven/microwave. • En-suite in master. • Large grass area to the side of property. • Wardrobes in master to come with property • Driveway, room for 2 cars • Modern kitchen • Utility room • Spacious living room, with sunlight in the morning and double doors that lead to the garden. • Electric fire place fitted in the front room, with glow effect.

Bluestone

Scan to book a
viewing



Ground Floor
100.3 sq.m. (1080 sq.ft.) approx.

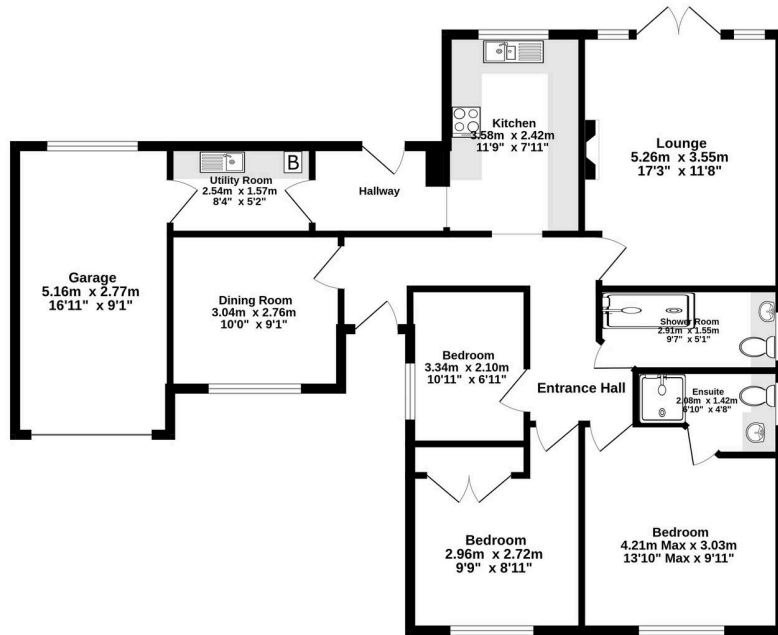

TOTAL FLOOR AREA: 100.3 sq.m. (1080 sq.ft.) approx.
Whilst every attempt has been made to ensure the accuracy of the floorplan, constant errors, measurements of doors, windows, rooms and any other items are approximate and no responsibility is taken for any error, omission or misstatement. This plan is for illustrative purposes only and should be used as such by any prospective purchaser. The services, systems and appliances shown have not been tested and no guarantee as to their operability or efficiency can be given.
 Made with Metreplex ©2025



You can include any text here. The text can be modified upon generating your brochure.