



Thurloe Square, South Kensington SW7

ASHDOWN MARKS  
PROPERTY CONSULTANTS



## Thurloe Square South Kensington SW7

An impressive freehold period house (4,975 sq.ft / 462 sq.m) on the west side of this desirable garden square on the Knightsbridge/ South Kensington border.

The house provides bright and spacious well arranged accommodation presented in excellent order having been recently refurbished to a high standard to include a passenger lift and air conditioning.

**Freehold   Guide Price: £13,000,000**











- Recently Refurbished
- Impressive Entrance Hall
- Drawing Room
- Dining Room
- Kitchen/Breakfast Room
- Family Room
- Conservatory
- West Facing Terraces
- 5/6 Bedrooms
- 5 Bathrooms (4 En Suite)
- Utility Room
- Air Conditioning
- Passenger Lift
- Access to Thurloe Square
- Council Tax: Band H
- EPC: Rating D

**Freehold**

**Guide Price £13,000,000**

# Thurloe Square, SW7

Approximate Gross Internal Area

462.20 sq m / 4975 sq ft

Vault

3.59 sq m / 39 sq ft

## Total Areas Shown On Plan

465.79 sq m / 5014 sq ft

( Including restricted height  
under 1.5m )

( CH = Ceiling Heights )

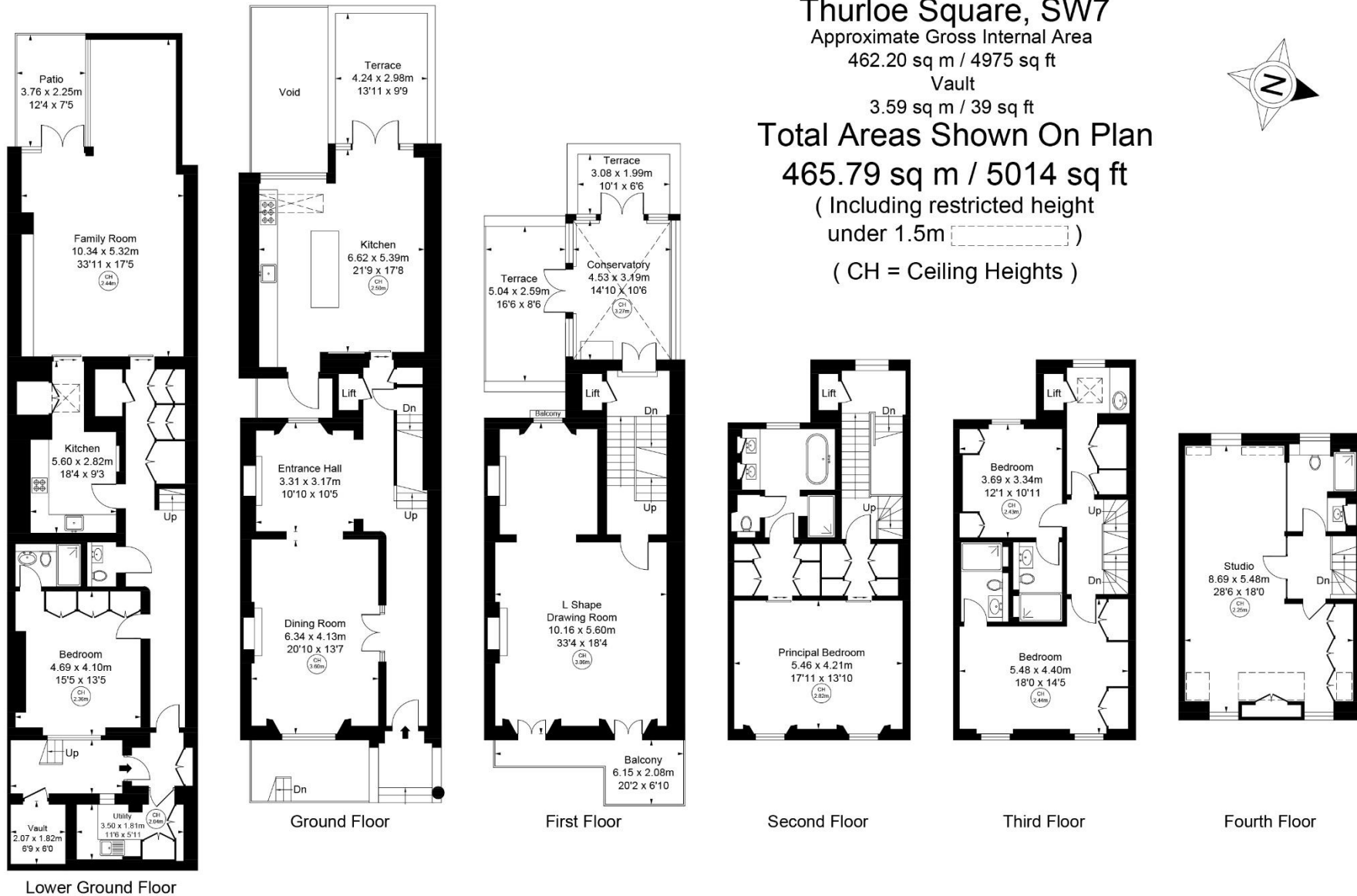

This plan is not to scale. It is for guidance and not for valuation purposes.

All measurements and areas are approximate only, and have been prepared in accordance with the current edition of the RICS Code of Measuring Practice.

Important notice: Ashdown Marks, their clients and any joint agents give notice that: 1: They are not authorised to make or give any representations or warranties in relation to the property either here or elsewhere, either on their own behalf or on behalf of their client or otherwise. They assume no responsibility for any statement that may be made in these particulars. These particulars do not form part of any offer or contract and must not be relied upon as statements or representations of fact. 2: Any areas, measurements or distances are approximate. The text, photographs and plans are for guidance only and are not necessarily comprehensive. It should not be assumed that the property has all necessary planning, building regulation or other consents and Ashdown Marks have not tested any services, equipment or facilities.

9 Milner Street

London, SW3 2QB

Tel: +44 (0)20 7589 3353

[www.ashdownmarks.co.uk](http://www.ashdownmarks.co.uk)

**ASHDOWN MARKS**  
PROPERTY CONSULTANTS