



Hollings Grove, Solihull

Guide Price £250,000





PROPERTY OVERVIEW

Situated on the popular Hillfield Estate, an ideal opportunity to purchase this one bedroom End Town House which would be ideal for a first time purchaser. This property is offered to the market with NO UPWARD CHAIN and is within easy walking distance of Widney Manor Railway Station and Bannatynes Gymnasium. The accommodation briefly comprises of: enclosed porch, living room, kitchen, bathroom, mezzanine bedroom, conservatory, East facing garden and garage.





PROPERTY LOCATION

Solihull offers an excellent range of amenities which includes the renowned Touchwood Shopping Centre, Tudor Grange Swimming Pool/Leisure Centre, Park and Athletics track. There is schooling to suit all age groups including Public and Private schools for both boys and girls, plus a range of services including commuter train services from Solihull Station to Birmingham (8 miles) and London Marylebone. In addition, the National Exhibition Centre, Birmingham International Airport and Railway Station are all within an approximate 10/15 minutes drive and the M42 provides fast links to the M1, M5, M6 and M40 motorways.

Council Tax band: B

Tenure: Freehold



- One Bedroom End Town House
- Quiet Cud-De-Sac Location
- Ideal For A First Time Purchaser
- Living Room
- Kitchen
- East Facing Garden
- Mezzanine Bedroom



ENCLOSED PORCH

LIVING ROOM

14' 2" x 11' 7" (4.32m x 3.53m)

KITCHEN

9' 10" x 7' 11" (3.00m x 2.41m)

BEDROOM

14' 2" x 9' 9" (4.32m x 2.96m)

BATHROOM

6' 5" x 5' 10" (1.96m x 1.78m)

CONSERVATORY

13' 5" x 7' 5" (4.08m x 2.27m)

OUTSIDE THE PROPERTY

SINGLE GARAGE

This is in a nearby block

EAST FACING REAR GARDEN

ITEMS INCLUDED IN THE SALE

Integrated oven, integrated hob, fridge, freezer, washing machine, all carpets, all curtains, fitted wardrobes in bedroom and garden shed.

ADDITIONAL INFORMATION

Services: main gas, electricity and mains sewers.

MONEY LAUNDERING REGULATIONS

Prior to a sale being agreed, prospective purchasers will be required to produce identification documents. Your co-operation with this, in order to comply with Money Laundering regulations, will be appreciated and assist with the smooth progression of the sale.





GROUND FLOOR

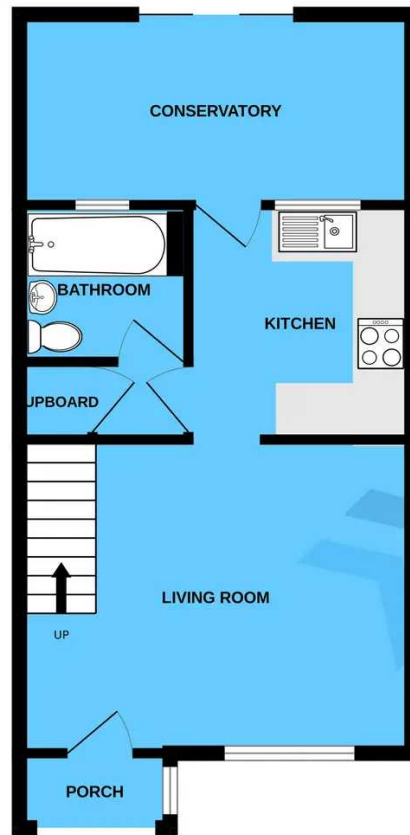

1ST FLOOR



Whilst every attempt has been made to ensure the accuracy of the floorplan contained here, measurements of doors, windows, rooms and any other items are approximate and no responsibility is taken for any error, omission or mis-statement. This plan is for illustrative purposes only and should be used as such by any prospective purchaser. The services, systems and appliances shown have not been tested and no guarantee as to their operability or efficiency can be given.
Made with Metropix 62023

Xact Homes

6 The Square, Solihull - B91 3RB

0121 712 6222 • solihull@xacthomes.co.uk • www.xacthomes.co.uk

xact
SALES & LETTINGS

