



WHERE STANDARDS MATTER

Spencer Munson
41 High Road
South Woodford E18 2QP

Tel: 020 8989 3331

swoodford@spencermunson.co.uk
Website: spencermunson.co.uk



The Grove, Stratford, E15

*ONE BEDROOM FLAT IN THE HEART OF STRATFORD** ** SECURE ENTRANCE ** ** GAS C/H** **
TOP FLOOR FLAT ** ** NO PARKING** ** CLOSE TO WESTFIELD SHOPPING CENTER ** ** FITTED
KITCHEN ** **AVAILABLE 3RD SEPTEMBER ON A MINIMUM 12 MONTHS TENANCY ** **EPC
RATING: D. COUNCIL TAX BAND B

Rent: £1,350 - Monthly



The Grove, Stratford, E15

Bedroom

2.95m (9'8) x 4.21m (13'10)



Reception 1

5.53m (18'2) x 3.87m (12'8)



Bathroom

1.53m (5'0) x 1.78m (5'10)



Kitchen

2.49m (8'2) x 2.52m (8'3)

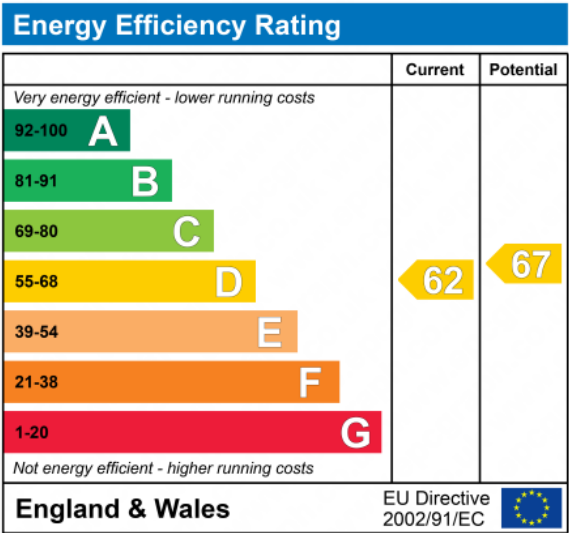

SPENCER MUNSON are delighted to be offering this fantastic One bedroom apartment above a shop in the heart of Stratford E15. The property benefits from a spacious lounge, fully fitted kitchen, double bedroom, fitted bathroom, secure entrance. Located a stone's throw from Stratford Central & Jubilee line, DLR and Mainline station, 24hr Bus, Westfield Shopping Mall, Bars and Restaurants & other amenities. The property will be available 3rd September 2025 Call SPENCER MUNSON today to arrange your viewing. EPC rating: D. Council Tax B

The Grove, Stratford, E15

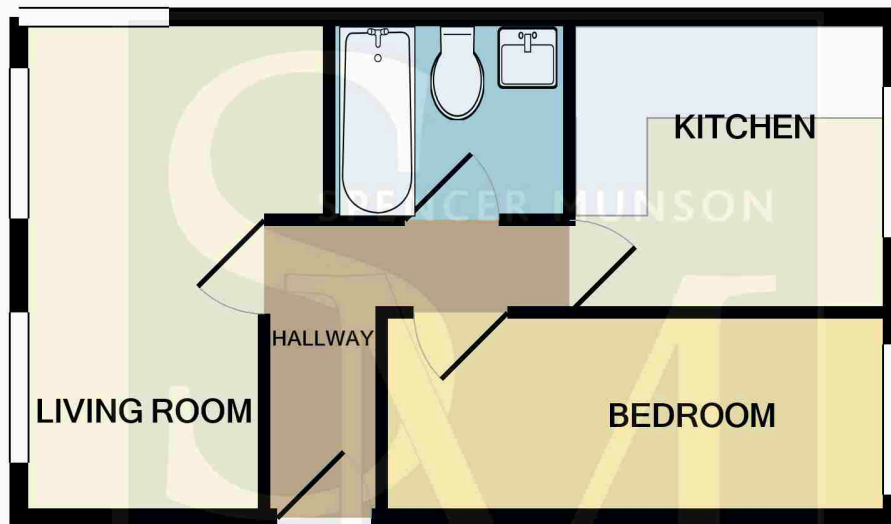

Whilst every attempt has been made to ensure the accuracy of the floor plan contained here, measurements of doors, windows, rooms and any other items are approximate and no responsibility is taken for any error, omission, or mis-statement. This plan is for illustrative purposes only and should be used as such by any prospective purchaser. The services, systems and appliances shown have not been tested and no guarantee as to their operability or efficiency can be given

Made with Metropix ©2021

Disclaimer

These particulars are intended to give a fair and substantially correct overall description for the guidance of intending tenants/purchasers and do not constitute an offer or part of a contract. Prospective tenants/purchasers and/or lessees should seek their own professional advice. All descriptions, dimensions, reference to condition, fixtures, fittings and necessary permissions for use and occupation and other details are given in good faith and are believed to be correct. However, intending tenants/purchasers should not rely on them as statements or representations of fact, but must satisfy themselves by inspection or otherwise as to the correctness of each of them. Fixtures and fittings shown in pictures and on viewings may well not be included in any tenancy/sale and any prospective tenant/purchaser must clarify this for themselves. All measurements and floorplans are approximate and produced as a guide in good faith. Please note that some of the furniture and decor items shown in these images have been digitally added using AI technology for illustrative purposes. The actual property may differ in appearance. Prospective buyers or renters are encouraged to visit the property in person to get an accurate representation.