



WHERE STANDARDS MATTER

Spencer Munson
128 High Road
Loughton IG10 4BE

Tel: 020 8502 2222

loughton@spencermunson.co.uk

Website: spencermunson.co.uk



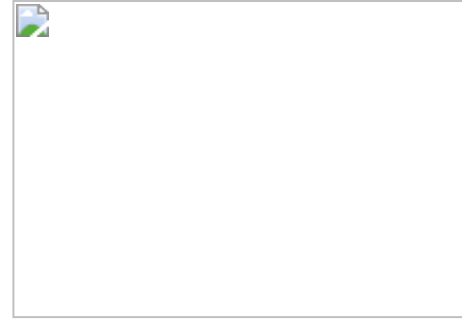
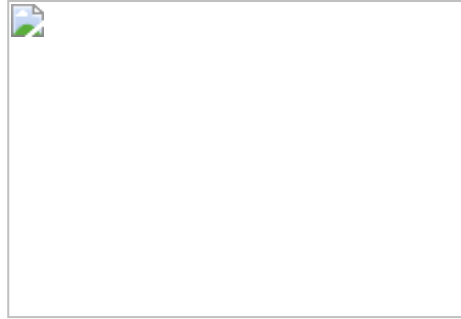
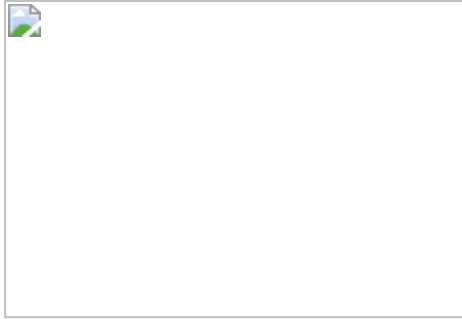

Cassis Court, Loughton, IG10

**** 2 BEDROOM APARTMENT**** **Close to Debden station ** ** Easy walk to Sainsburys and The Broadway shops ** ** First Floor ** ** Modern Kitchen & Bathroom ** ** Parking Behind Electric Gates ** ** Convenient for M11 ** ** Well presented ** ** NO ONWARD CHAIN ** ** ** EPC Rating E** ** Council



rents in excess of £25,000

Cassis Court, Loughton IG10

Exterior



Reception 1

6m (19'8) x 2.97m (9'9)



Kitchen



Bedroom 1

3.9m (12'10) x 2.93m (9'7)



Bedroom 2

3.2m (10'6) x 2.15m (7'1)



Bathroom

2.14m (7'0) x 1.84m (6'0)



Cassis Court, Loughton IG10

Hallway

Parking



The property was newly refurbished approx 2 years ago. The property has a good size lounge, modern fitted kitchen, two bedrooms and a family shower room with NO ONWARD CHAIN. The property is situated in this popular block close to Debden Central Line station, Sainburys supermarket and the The Broadway with its shops and cafés as well as having good access to the M11 and the Langston Road with its new Shopping Centre alongside established shops, car dealerships and offices; Spencer Munson are delighted to offer this well presented first floor apartment which has communal gardens and parking behind electric gates. EPC rating E. Council Tax C

Cassis Court, Loughton IG10

GROUND FLOOR

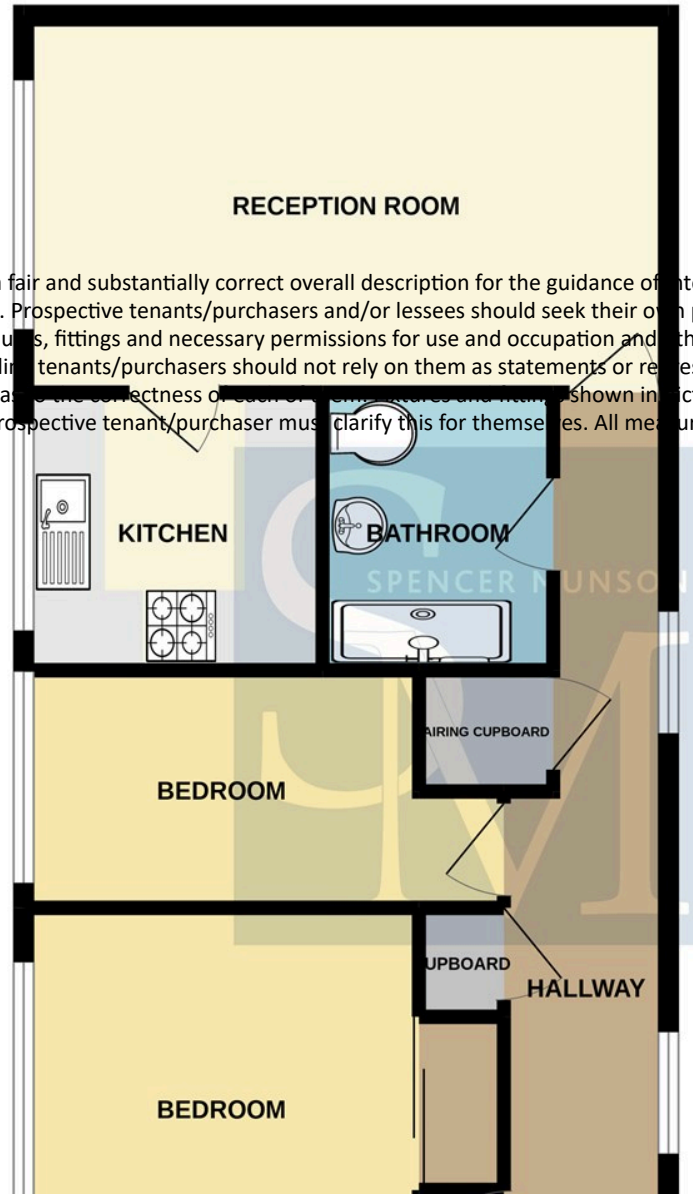

Disclaimer

These particulars are intended to give a fair and substantially correct overall description for the guidance of intending tenants/purchasers and do not constitute an offer or part of a contract. Prospective tenants/purchasers and/or lessees should seek their own professional advice. All descriptions, dimensions, reference to condition, fixtures, fittings and necessary permissions for use and occupation and other details are given in good faith and are believed to be correct. However, intending tenants/purchasers should not rely on them as statements or representations of fact, but must satisfy themselves by inspection or otherwise as to the correctness of them. Some items and fittings shown in pictures and on viewings may well not be included in any tenancy/sale and any prospective tenant/purchaser must clarify this for themselves. All measurements and floorplans are approximate and produced as a guide in good faith.



Whilst every attempt has been made to ensure the accuracy of the floorplan contained here, measurements of doors, windows, rooms and any other items are approximate and no responsibility is taken for any error, omission or mis-statement. This plan is for illustrative purposes only and should be used as such by any prospective purchaser. The services, systems and appliances shown have not been tested and no guarantee as to their operability or efficiency can be given.
Made with Metropix ©2022