



3 Clawson Close, Loughborough

£220,000 Freehold

Immaculately maintained, with neutral décor and desirable upgrades, this stellar home on Loughborough's peaceful Clawson Close is an ideal proposition for the savvy landlord, small family or first time buyer.

Immaculately maintained, with neutral décor and desirable upgrades, this stellar home on Loughborough's peaceful Clawson Close is an ideal proposition for the savvy landlord, small family or first time buyer.

The home consists of a fabulous entrance porch, illuminated by a full-height window, which opens up into a light-filled lounge, ideal for hosting visitors and relaxing. This space, along with the rest of the home, has been upgraded to include solid oak doors of superb quality, whilst the lounge has also been equipped with a series of very handy storage options. Onwards, the property benefits from a spacious kitchen, featuring an integrated oven with gas hob above, as well as a built-in dishwasher and stainless steel extractor hood.

The upper floor of the home is formed of two large bedrooms, almost exactly equal in size, as well as a fantastic bathroom featuring built-in shelving, as well as a fabulous on-trend walk-in shower.

Externally, the property is served by a large driveway to the side, as well as gardens to the front and the rear.

The property is well connected for public transport, being just a short distance away from the nearest bus stop. Families will be delighted by the proximity to Robert Bakewell primary school, with Charnwood College also readily accessible.

Council Tax band: B

Tenure: Freehold

EPC Energy Efficiency Rating: C

EPC Environmental Impact Rating: C

Loughborough is a lively town housing a wide range of shopping facilities, numerous cafes, and, a world-renowned university and schooling of all grades. Loughborough is well placed for commuters, with a well-serviced rail network, immediate access to the M1 providing fast access North and South, and the surrounding cities of Leicester, Derby and Nottingham are all within easy commuting distance.

To view this special property in person, please contact Clare, Katie, Dominique or Ryan at the Edwards office to arrange your viewing.

Any fixtures, fittings or appliances mentioned in these details have not been tested and can not be assumed to be in full efficient working order. It should not be assumed that items shown in our photographs are included in the sale of the property. Although we have taken every care to ensure the dimensions for the property are true, they should be treated as approximate and for general guidance only. Where an offer is accepted, the prospective purchaser will be required to confirm their identity to us by law. We will need to see a passport or driving license along with a recent utility bill to confirm residence. These details and floor plans, although believed to be accurate, are for guidance only and prospective purchasers should satisfy themselves by inspection or otherwise to their accuracy. No individual within this estate agency has the authority to make or give any warranty in respect to the property. We believe you may benefit from using the services of Simpson Jones, Taylor Rose Solicitors, Idyll Mortgages, Near and Far and Jex Surveyors, the Provider(s), who are conveyancers, mortgage adviser, removals and surveyor respectively. We recommend sellers and/or potential buyers use the services of the Provider(s). Should you decide to use the services of the Provider(s) you should know that we would expect to receive a referral fee of between £50 and £144 from them for recommending you to them. You are not under any obligation to use the services of any of the recommended providers, though should you accept our recommendation the provider is expected to pay us the corresponding Referral Fee.



Entrance Porch

4' 8" x 4' 8" (1.42m x 1.43m)

Lounge

17' 5" x 13' 0" (5.31m x 3.95m)

Kitchen/Dining Room

9' 1" x 13' 0" (2.76m x 3.95m)

Landing

Bedroom One

11' 10" x 13' 0" (3.60m x 3.95m)

Bedroom Two

9' 0" x 13' 0" (2.75m x 3.95m)

Bathroom

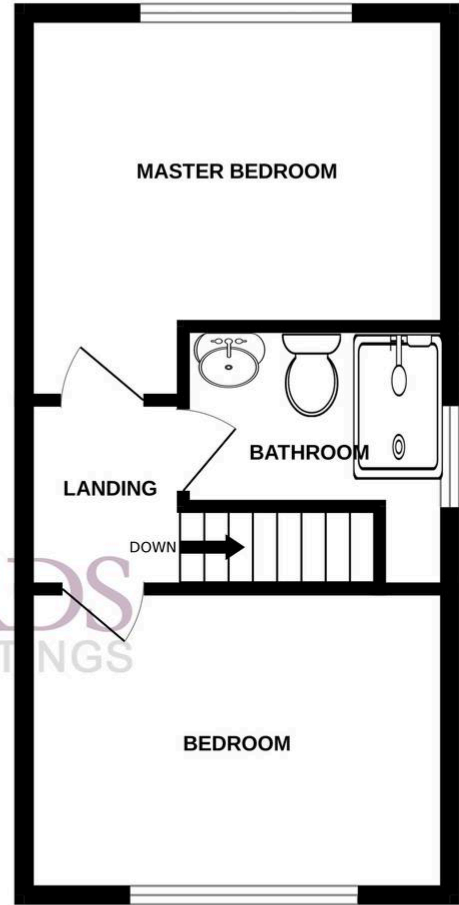
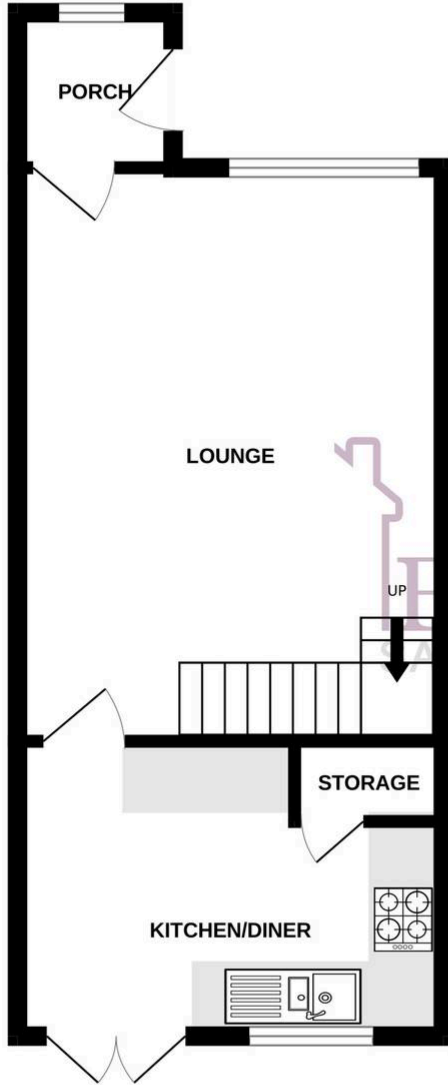

Whilst every attempt has been made to ensure the accuracy of the floorplan contained here, measurements of doors, windows, rooms and any other items are approximate and no responsibility is taken for any error, omission or mis-statement. This plan is for illustrative purposes only and should be used as such by any prospective purchaser. The services, systems and appliances shown have not been tested and no guarantee as to their operability or efficiency can be given.
Made with Metropix ©2024

You can include any text here. The text can be modified upon generating your brochure.