



SAXON SHORE
— ESTATE AGENTS —



Copperfield Bagshill Road, Faversham, ME13 0PB

£450,000

Introducing this three bedroom, detached house in Leaveland, near Faversham. Situated on large plot in a rural location with picturesque views of fields to front and rear. Offered for sale with no onward chain, in need of modernisation throughout, this property has great potential to be a stunning family home.

Accommodation spans across two floors and comprises of an entrance hall that has a door opening onto the back garden, a spacious lounge with an archway onto a dining room, a kitchen, utility room and W/C to the ground floor. There is a further internal room that could be used in a variety of ways.

Upstairs are three good sized bedrooms and a full bathroom.

Outside to the front is a garden, driveway and freestanding garage for ample parking. To the rear is a generous, well established garden, mainly laid to lawn.

Don't miss your opportunity to snap up this fantastic renovation project, contact us today to arrange a viewing!

Porch

Entrance Hall



Lounge
14'5" (4.395)



Dining Room
11'10" x 10'1" (3.63 x 3.09)



Kitchen
13'1" x 8'7" (4.01 x 2.63)



WC
6'0" x 2'7" (1.84 x 0.8)

Utility Room
6'0" x 11'11" (1.84 x 3.65)



Other Internal Room
11'11" x 15'10" (3.64 x 4.84)



Landing



Bedroom 1
11'10" x 12'4" (3.63 x 3.77)



Bedroom 2
13'1" x 12'4" (4 x 3.77)



Bedroom 3
9'10" x 8'7" (3 x 2.63)



Bathroom

6'8" x 6'4" (2.05 x 1.95)



Garden



GROUND FLOOR
75.6 sq.m. (813 sq.ft.) approx.

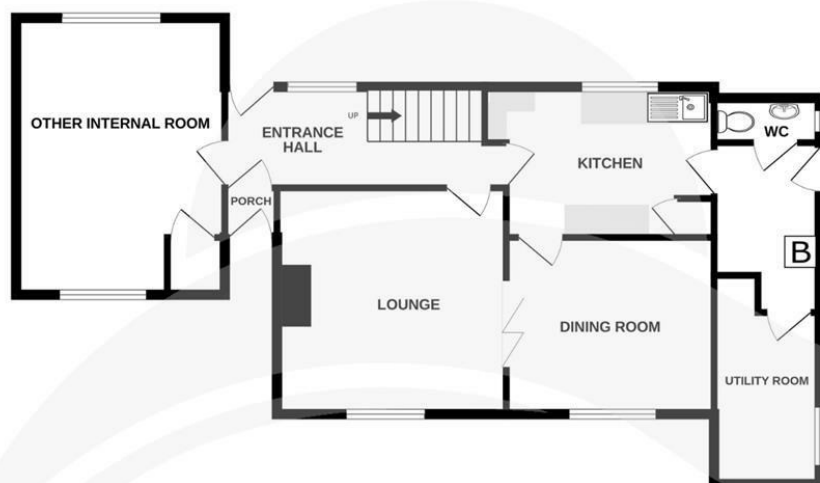

1ST FLOOR
43.6 sq.m. (470 sq.ft.) approx.



TOTAL FLOOR AREA : 119.2 sq.m. (1283 sq.ft.) approx.

Whilst every attempt has been made to ensure the accuracy of the floorplan contained here, measurements of doors, windows, rooms and any other items are approximate and no responsibility is taken for any error, omission or mis-statement. This plan is for illustrative purposes only and should be used as such by any prospective purchaser. The services, systems and appliances shown have not been tested and no guarantee as to their operability or efficiency can be given.
Made with Metropix ©2025

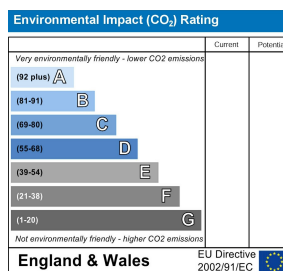
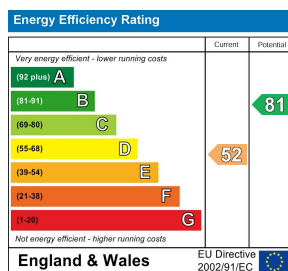

The Alexander Centre 15 - 17 Preston Street, Faversham, ME13 8NZ

Tel: 01795 533577

info@saxonshore.co.uk

www.saxonshore.uk



SAXON SHORE
- ESTATE AGENTS -